

# State Well Report

## Part 1 - Driller's Log

Mississippi Department of Environmental Quality  
Office of Land and Water Resources  
P.O. Box 2309  
Jackson, MS 39225  
(601)961-5210  
(601)961-5228 (fax)

County: Covington  
Permit #: 0-586  
Driller: JAMES WELLS  
Date drilling completed: 5-13-10

For Office Use Only:  
Aquifer: K 71  
Well #: \_\_\_\_\_  
L. S. Elevation: \_\_\_\_\_  
E-log #: \_\_\_\_\_

State Law requires that this report be prepared by the license holder responsible for the work and filed with the Department at the above address within 30 days of completion of drilling of the well or borehole.

Information on Well Owner (Landowner if borehole is not for a water well)	Well or Borehole Location
Owner Name: <u>Christopher Sanford</u>	Latitude: <u>31.32.41</u> , Longitude: <u>89.31.50</u>
Mailing Address: <u>218 Tower Rd</u>	Method of Lat/Long (circle one): Conventional Survey, USGS quad, Hand-held GPS, Survey-grade GPS
<u>Seminary MS 39479</u> City State Zip Code	<u>SE 1/4 NW 1/4 Sec 29 Twn 7N Rng 15W</u>
Telephone No. <u>(601) 641-1100</u>	Distance <u>5</u> Miles <u>SW</u> Direction of <u>Seminary</u> Nearest Town

**Well / Borehole Data**

Date drilling started: 5-13-10 Date drilling completed: 5-13-10 Hole depth: 100' Hole diameter: 7 1/2"

Location of the source of any surface water used for drilling: water well

Method of dosing and volume of Chlorine used in drilling and development: shock

Logs run (circle all applicable): No log run Electric Gamma Ray Density Sonic Neutron Other: \_\_\_\_\_

Name of organization running log(s): \_\_\_\_\_

Purpose of borehole (check one): Water Well  Geotechnical/Geological Investigation \_\_\_\_\_ Ground Source Heat Pump \_\_\_\_\_

Seismic Survey \_\_\_\_\_ Other (describe) \_\_\_\_\_

*If drilling is not related to water well construction, skip the remainder of this block*

Purpose of Well (check one): Home  Industrial \_\_\_\_\_ Public Supply \_\_\_\_\_ Irrigation \_\_\_\_\_ Fish Culture \_\_\_\_\_ Other: \_\_\_\_\_

If a flowing well, method of flow regulation: Valve \_\_\_\_\_ Other (describe) \_\_\_\_\_

Static Water Level: 65 feet above or below (circle one) land surface Date measured: 5-13-10

Method of Measurement (circle one) steel tape electric tape air line other: \_\_\_\_\_

Well depth: 100 Well grouted to a depth of 10 feet Type of grout (circle one): Neat Cement Bentonite Mix

Casing length: 80 feet Casing diameter: 4 inches Type of casing: PVC

Screen length: 20 feet Screen diameter: 4 inches Type of screen: PVC

Screen slot size: .008 inches Setting depth: From 80 feet to 100 feet

Type of completion (circle all applicable): Gravel packed Underreamed Telescoped Open hole Natural Development

Other (describe): \_\_\_\_\_

Top of lap pipe or reduction in casing: \_\_\_\_\_ feet. *If telescoped or more than one screen, describe on next page*

Form: OLWR-SWR-1A (04/08)

**RECEIVED**  
JUN 04 2010  
BY: OLWR

If well telescopes please sketch below and show depths.

K71

Ground Level

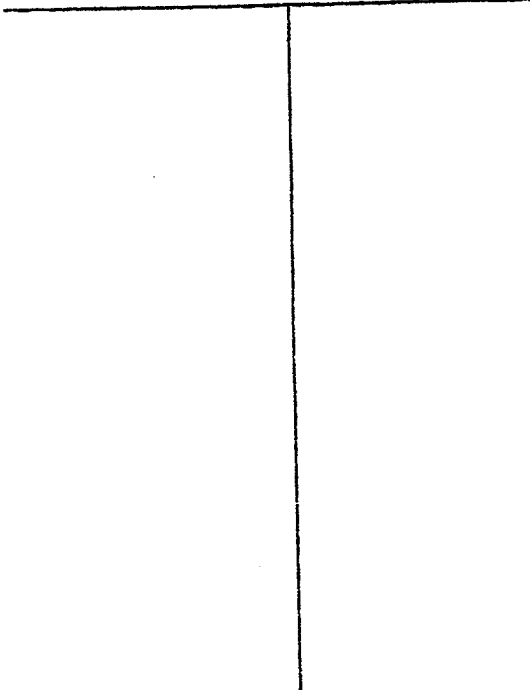

Description of Formations Encountered

Description of Formations Encountered	From	To
topsoil	0	1
clay	1	60
sand	60	160

If more than one screen, show location of each on sketch

Sketch the property layout and include the following: 1) the well location; 2) any permanent structures on the property that may aid in locating the well; 3) any roads, power lines, or other items that may aid in locating the property and the well; 4) indicate direction.

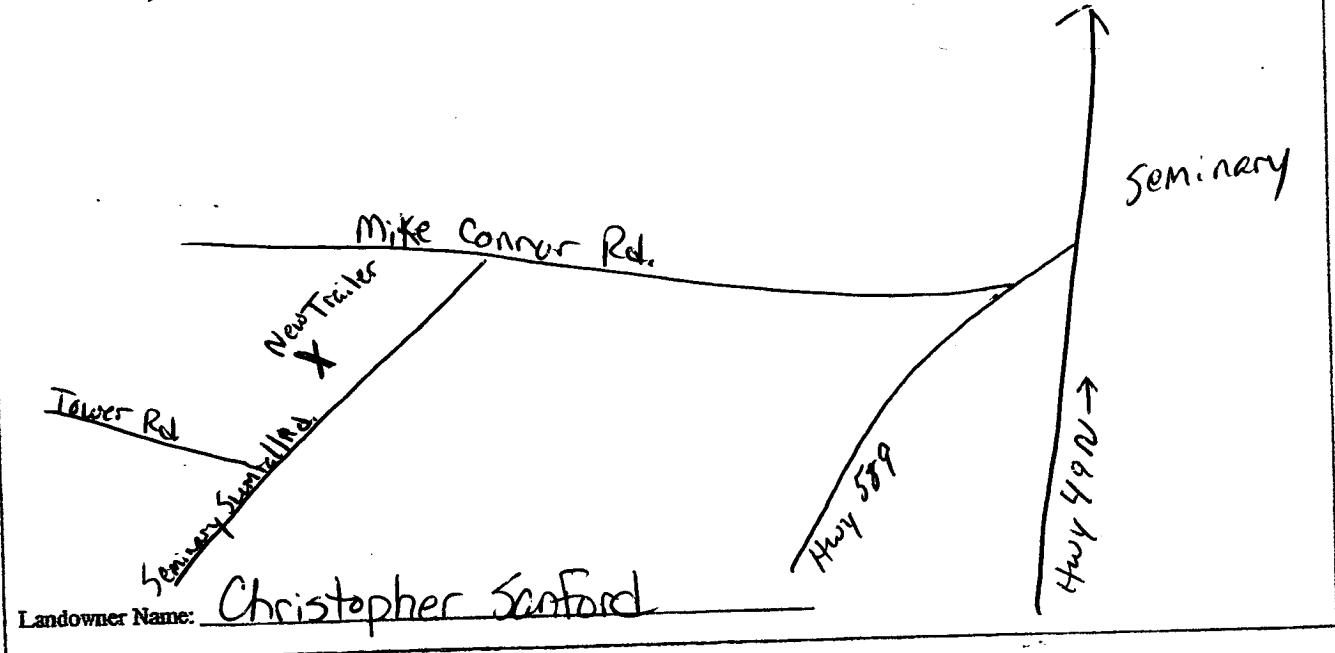

James Wells  
Signature of Water Well Contractor

RECEIVED  
JUN 04 2010  
BY: OLWR

# STATE WELL REPORT

## Part 2

Pump Installer's Completion Report  
Mississippi Department of Environmental Quality  
Office of Land and Water Resources  
P.O. Box 10631  
Jackson, MS 39289-0631  
(601)961-5210  
(601)354-6938 (fax)

For Office Use Only:

Aquifer: B71  
Well #: \_\_\_\_\_  
Elevation: \_\_\_\_\_

County: Covington  
Permit #: \_\_\_\_\_  
Driller: JAMES WELLS  
Date completed: 5-13-10

This report should be prepared by the pump installer in detail and filed with the Department within 30 days of the installation of pump.

Well Owner Information	Well Location
Owner Name: <u>Christopher Sanford</u>	Latitude: _____ Longitude: _____
Mailing Address: <u>218 Tower Rd.</u>	Method of Lat/Long (circle one): Conventional Survey, USGS quad, Hand-held GPS, Survey-grade GPS
<u>Seminary MS 39479</u> City State Zip Code	<u>1/4 1/4 Sec 29 Twn 7N Rng 15W</u>
Telephone No. <u>(601) 641-1100</u>	Distance Direction Nearest Town <u>5 Miles SW of Seminary</u>

Pump Type Circle one	Power Type Circle one
Air Lift Jet <u>Submersible</u>	Diesel Engine Gasoline Engine Natural Gas
Bucket Piston Turbine	<u>Electric Motor</u> Hand Tractor PTO
Centrifugal Rotary Flowing Well	Windmill Other (specify): _____
Other (specify): _____	Horse Power Rating of Motor: <u>1</u>
Date Pump Installed: <u>5-13-10</u>	Setting Depth: <u>80</u> feet
Rated Pump Capacity: <u>12</u> Gallons Per Minute	Number of Stages: <u>14</u>

Pump Test Data	Method of Measuring Water Level Circle one
Date Well Tested: <u>5-13-10</u>	Air Line Electric Measuring Line <u>Steel Tape</u>
Static Water Level (A): <u>65</u> Feet Below Land Surface	Other (specify): _____
Pumping Water Level (B): <u>80</u> Feet Below Land Surface	For flowing well, measured shut in head: _____ feet
Drawdown [(B) - (A)]: <u>70</u> Feet Below Land Surface	Well yielded <u>18</u> GPM with a drawdown of
Test Pumping Rate: <u>18</u> Gallons Per Minute	<u>5</u> feet after <u>4</u> hours of pumping
Duration of Pump Test (minimum 4 hours): <u>4</u> hours	

I HEREBY CERTIFY that the above statements are true to the best of my knowledge.

JAMES WELLS 0-586  
Print Name of Pump Installer and License No. (if applicable)

James Wells  
Signature of Pump Installer

RECEIVED  
JUN 04 2010  
BY: OLWR