

County: Covington
 Permit #: 0-586
 Driller: JAMES WELLS
 Date drilling completed: 8-22-12

State Well Report
Part 1 - Driller's Log
 Mississippi Department of Environmental Quality
 Office of Land and Water Resources
 P.O. Box 2309
 Jackson, MS 39225
 (601)961-5210
 (601)961-5228 (fax)

For Office Use Only:
 Aquifer: _____
 Well #: H30
 L. S. Elevation: _____
 E-log #: _____

State Law requires that this report be prepared by the license holder responsible for the work and filed with the Department at the above address within 30 days of completion of drilling of the well or borehole.

Information on Well Owner <i>(Landowner if borehole is not for a water well)</i>	Well or Borehole Location
Owner Name: <u>David M Queen</u>	Latitude: <u>31° 37' 46" N</u> Longitude: <u>89° 24' 38" W</u>
Mailing Address: <u>137 Joe Rawls Rd</u> <u>Collins MS</u> <u>39428</u>	Method of Survey (circle one): <u>Conventional Survey</u>
City: _____ State: _____ Zip Code: _____	USGS quad, Hand-held GPS, Survey-grade GPS: _____
Telephone No. (601) <u>6413198</u>	<u>NE 1/4 SW 1/4 Sec 28 Twn 8N Rng 14W</u>
	Distance: <u>2</u> Miles Direction: <u>SE</u> of Nearest Town: <u>Collins MS</u>

Well / Borehole Data

Date drilling started: 8-22-12 Date drilling completed: 8-22-12 Hole depth: 320 Hole diameter: 7

Location of the source of any surface water used for drilling: Creek

Method of dosing and volume of Chlorine used in drilling and development: Shank 300

Logs run (circle all applicable): No log run Electric Gamma Ray Density Sonic Neutron Other: _____

Name of organization running log(s): _____

Purpose of borehole (check one): Water Well Geotechnical/Geological Investigation Ground Source Heat Pump
 Seismic Survey Other (describe) _____

If drilling is not related to water well construction, skip the remainder of this block

Purpose of Well (check one): Home Industrial Public Supply Irrigation Fish Culture Other: _____

If a flowing well, method of flow regulation: Valve _____ Other (describe) _____

Static Water Level: 130 feet above or below (circle one) land surface Date measured: 8-22-12

Method of Measurement (circle one) steel tape electric tape air line other: _____

Well depth: 320 Well grouted to a depth of 10 feet Type of grout (circle one): Neat Cement Bentonite Mix

Casing length: 290 feet Casing diameter: 4 inches Type of casing: PVC

Screen length: 30 feet Screen diameter: 4 inches Type of screen: PVC

Screen slot size: .008 inches Setting depth: From 290 feet to 320 feet

Type of completion (circle all applicable): Gravel packed Underreamed Telescoped Open hole Natural Development

Other (describe): _____

Top of lap pipe or reduction in casing: _____ feet. *If telescoped or more than one screen, describe on next page*

Form: OLWR-SWR-1A (04/08)

RECEIVED
 OCT 04 2012
 BY: OLWR

If well telescopes please sketch below and show depths.

Ground Level

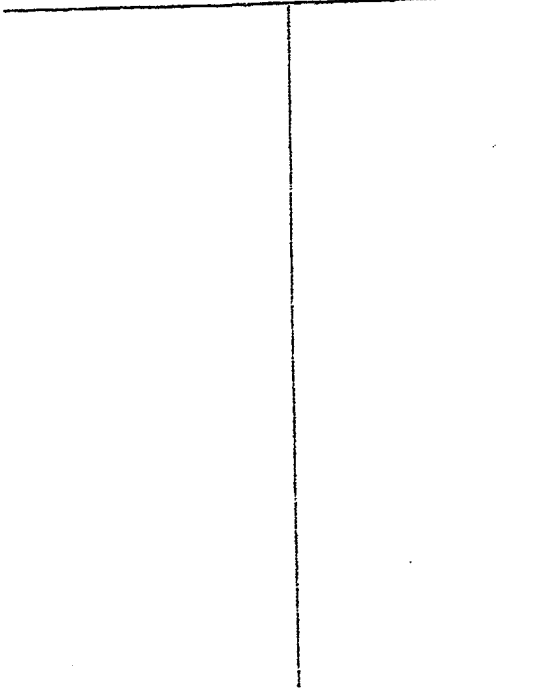

Description of Formations Encountered	From	To
7' Sand	0	7
Clay	7	240
Sand	240	280
Red gravel	280	320

If more than one screen, show location of each on sketch

Sketch the property layout and include the following: 1) the well location; 2) any permanent structures on the property that may aid in locating the well; 3) any roads, power lines, or other items that may aid in locating the property and the well; 4) indicate direction.

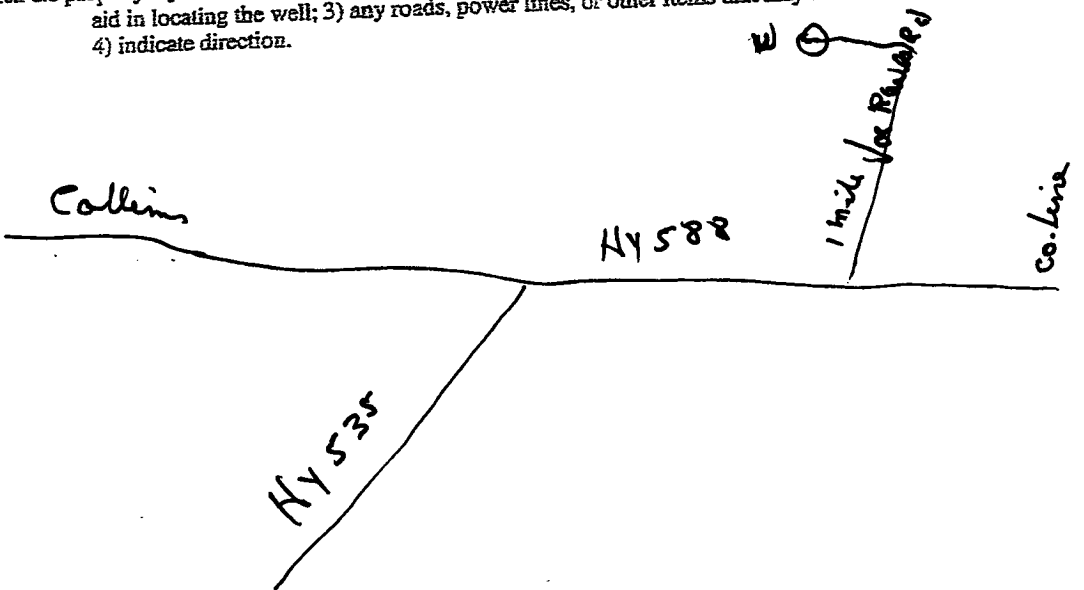

Landowner Name: David McQueen

James Wells
Signature of Water Well Contractor

RECEIVED
OCT 04 2012
BY: OLWR

STATE WELL REPORT

Part 2

Pump Installer's Completion Report
Mississippi Department of Environmental Quality
Office of Land and Water Resources
P.O. Box 10631
Jackson, MS 39289-0631
(601)961-5210
(601)354-6938 (fax)

For Office Use Only:

County: Collington
 Permit #: _____
 Driller: JAMES WELLS
 Date completed: 8-22-12

Aquifer: _____
 Well #: H30
 Elevation: _____

This report should be prepared by the pump installer in detail and filed with the Department within 30 days of the installation of pump.

Well Owner Information	Well Location
Owner Name: <u>David McQueen</u>	Latitude: <u>30° 59' 936" N</u> Longitude: <u>89° 05' 6.906" W</u>
Mailing Address: <u>Joe Rauls Rd</u>	Method of Lat/Long (circle one): <input checked="" type="checkbox"/> Conventional Survey, <input type="checkbox"/> Hand-held GPS, <input type="checkbox"/> Survey-grade GPS
<u>Collins MS</u>	USGS quad, <u>NE 1/4 SW 1/4 Sec 28 Twn 8N Rng 14W</u>
<u>39428</u>	Distance Direction Nearest Town
City State Zip Code	<u>8 Miles S.E. of Collins MS</u>
Telephone No. <u>(601) 641 3198</u>	

Pump Type Circle one	Power Type Circle one
Air Lift <input type="checkbox"/> Jet <input checked="" type="checkbox"/> <u>Submersible</u>	Diesel Engine <input type="checkbox"/> Gasoline Engine <input type="checkbox"/> Natural Gas <input type="checkbox"/>
Bucket <input type="checkbox"/> Piston <input type="checkbox"/> Turbine <input type="checkbox"/>	<u>Electric Motor</u> <input checked="" type="checkbox"/> Hand <input type="checkbox"/> Tractor PTO <input type="checkbox"/>
Centrifugal <input type="checkbox"/> Rotary <input type="checkbox"/> Flowing Well <input type="checkbox"/>	Windmill <input type="checkbox"/> Other (specify): _____
Other (specify): _____	Horse Power Rating of Motor: <u>5 HP</u>
Date Pump Installed: <u>8-22-12</u>	Setting Depth: <u>200</u> feet
Rated Pump Capacity: <u>50</u> Gallons Per Minute	Number of Stages: <u>11</u>

Pump Test Data	Method of Measuring Water Level Circle one
Date Well Tested: <u>8-22-12</u>	Air Line <input type="checkbox"/> Electric Measuring Line <input type="checkbox"/> Steel Tape <input type="checkbox"/>
Static Water Level (A): <u>130</u> Feet Below Land Surface	Other (specify): _____
Pumping Water Level (B): <u>200</u> Feet Below Land Surface	For flowing well, measured shut in head: _____ feet
Drawdown [(B) - (A)]: <u>150</u> Feet Below Land Surface	Well yielded <u>50</u> GPM with a drawdown of
Test Pumping Rate: <u>50</u> Gallons Per Minute	<u>130</u> feet after <u>4</u> hours of pumping
Duration of Pump Test (minimum 4 hours): <u>4</u> hours	

I HEREBY CERTIFY that the above statements are true to the best of my knowledge.

JAMES WELLS 0-586
 Print Name of Pump installer and License No. (if applicable)

James Wells
 Signature of Pump installer

RECEIVED

OCT 04 2012

BY: OLWR