

STATE WELL REPORT

Part 1

Driller's Log

Mississippi Department of Environmental Quality
Office of Land and Water Resources
P.O. Box 2309
Jackson, MS 39225-2309
(601)961-5210
(601)360-0535 (fax)

For Office Use Only:

Well #: G 86
Aquifer: _____
E-Log #: _____

County: Covington
Permit #: _____
Driller: James M. Wells
Date drilling completed: 3-17-20

State Law requires that this report be prepared by the license holder responsible for the work and filed with the Department at the above address within 30 days of completion of drilling of the well or borehole.

Well Owner Information (Landowner if borehole is not for a water well)	Well or Borehole Location
Owner Name: <u>Fulcrum Construction</u>	Latitude: <u>31° 41.12' N</u> Longitude: <u>89° 27.43' W</u>
Mailing Address: _____	Method of Lat/Long (check one): Conventional Survey _____
<u>810 Manai Ave</u>	USGS quad _____, Hand-held GPS _____, Survey-grade GPS _____
<u>Daphne AL 36526</u>	<u>SE</u> ¼ <u>NW</u> ¼, Sec <u>1</u> T <u>8N</u> R <u>15W</u>
City State Zip Code	_____ Miles _____ of _____
Telephone No. (____) _____	(Distance) (Direction) (Nearest Town)

Well / Borehole Data

Date drilling started: 3-16-20 Date drilling completed: 3-17-20 Hole depth: 175 Hole diameter: 7 1/2

Location of the source of any surface water used for drilling: Running creek

Method of dosing and volume of Chlorine used in drilling and development: granule chlorine

Logs run (circle all applicable): No log run Electric Gamma Ray Density Sonic Neutron Other: _____

Name of organization running log(s): _____

Purpose of borehole (circle one): Water Well Geotechnical/Geological Investigation Ground Source Heat Pump

If drilling is not related to water well construction, skip the remainder of this block

Purpose of Well (circle all applicable): Home Industrial Public Supply Irrigation Fish Culture

Other (describe): public restroom

If a flowing well, method of flow regulation: Valve _____ Other (describe) _____

Static Water Level: 50 feet [above or below] land surface Date measured: 3-17-20

Method of measurement (circle one): Steel tape Electric tape Air line Other (describe): _____

Well depth: 175 Well grouted to a depth of: 100 feet Type of grout (circle one): Neat Cement Bentonite Mix

Casing length: 155 feet Casing diameter: 4 inches Type of casing: steel

Screen length: 20 feet Screen diameter: 4 inches Type of screen: stainless steel

Screen slot size: .008 inches Setting depth: From 155 feet to 175 feet

Type of completion (circle all applicable): Gravel packed Underreamed Open hole Natural Development

Other (describe): _____

Top of lap pipe or reduction in casing: _____ feet

If telescoped or more than one screen, describe on next page

RECEIVED
JUN 15 2020
BY OLWR

County: Covington
Permit #: _____

For Office Use Only:
Well #: _____

The sketch below only required for water wells

If well telescopes, show depths on sketch.

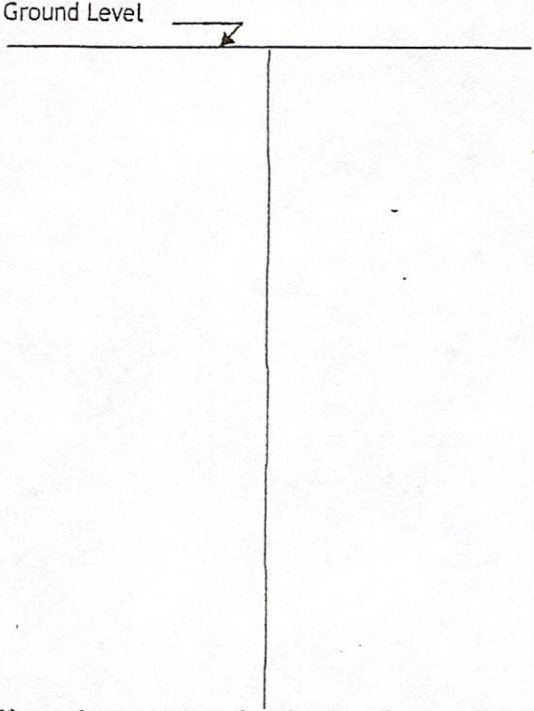

Description of formations encountered must be provided for all wells and boreholes, unless specifically exempted by regulations

Description of Formations Encountered	From (depth)	To (depth)
Clay	Ground level	65
Sand & silt	65	175

If more than one screen, show location of each on sketch

Sketch the property layout and include the following:

- 1) the well location
- 2) any permanent structures on the property that may aid in locating the well
- 3) any roads, power lines, or other items that may aid in locating the property and the well
- 4) north arrow

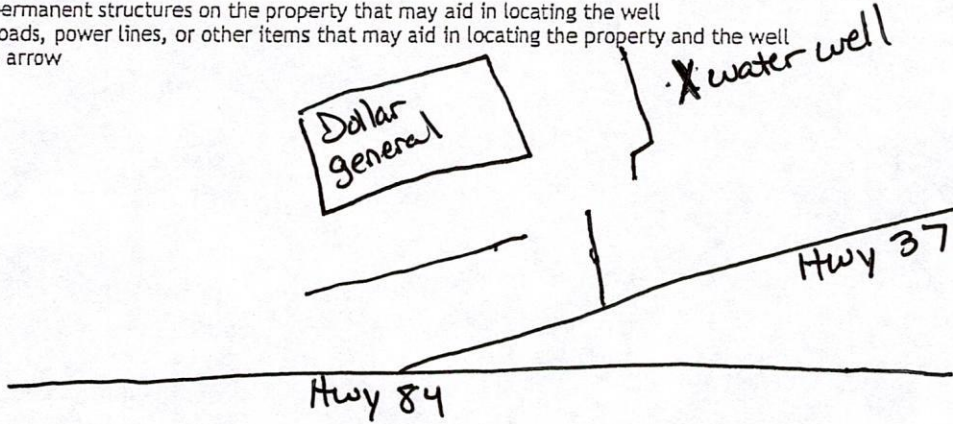

RECEIVED
JUN 15 2020
BY OLWR

Landowner Name: Fulcrum Construction

I HEREBY CERTIFY that the well/borehole was drilled, constructed, and completed in accordance with all applicable requirements of the Mississippi Department of Environmental Quality and the Mississippi Department of Health regulations, if applicable, and state laws.

James M. Wells 00005889 4-4-20 James M. Wells
Print Name of Responsible Licensee and License No. Date Signature of Licensee

STATE WELL REPORT

Part 2

Pump Installer's Completion Report
 Mississippi Department of Environmental Quality
 Office of Land and Water Resources
 P.O. Box 2309
 Jackson, MS 39225-2309
 (601)961-5210
 (601) 360-0535 (fax)

County: Covington
 Permit #: _____
 Driller: James M. Wells
 Date completed: 3.17.20
Copy information from block on Part 1

For Office Use Only:
 Well #: 686
 Aquifer: _____

This part of the report must be completed by a licensed water well contractor or a licensed pump installer. A copy of Part 1 of the report must be attached and both parts filed with the Department at the above address within 30 days of well completion.

Well Owner Information	Well Location
Owner Name: <u>Fulcrum Construction</u>	Latitude: <u>31°41.12N</u> Longitude: <u>89°27.43W</u>
Mailing Address: _____	Method of Lat/Long (check one): <u>31 41 28.03</u> <u>89 27 40.10</u> Conventional Survey _____
<u>810 Manai Ave.</u>	USGS quad _____, Hand-held GPS _____, Survey-grade GPS _____
<u>Daphne</u> <u>Al.</u> <u>36526</u>	<u>SE</u> ¼ <u>NW</u> ¼, Sec <u>1</u> T <u>8N</u> R <u>15W</u>
City State Zip Code	_____ Miles _____ of _____ (Distance) (Direction) (Nearest Town)
Telephone No. (____) _____	

Pump Type (circle one)

Submersible Turbine Air Lift Centrifugal Flowing Well Jet Piston Rotary Other (describe): _____

Date Pump Installed: 3.17.20 Rated Pump Capacity: 18 Gallons Per Minute

Is This Pump (circle one): New Repaired Replacement

Power Type (circle one)

Electric Diesel Gasoline Natural Gas Tractor PTO Windmill Other (describe): _____

Horse Power Rating of Motor: 1 1/2 Setting Depth: 105 feet Number of Stages: 15

Pump Test Data for Non Flowing Well

Date Well Tested: 3-17-20 Duration of Pump Test (minimum 4 hours): 4 hours

Static Water Level (A): 50 Feet Below Land Surface Pumping Water Level (B): 105 Feet Below Land Surface

Drawdown [(B) - (A)]: 65 Feet Below Land Surface Test Pumping Rate: 25 Gallons Per Minute

Method of measurement (circle one): Steel tape Electric tape Air line Other (describe): _____

Pump Test Data for Flowing Well

Measured shut in head: _____ feet.

Well yielded _____ GPM with a drawdown of _____ feet after _____ hours of pumping

Meter Installation

Meter Manufacturer: _____ Meter Serial Number: _____

Meter Model Number/Name: _____ Type of Meter: _____

Totalizer Register Unit and Multiplier Factor (AF x .001, gal x 1000, etc): _____

Installation Date: _____ Meter installed by: _____

Is This Meter (circle one): New Repaired Replacement

Important: By submitting the above information you are certifying that this meter was installed to manufacturer standards. For agricultural wells, a list of approved meters is on the MDEQ website.

I HEREBY CERTIFY that the above statements are true to the best of my knowledge.

James M. Wells 00005889 4.4.20 James M. Wells
 Print Name of Pump Installer and License No. (if applicable) Date Signature of Pump Installer

RECEIVED
 JUN 15 2020
 BY OLWR