

# State Well Report

## Part 1

Mississippi Department of Environmental Quality  
Office of Land and Water Resources  
P.O. Box 10631  
Jackson, MS 39289-0631  
(601)961-5210  
(601)354-6938 (fax)

### For Office Use Only:

Aquifer: \_\_\_\_\_  
Well #: U23  
L. S. Elevation: \_\_\_\_\_  
E-log #: \_\_\_\_\_

County: Copiah  
Permit #: \_\_\_\_\_  
Driller: GRENN WATER WELL & SUPPLY, INC.  
Date drilling completed: 9-28-12

State Law requires that this report be prepared by the driller in detail and filed with the Department within 30 days of completion of drilling of the well.

Well Owner Information	Well Location
Owner Name: <u>Stacy Newell</u>	Latitude: <u>31° 42' 37.9"</u> Longitude: <u>90° 30' 6.54"</u>
Mailing Address: <u>5080 Watson Rd.</u>	Method of Lat/Long (circle one): <u>Conventional Survey</u>
<u>Watson, Ms. 39191</u>	USGS quad, <u>Hand-held GPS</u> , Survey-grade GPS
City State Zip Code	<u>NE 1/4 SW 1/4 Sec 33 Twn 9N Rng 7E</u>
Telephone No. <u>(601) 748-2050</u>	Distance Direction Nearest Town <u>7 Miles NW of Watson</u>
Well Data	
Purpose of Well (circle one) Home Industrial Public Supply Irrigation Fish Culture Other: <u>Dairy</u>	
Date well drilling started: <u>9-28-12</u> Date well drilling completed: <u>9-28-12</u>	
If flowing, method of flow regulation: Valve _____ Other (describe) _____	
Static Water Level: <u>105</u> feet above or below (circle one) land surface Date measured: <u>9-28-12</u>	
Method of Measurement (circle one) steel tape <u>electric tape</u> air line other: _____	
Hole depth: <u>241</u> Well depth: <u>236</u> Well grouted to a depth of <u>10</u> feet	
Type of grout (circle one): Cement <u>Bentonite</u> Mix	
Casing length: <u>216</u> feet Casing diameter: <u>4</u> inches Type of casing: <u>PVC</u>	
Screen length: <u>20</u> feet Screen diameter: <u>4</u> inches Type of screen: <u>PVC</u>	
Screen slot size: <u>1010</u> inches Setting depth: From <u>216</u> feet to <u>236</u> feet	
Type of completion (circle all applicable): <u>Gravel packed</u> Underreamed Telescoped Open hole Natural Development	
Other (describe): _____	
Top of lap pipe or reduction in casing: _____ feet. If telescoped or more than one screen, describe on back of page	
Logs run (circle all applicable): <u>No log run</u> Electric Gamma Ray Density Sonic Neutron Other: _____	
Name of organization running log(s): _____	
I certify that the well was drilled, constructed, and completed in accordance with all applicable requirements of the Mississippi Department of Environmental Quality and/or the Mississippi Department of Health regulations and state laws.	
GRENN WATER WELL & SUPPLY, INC. BRIAN D. McCLENDON, UNR-00000664	
Print Name of Water Well Contractor and License No.	Signature of Water Well Contractor <u>Brian McCleendon</u>

RECEIVED

OCT 5 2012

BY: OLIVER

If well telescopes please sketch below and show depths.

Ground Level

Description of Formations Encountered	From	To
red clay	0	17
gravel	17	30
white clay	30	63
blue clay	63	110
mixed clays	110	200
sand	200	236
blue clay	236	241

If more than one screen, show location of each on sketch

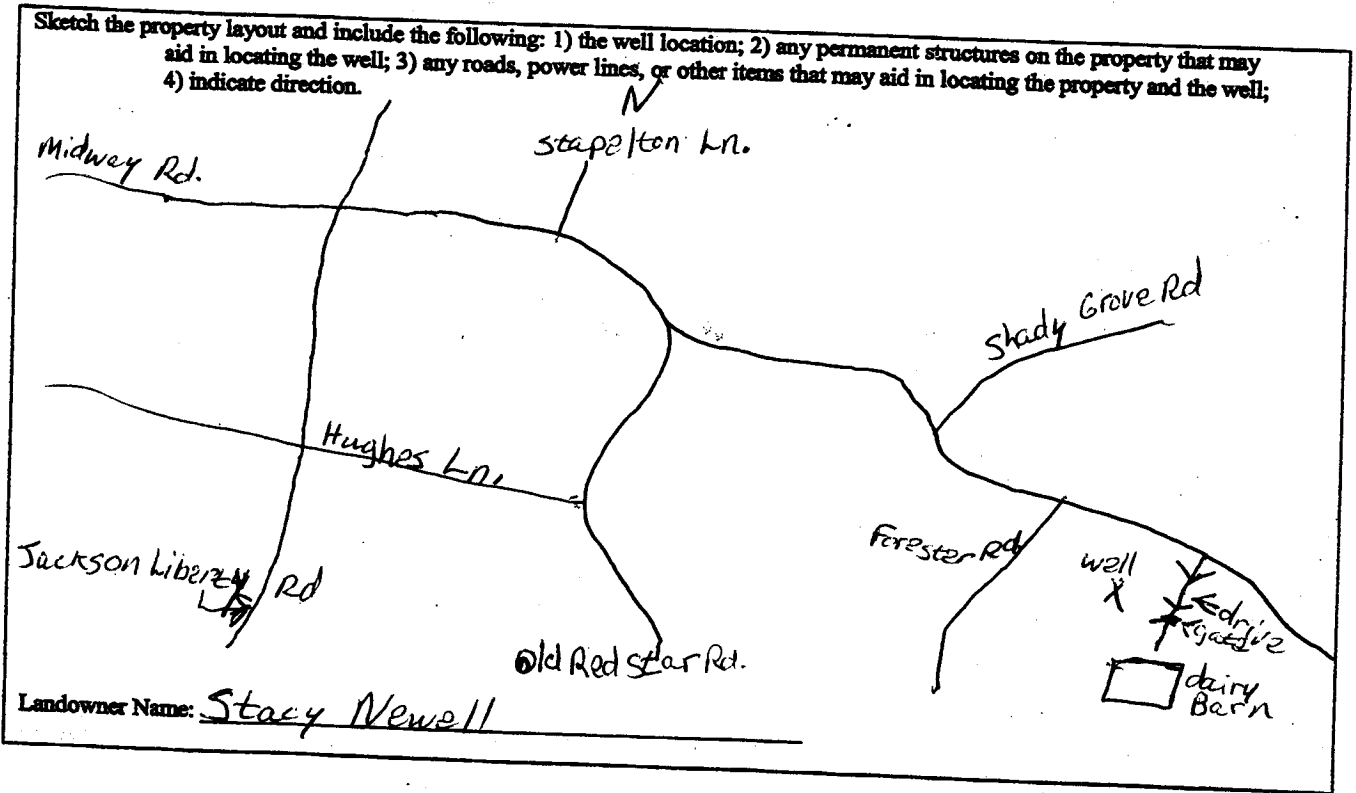

Brian McClendon 664  
 Signature of Water Well Contractor

# STATE WELL REPORT

## Part 2

**Pump Installer's Completion Report**  
 Mississippi Department of Environmental Quality  
 Office of Land and Water Resources  
 P.O. Box 10631  
 Jackson, MS 39289-0631  
 (601)961-5210  
 (601)354-6938 (fax)

County: Copiah  
 Permit #: \_\_\_\_\_  
 Driller: GRENN WATER WELL & SUPPLY, INC.  
 Date completed: 10/8/12

**For Office Use Only:**

Aquifer: \_\_\_\_\_  
 Well #: U23  
 Elevation: \_\_\_\_\_

This report should be prepared by the pump installer in detail and filed with the Department within 30 days of the installation of pump.

Well Owner Information	Well Location
Owner Name: <u>Stacy Newell</u>	Latitude: <u>31°42'379"</u> Longitude: <u>90°30'654"</u>
Mailing Address: <u>5080 Watson Rd</u>	Method of Lat/Long (circle one): <u>Conventional Survey</u> , USGS quad: <u>Hand-held GPS</u> Survey-grade GPS
<u>Wesson MS 39191</u> City State Zip Code	<u>NW 1/4 SW 1/4 Sec 33 Twn 9N Rng 7E</u> Distance Direction Nearest Town
Telephone No. <u>(601) 748-2050</u>	<u>7</u> Miles <u>N</u> of <u>Wesson</u>

Pump Type Circle one	Power Type Circle one
Air Lift Jet <u>Submersible</u>	Diesel Engine Gasoline Engine Natural Gas
Bucket Piston Turbine	<u>Electric Motor</u> Hand Tractor PTO
Centrifugal Rotary Flowing Well	Windmill Other (specify): _____
Other (specify): _____	Horse Power Rating of Motor: <u>3</u>
Date Pump Installed: <u>10/8/12</u>	Setting Depth: <u>150</u> feet
Rated Pump Capacity: <u>25</u> Gallons Per Minute	Number of Stages: <u>15</u>

Pump Test Data	Method of Measuring Water Level Circle one
Date Well Tested: <u>10/8/12</u>	Air Line <u>Electric Measuring Line</u> Steel Tape
Static Water Level (A): <u>105</u> Feet Below Land Surface	Other (specify): _____
Pumping Water Level (B): <u>121</u> Feet Below Land Surface	For flowing well, measured shut in head: _____ feet
Drawdown [(B) - (A)]: <u>16</u> Feet Below Land Surface	Well yielded <u>31</u> GPM with a drawdown of
Test Pumping Rate: <u>31</u> Gallons Per Minute	<u>16</u> feet after <u>4</u> hours of pumping
Duration of Pump Test (minimum 4 hours): <u>4</u> hours	

I HEREBY CERTIFY that the above statements are true to the best of my knowledge.

WILLIAM L. HARDIN, V, UNR-00000802  
 Print Name of Pump Installer and License No. (if applicable)

William Hardin  
 Signature of Pump Installer

RECEIVED  
 10/15/2012  
 BY: OLWR