

State Well Report

Part 1

Mississippi Department of Environmental Quality
Office of Land and Water Resources
P.O. Box 10631
Jackson, MS 39289-0631
(601)961-5210
(601)354-6938 (fax)

For Office Use Only:

Aquifer: P 36
Well #: _____
L. S. Elevation: _____
E-log #: _____

County: Copiah
Permit #: _____
Driller: GRENN WATER WELL &
SUPPLY, INC.
Date drilling completed: 1/25/10

State Law requires that this report be prepared by the driller in detail and filed with the Department within 30 days of completion of drilling of the well.

Well Owner Information	Well Location
Owner Name <u>Zerra Harris</u>	Latitude: <u>31° 48' 984"</u> Longitude: <u>90° 11' 64"</u>
Mailing Address: <u>5079 Monticello Rd</u>	Method of Lat/Long (circle one): <u>59</u> Conventional Survey, <u>38</u>
<u>Wesson MS 39191</u>	USGS quad, <u>Hand-held GPS</u> Survey-grade GPS
City State Zip Code	<u>SE</u> 1/4 <u>NW</u> 1/4 Sec <u>27</u> Twn <u>10N</u> Rng <u>10E</u>
Telephone No. <u>(601) 953-0148</u>	Distance <u>4</u> Miles Direction <u>28</u> Nearest Town <u>Georgetown</u>

Well Data

Purpose of Well (circle one) Home Industrial Public Supply Irrigation Fish Culture Other: _____

Date well drilling started: 1/25/10 Date well drilling completed: 1/25/10

If flowing, method of flow regulation: Valve _____ Other (describe) _____

Static Water Level: 74 feet above or below (circle one) land surface Date measured: 1/25/10

Method of Measurement (circle one) steel tape electric tape air line other: _____

Hole depth: 114 Well depth: 110 Well grouted to a depth of 10 feet

Type of grout (circle one): Cement Bentonite Mix

Casing length: 100 feet Casing diameter: 4 inches Type of casing: PVC

Screen length: 10 feet Screen diameter: 4 inches Type of screen: slotted PVC

Screen slot size: .010 inches Setting depth: From 100 feet to 110 feet

Type of completion (circle all applicable): Gravel packed Underreamed Telescoped Open hole Natural Development

Other (describe): _____

Top of lap pipe or reduction in casing: _____ feet. If telescoped or more than one screen, describe on back of page

Logs run (circle all applicable) No log run Electric Gamma Ray Density Sonic Neutron Other: _____

Name of organization running log(s): _____

I certify that the well was drilled, constructed, and completed in accordance with all applicable requirements of the Mississippi Department of Environmental Quality and/or the Mississippi Department of Health regulations and state laws.

GRENN WATER WELL & SUPPLY, INC.
WILLIAM L. HARDIN, LIC. NO. 0-802

Print Name of Water Well Contractor and License No.

Choy Hardin (William)
Signature of Water Well Contractor

RECEIVED
FEB 17 2010
BY: OLWR

If well telescopes please sketch below and show depths.

Ground Level

Description of Formations Encountered	From	To
Red Clay	0	12
Sand & Gravel	12	43
Blue Clay	43	72
Sand	72	111
White Clay	111	113

If more than one screen, show location of each on sketch

Sketch the property layout and include the following: 1) the well location; 2) any permanent structures on the property that may aid in locating the well; 3) any roads, power lines, or other items that may aid in locating the property and the well; 4) indicate direction.

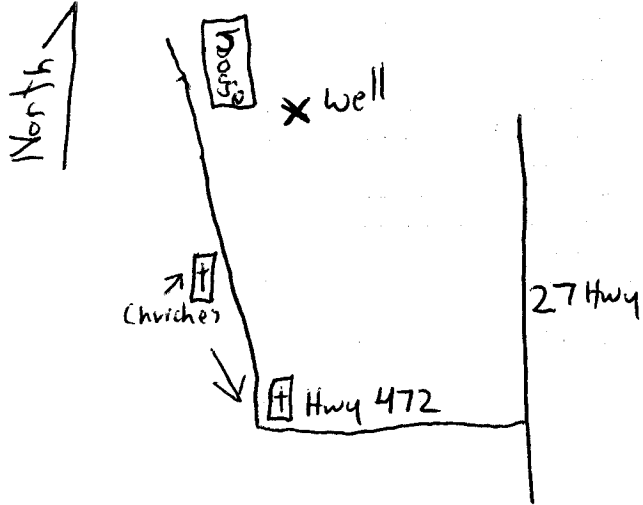

Landowner Name: Zerra Harris

GRENN WATER WELL & SUPPLY, INC.
WILLIAM L. HARDIN, LIC. NO. 0-802

William Hardin (Chaz)
Signature of Water Well Contractor

STATE WELL REPORT

Part 2

Pump Installer's Completion Report
 Mississippi Department of Environmental Quality
 Office of Land and Water Resources
 P.O. Box 10631
 Jackson, MS 39289-0631
 (601)961-5210
 (601)354-6938 (fax)

For Office Use Only:

Aquifer: R 36
 Well #: _____
 Elevation: _____

County: Copiah
 Permit #: _____
 Driller: GRENN WATER WELL & SUPPLY, INC.
 Date completed: 1/25/10

This report should be prepared by the pump installer in detail and filed with the Department within 30 days of the installation of pump.

Well Owner Information	Well Location
Owner Name: <u>Zetta Harris</u>	Latitude: <u>31°48' 984"</u> Longitude: <u>90° 11' 64"</u>
Mailing Address: <u>5079 Monticello Rd</u>	Method of Lat/Long (circle one): Conventional Survey, USGS quad, <u>Hand-held GPS</u> , Survey-grade GPS
<u>Wesson</u> MS <u>39191</u>	<u>SE 1/4 NW 1/4 Sec 27 Twn 10N Rng 10E</u>
City State Zip Code	Distance Direction Nearest Town
Telephone No. <u>(601) 953 0148</u>	<u>4</u> Miles <u>S</u> of <u>Georgetown</u>

Pump Type Circle one	Power Type Circle one
Air Lift Jet <input checked="" type="radio"/> <u>Submersible</u>	Diesel Engine Gasoline Engine Natural Gas
Bucket Piston Turbine	<input checked="" type="radio"/> <u>Electric Motor</u> Hand Tractor PTO
Centrifugal Rotary Flowing Well	Windmill Other (specify): _____
Other (specify): _____	Horse Power Rating of Motor: <u>3/4</u>
Date Pump Installed: <u>1/25/10</u>	Setting Depth: <u>100</u> feet
Rated Pump Capacity: <u>10</u> Gallons Per Minute	Number of Stages: <u>12</u>

Pump Test Data	Method of Measuring Water Level Circle one
Date Well Tested: <u>1/25/10</u>	Air Line <input checked="" type="radio"/> <u>Electric Measuring Line</u> Steel Tape
Static Water Level (A): <u>74</u> Feet Below Land Surface	Other (specify): _____
Pumping Water Level (B): <u>80</u> Feet Below Land Surface	For flowing well, measured shut in head: _____ feet
Drawdown [(B) - (A)]: <u>6</u> Feet Below Land Surface	Well yielded <u>13</u> GPM with a drawdown of
Test Pumping Rate: <u>13</u> Gallons Per Minute	<u>6</u> feet after <u>4</u> hours of pumping
Duration of Pump Test (minimum 4 hours): <u>4</u> hours	

I HEREBY CERTIFY that the above statements are true to the best of my knowledge.
 GRENN WATER WELL & SUPPLY, INC.
 Brian D. McClendon, lic. no. 0-664
 Print Name of Pump Installer and License No. (if applicable)

Chaz Hardin William
 Signature of Pump Installer

RECEIVED

FEB 17 2010

BY: OLWR