

State Well Report

Part 1 - Driller's Log

Mississippi Department of Environmental Quality
Office of Land and Water Resources
P.O. Box 2309
Jackson, MS 39225
(601)961- 5210
(601)961- 5228 (fax)

County: Cochahoma
Permit #: 47746
Driller: Joel Jumper
Date drilling completed: 10-28-13

For Office Use Only:
Aquifer: _____
Well #: 0150
L. S. Elevation: _____
E-log #: _____

State Law requires that this report be prepared by the license holder responsible for the work and filed with the Department at the above address within 30 days of completion of drilling of the well or borehole.

Information on Well Owner (Landowner if borehole is not for a water well)	Well or Borehole Location
Owner Name: <u>Lonny Williams</u>	Latitude: <u>34° 01' 19"</u> Longitude: <u>90° 30' 00"</u>
Mailing Address: <u>2684 Dog Walk Road</u> <u>Clarksdale Ms 38614</u> City State Zip Code	Method of Lat/Long (circle one): Conventional Survey, USGS quad, <u>Hand-held GPS</u> , Survey-grade GPS
Telephone No. () _____	<u>NW 1/4 SW 1/4 Sec 22 Twn 25 N Rng 03 W</u> Distance Direction Nearest Town <u>15</u> Miles <u>SE</u> of <u>Clarksdale</u>

Well / Borehole Data

Date drilling started: 10-28-13 Date drilling completed: 10-28-13 Hole depth: 120 Hole diameter: 18.75

Location of the source of any surface water used for drilling: Nearest Well
Method of dosing and volume of Chlorine used in drilling and development: _____

Logs run (circle all applicable): No log run Electric Gamma Ray Density Sonic Neutron Other: _____
Name of organization running log(s): _____

Purpose of borehole (check one): Water Well Geotechnical/Geological Investigation _____ Ground Source Heat Pump _____
Seismic Survey _____ Other (describe) _____

If drilling is not related to water well construction, skip the remainder of this block

Purpose of Well (check one): Home _____ Industrial _____ Public Supply _____ Irrigation Fish Culture _____ Other: _____

If a flowing well, method of flow regulation: Valve _____ Other (describe) _____

Static Water Level: 42 feet above or below (circle one) land surface Date measured: 10-29-13

Method of Measurement (circle one) steel tape electric tape air line other: _____

Well depth: 120 Well grouted to a depth of 10 feet Type of grout (circle one): Neat Cement Bentonite Mix

Casing length: 80 feet Casing diameter: 8 inches Type of casing: PVC

Screen length: 40 feet Screen diameter: 8 inches Type of screen: PVC

Screen slot size: .50 inches Setting depth: From 0 feet to 70 feet

Type of completion (circle all applicable): Gravel packed Underreamed Telescoped Open hole Natural Development
Other (describe): _____

Top of lap pipe or reduction in casing: _____ feet. **If telescoped or more than one screen, describe on next page**

The sketch below only required for water wells

If well telescopes, show depths on sketch.

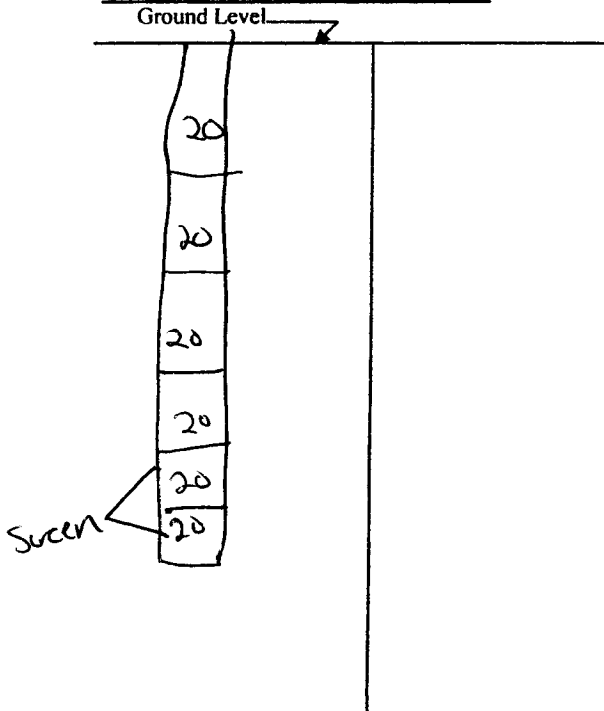

Description of formations encountered must be provided for all wells and boreholes, unless specifically exempted by regulations

Description of Formations Encountered	From (depth)	To (depth)
Gumbo	Ground Level	20
Gumbo	20	40
Sand	40	60
Sand	60	80
gravel	80	100
gravel + sand	100	120

If more than one screen, show location of each on sketch

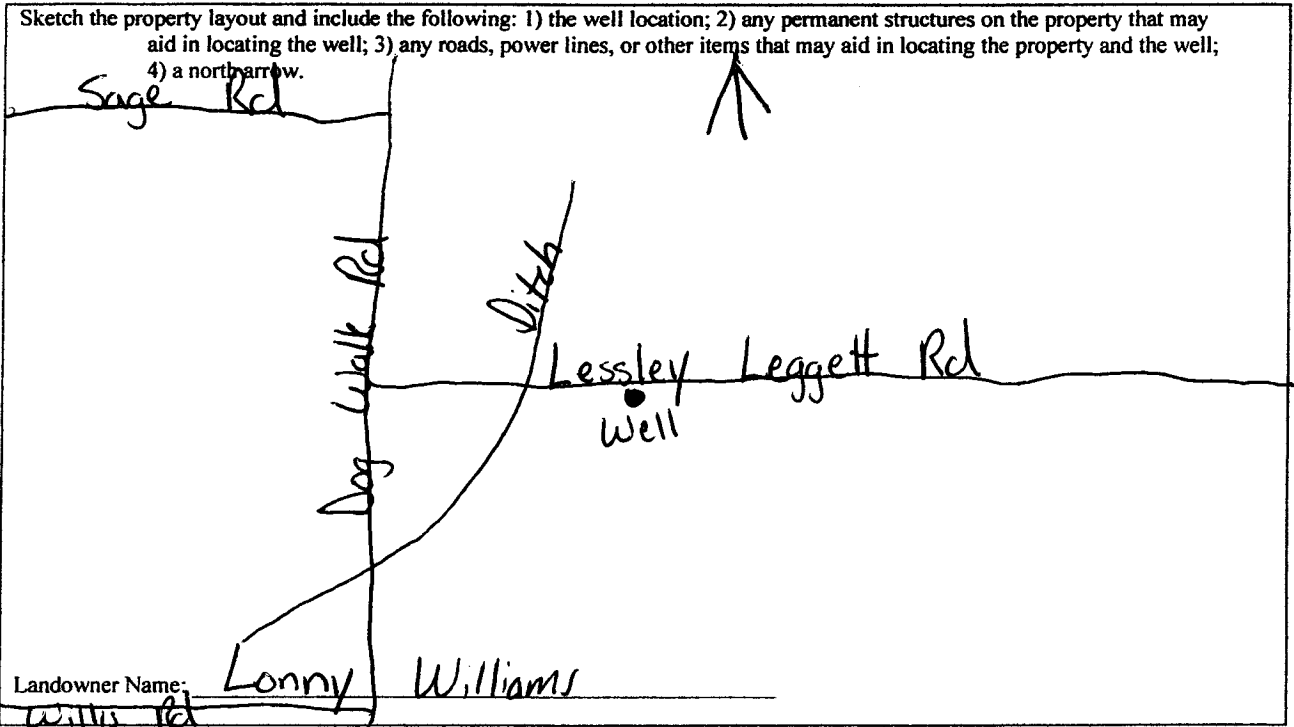

Form: OLWR-SWR-1A (04/08)

I certify that the well/borehole was drilled, constructed, and completed in accordance with all applicable requirements of the Mississippi Department of Environmental Quality and the Mississippi Department of Health regulations, if applicable, and state laws.

Joel Jumper 5317 10-29-13
 Print Name of Responsible Licensee and License No. Date

Joel Jumper
 Signature of Licensee

STATE WELL REPORT

Part 2

Pump Installer's Completion Report
 Mississippi Department of Environmental Quality
 Office of Land and Water Resources
 P.O. Box 2309
 Jackson, MS 39225-2309
 (601)961-5210
 (601) 360-0535 (fax)

County: Cochahoma
 Permit #: 477410
 Driller: Joel Jumper
 Date completed: 10-29-13
Copy information from block on Part 1

For Office Use Only:

Well #: _____
 Aquifer: _____

This part of the report must be completed by a licensed water well contractor or a licensed pump installer. A copy of Part 1 of the report must be attached and both parts filed with the Department at the above address within 30 days of well completion.

Well Owner Information	Well Location
Owner Name: <u>Lanny Williams</u>	Latitude: <u>34-01-19</u> Longitude: <u>90-30-00</u>
Mailing Address: <u>21854 Dog Walk Road</u>	Method of Lat/Long (check one): Conventional Survey _____, USGS quad _____, Hand-held GPS <input checked="" type="checkbox"/> , Survey-grade GPS _____
<u>Clarksdale</u> City <u>Ms</u> State <u>38614</u> Zip Code	<u>NW</u> ¼ <u>SW</u> ¼, Sec. <u>22</u> T. <u>25N</u> R. <u>03W</u>
Telephone No. (____) _____	<u>15</u> Miles (Distance) <u>SE</u> of <u>Clarksdale</u> (Direction) (Nearest Town)

Pump Type (circle one)

Submersible Turbine Air Lift Centrifugal Flowing Well Jet Piston Rotary Other (describe): _____

Date Pump Installed: 10-29-13 Rated Pump Capacity: 800 Gallons Per Minute

Is This Pump (circle one): New Repaired Replacement

Power Type (circle one)

Electric Diesel Gasoline Natural Gas Tractor PTO Windmill Other (describe): _____

Horse Power Rating of Motor: 15 Setting Depth: 70 feet Number of Stages: 1

Pump Test Data for Non Flowing Well

Date Well Tested: 10-29-13 Duration of Pump Test (minimum 4 hours): 8 hours

Static Water Level (A): 41 Feet Below Land Surface Pumping Water Level (B): 56 Feet Below Land Surface

Drawdown [(B) - (A)]: 15 Feet Below Land Surface Test Pumping Rate: 800 Gallons Per Minute

Method of measurement (circle one): Steel tape Electric tape Air line Other (describe): _____

Pump Test Data for Flowing Well

Measured shut in head: _____ feet.

Well yielded 800 GPM with a drawdown of 15 feet after 8 hours of pumping

Meter Installation

Meter Manufacturer: _____ Meter Serial Number: _____

Meter Model Number/Name: _____ Type of Meter: _____

Totalizer Register Unit and Multiplier Factor (AF x .001, gal x 1000, etc): _____

Installation Date: _____ Meter installed by: _____

Is This Meter (circle one): New Repaired Replacement

Important: By submitting the above information you are certifying that this meter was installed to manufacturer standards. For agricultural wells, a list of approved meters is on the MDEQ website.

I HEREBY CERTIFY that the above statements are true to the best of my knowledge.

Joel Jumper 5317 10-29-13 Paul Geyer
 Print Name of Pump Installer and License No. (if applicable) Date Signature of Pump Installer