

State Well Report

Part 1

Mississippi Department of Environmental Quality
 Office of Land and Water Resources
 P.O. Box 10631
 Jackson, MS 39289-0631
 (601)961-5210
 (601)354-6938 (fax)

County: Clarke
 Permit #: _____
 Driller: John W. Thompson
 Date drilling completed: 10-26-04

For Office Use Only:
 Aquifer: _____
 Well #: Q-78
 L. S. Elevation: _____
 E-log #: _____

23

State Law requires that this report be prepared by the driller in detail and filed with the Department within 30 days of completion of drilling of the well.

Well Owner Information	Well Location
Owner Name: <u>LLOG</u>	Latitude: <u>31° 57'</u> Longitude: <u>88° 48'</u>
Mailing Address: <u>433 Metairie Rd Suite 600</u> <u>Metairie LA 70005</u>	Method of Lat/Long (circle one): Conventional Survey, USGS quad, Hand-held GPS, Survey-grade GPS
City: _____ State: _____ Zip Code: _____	<u>1/4</u> <u>1/4</u> Sec <u>6</u> Twn <u>1N</u> Rng <u>15E</u>
Telephone No. (____) _____	Distance _____ Direction _____ Nearest Town _____ <u>2</u> Miles <u>S</u> of <u>Harmony</u>

Well Data

Purpose of Well (circle one) Home Industrial Public Supply Irrigation Fish Culture Other: rig supply

Date well drilling started: 10-26-04 Date well drilling completed: 10-26-04

If flowing, method of flow regulation: Valve _____ Other (describe) _____

Static Water Level: 49' feet above or below (circle one) land surface Date measured: 10-26-04

Method of Measurement (circle one) steel tape electric tape air line other: _____

Hole depth: 303 Well depth: 300 Well grouted to a depth of 10 feet

Type of grout (circle one): Cement Bentonite Mix

Casing length: 260 feet Casing diameter: 4 inches Type of casing: PVC

Screen length: 40 feet Screen diameter: 4 inches Type of screen: PVC slotted

Screen slot size: 008 + .00 inches Setting depth: From 260 feet to 300 feet

Type of completion (circle all applicable): Gravel packed Underreamed Telescoped Open hole Natural Development

Other (describe): _____

Top of lap pipe or reduction in casing: _____ feet. If telescoped or more than one screen, describe on back of page

Logs run (circle all applicable): No log run Electric Gamma Ray Density Sonic Neutron Other: _____

Name of organization running log(s): _____

I certify that the well was drilled, constructed, and completed in accordance with all applicable requirements of the Mississippi Department of Environmental Quality and/or the Mississippi Department of Health regulations and state laws.

John W. Thompson 0-0679

Print Name of Water Well Contractor and License No.

John W. Thompson
 Signature of Water Well Contractor

RECEIVED

NOV 16 2004

BY: OLWR

If well telescopes please sketch below and show depths.

Ground Level

A-78

Description of Formations Encountered	From	To
clay	0	40
sand & clay strips	40	65
clay	65	140
seashells & hard clay	140	205
sand	205	220
clay	220	230
sand	230	300
sand & lignite	300	305

If more than one screen, show location of each on sketch

Sketch the property layout and include the following: 1) the well location; 2) any permanent structures on the property that may aid in locating the well; 3) any roads, power lines, or other items that may aid in locating the property and the well; 4) indicate direction.

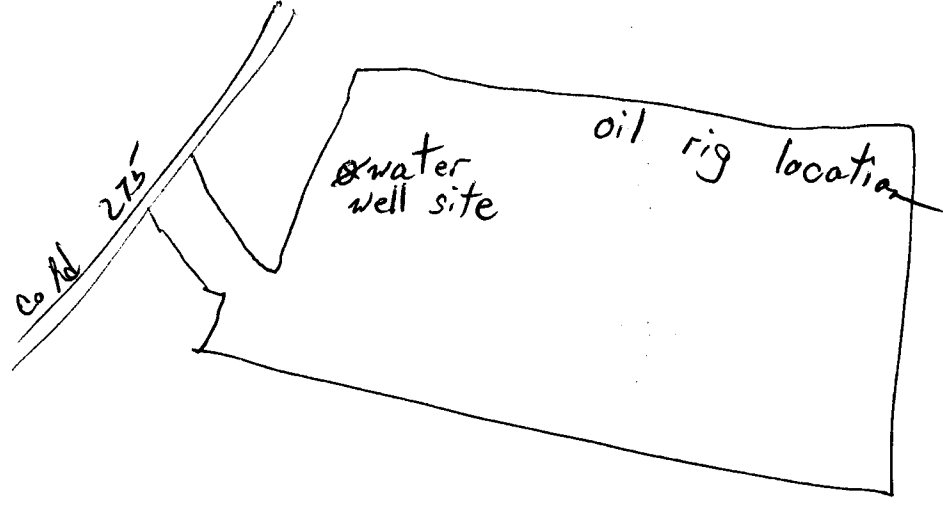

Landowner Name: LL06

John W. Hampton
 Signature of Water Well Contractor

STATE WELL REPORT

Part 2

Pump Installer's Completion Report
Mississippi Department of Environmental Quality
Office of Land and Water Resources
P.O. Box 10631
Jackson, MS 39289-0631
(601)961-5210
(601)354-6938 (fax)

For Office Use Only:

Aquifer: _____

Well #: Q-78

Elevation: _____

County: Clarke
Permit #: _____
Driller: John W. Thompson
Date completed: 10-26-04

This report should be prepared by the pump installer in detail and filed with the Department within 30 days of the installation of pump.

Well Owner Information	Well Location
Owner Name: <u>LLQG</u>	Latitude: <u>21° 57'</u> Longitude: <u>88° 04' 8"</u>
Mailing Address: <u>433 Metairie Rd Suite 600</u> <u>Metairie LA 70005</u>	Method of Lat/Long (circle one): Conventional Survey
City _____ State _____ Zip Code _____	USGS quad, Hand-held GPS, Survey-grade GPS
Telephone No. (____) _____	____ 1/4 ____ 1/4 Sec <u>6</u> Twn <u>1N</u> Rng <u>15E</u>
	Distance _____ Direction _____ Nearest Town _____
	<u>2</u> Miles <u>S</u> of <u>Harmony</u>

Pump Type Circle one	Power Type Circle one
Air Lift _____ Jet _____ <u>Submersible</u>	Diesel Engine _____ Gasoline Engine _____ Natural Gas _____
Bucket _____ Piston _____ Turbine _____	<u>Electric Motor</u> _____ Hand _____ Tractor PTO _____
Centrifugal _____ Rotary _____ Flowing Well _____	Windmill _____ Other (specify) _____
Other (specify): _____	Horse Power Rating of Motor: <u>5</u>
Date Pump Installed: <u>11-1-04</u>	Setting Depth: <u>100</u> feet
Rated Pump Capacity: <u>85</u> Gallons Per Minute	Number of Stages: _____

Pump Test Data	Method of Measuring Water Level Circle one
Date Well Tested: <u>10-26-04</u>	Air Line _____ Electric Measuring Line _____ <u>Steel Tape</u>
Static Water Level (A): <u>49</u> Feet Below Land Surface	Other (specify): _____
Pumping Water Level (B): <u>63</u> Feet Below Land Surface	For flowing well, measured shut in head: _____ feet
Drawdown [(B) - (A)]: <u>14</u> Feet Below Land Surface	Well yielded <u>100</u> GPM with a drawdown of
Test Pumping Rate: <u>100</u> Gallons Per Minute	<u>14</u> feet after <u>4</u> hours of pumping
Duration of Pump Test (minimum 4 hours): <u>4</u> hours	

I HEREBY CERTIFY that the above statements are true to the best of my knowledge.

John W. Thompson 0-0679 John W. Thompson
Print Name of Pump Installer and License No. (if applicable) Signature of Pump Installer

NOV 16 2004
BY: OLWR

Handwritten notes in the upper right quadrant, possibly including a date and some illegible text.

Handwritten notes in the middle right area, appearing as a short phrase or sentence.

Handwritten mark or number on the left side of the page.

Handwritten mark or number on the right side of the page.

Handwritten mark or number on the right side of the page.

Handwritten notes at the bottom of the page, possibly a list or summary.