

Head 36-3 #1 elev 291

### State Well Report Part 1

Mississippi Department of Environmental Quality  
Office of Land and Water Resources  
P.O. Box 10631  
Jackson, MS 39289-0631  
(601)961-5210  
(601)354-6938 (fax)

For Office Use Only:

Aquifer: \_\_\_\_\_  
Well #: 51  
L. S. Elevation: \_\_\_\_\_  
E-log #: \_\_\_\_\_

County: Clarke  
Permit #: \_\_\_\_\_  
Driller: John W Thompson  
Date drilling completed: 5-17-12

State Law requires that this report be prepared by the driller in detail and filed with the Department within 30 days of completion of drilling of the well.

Well Owner Information	Well Location
Owner Name: <u>Will Drill</u>	Latitude: <u>31.58.43</u> " Longitude: <u>88.30.47</u> "
Mailing Address: <u>416 Travis St ste 1200</u> <u>Shreveport LA 71011</u>	Method of Lat/Long (circle one): Conventional Survey, USGS quad, <u>Hand-held GPS</u> , Survey-grade GPS <u>1</u>
City: _____ State: _____ Zip Code: _____	USGS quad, <u>Hand-held GPS</u> , Survey-grade GPS <u>1</u> <u>SE 1/4 SW 1/4 Sec 25</u> Twn <u>2 N</u> Rng <u>17 E</u>
Telephone No. ( ) _____	Distance: <u>12</u> Miles Direction: <u>SE</u> of Nearest Town: <u>Quitman</u>

**Well Data**

Purpose of Well (circle one) Home Industrial Public Supply Irrigation Fish Culture Other: rig supply

Date well drilling started: 5-17-12 Date well drilling completed: 5-17-12

If flowing, method of flow regulation: Valve \_\_\_\_\_ Other (describe) \_\_\_\_\_

Static Water Level: 60 feet above of below (circle one) land surface Date measured: 5-17-12

Method of Measurement (circle one) steel tape electric tape air line other: \_\_\_\_\_

Hole depth: 170 Well depth: 160 Well grouted to a depth of 20 feet

Type of grout (circle one): Cement Bentonite Mix

Casing length: 120 feet Casing diameter: 4 inches Type of casing: PVC

Screen length: 40 feet Screen diameter: 4 inches Type of screen: PVC Slotted

Screen slot size: .02 + .01 inches Setting depth: From 420 120 feet to 460 160 feet

Type of completion (circle all applicable): Gravel packed Underreamed Telescoped Open hole Natural Development

Other (describe): \_\_\_\_\_

Top of lap pipe or reduction in casing: \_\_\_\_\_ feet. If telescoped or more than one screen, describe on back of page

Logs run (circle all applicable): No log run Electric Gamma Ray Density Sonic Neutron Other: \_\_\_\_\_

Name of organization running log(s): \_\_\_\_\_

I certify that the well was drilled, constructed, and completed in accordance with all applicable requirements of the Mississippi Department of Environmental Quality and/or the Mississippi Department of Health regulations and state laws.

John W Thompson 0-679  
Print Name of Water Well Contractor and License No.

John W Thompson  
Signature of Water Well Contractor

RECEIVED  
JUN 06 2012  
BY: OLWR

If well telescopes please sketch below and show depths.

Ground Level

Description of Formations Encountered	From	To
red clay	0	50
grey clay	50	90
sand	90	160
clay	160	170

If more than one screen, show location of each on sketch

Sketch the property layout and include the following: 1) the well location; 2) any permanent structures on the property that may aid in locating the well; 3) any roads, power lines, or other items that may aid in locating the property and the well; 4) indicate direction.

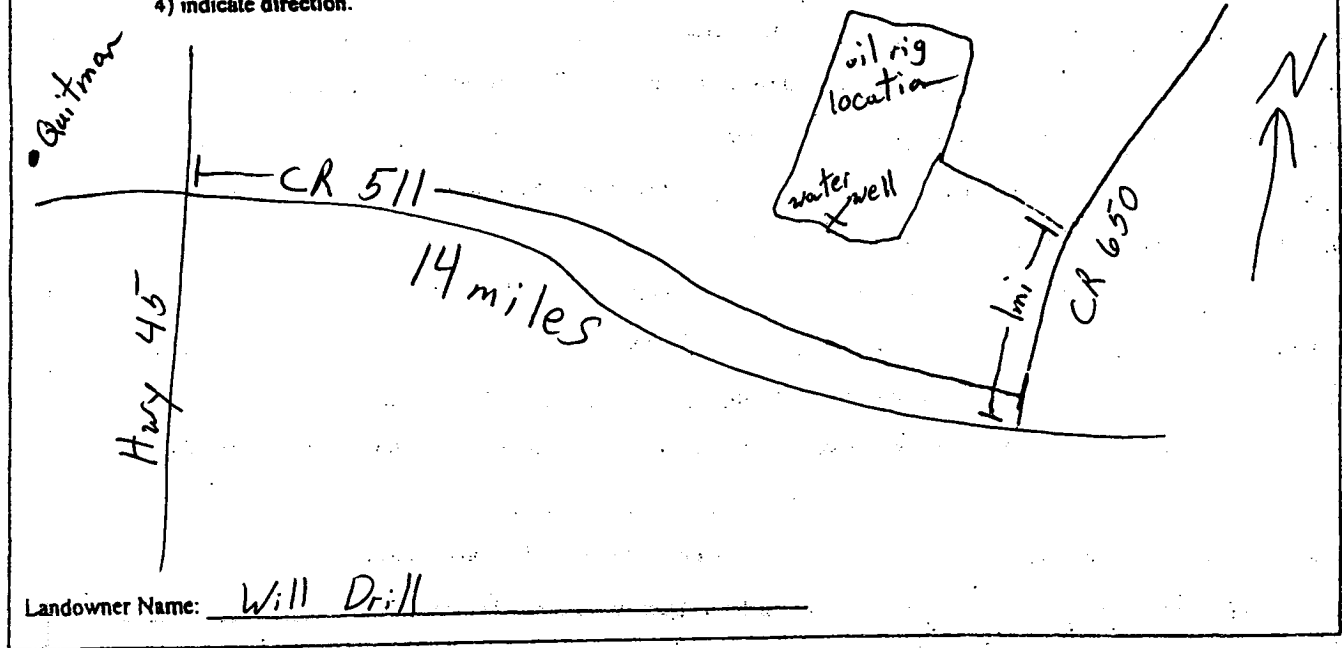

Landowner Name: Will Drill

Signature of Water Well Contractor

# STATE WELL REPORT

## Part 2

**Pump Installer's Completion Report**  
 Mississippi Department of Environmental Quality  
 Office of Land and Water Resources  
 P.O. Box 10631  
 Jackson, MS 39289-0631  
 (601)961-5210  
 (601)354-6938 (fax)

County: Clarke  
 Permit #: \_\_\_\_\_  
 Driller: John W Thompson  
 Date completed: 5-17-12  
*Copy information from Mock on Part 1*

**For Office Use Only:**

Aquifer: \_\_\_\_\_  
 Well #: 051  
 Elevation: \_\_\_\_\_

*This part of the report must be completed by a licensed water well contractor or a licensed pump installer. A copy of Part 1 of the report must be attached and both parts filed with the Department at the above address within 30 days of well completion.*

Well Owner Information	Well Location
Owner Name: <u>Will Drill</u>	Latitude: <u>31°58'43"</u> Longitude: <u>88°30'47"</u>
Mailing Address: <u>416 Travis St ste 1200</u> <u>Shreveport LA 71011</u>	Method of Lat/Long (check one): Conventional Survey _____ USGS quad _____, Hand-held GPS <input checked="" type="checkbox"/> , Survey-grade GPS _____ _____ 1/4 _____ 1/4 Sec <u>25</u> T <u>2N</u> R <u>17E</u>
City _____ State _____ Zip Code _____	Distance _____ Direction _____ Nearest Town _____ <u>12</u> Miles <u>SE</u> of <u>Quitman</u>
Telephone No. ( ) _____	

Pump Type Circle one	Power Type Circle one
Air Lift <input type="checkbox"/> Jet <input type="checkbox"/> <input checked="" type="checkbox"/> <b>Submersible</b>	Diesel Engine <input type="checkbox"/> Gasoline Engine <input type="checkbox"/> Natural Gas <input type="checkbox"/>
Bucket <input type="checkbox"/> Piston <input type="checkbox"/> Turbine <input type="checkbox"/>	Electric Motor <input type="checkbox"/> Hand <input type="checkbox"/> Tractor PTO <input type="checkbox"/>
Centrifugal <input type="checkbox"/> Rotary <input type="checkbox"/> Flowing Well <input type="checkbox"/>	Windmill <input type="checkbox"/> Other (specify): _____
Other (specify): _____	Horse Power Rating of Motor: <u>7.5</u>
Date Pump Installed: <u>5-17-12</u>	Setting Depth: <u>120</u> feet
Rated Pump Capacity: <u>85</u> Gallons Per Minute	Number of Stages: _____

Pump Test Data	Method of Measuring Water Level Circle one
Date Well Tested: <u>5-17-12</u>	<input checked="" type="checkbox"/> <b>Air Line</b> <input type="checkbox"/> Electric Measuring Line <input type="checkbox"/> Steel Tape
Static Water Level (A): <u>60</u> Feet Below Land Surface	Other (specify): _____
Pumping Water Level (B): <u>73</u> Feet Below Land Surface	For flowing well, measured shut in head: _____ feet
Drawdown [(B) - (A)]: <u>13</u> Feet Below Land Surface	Well yielded <u>100</u> GPM with a drawdown of
Test Pumping Rate: <u>100</u> Gallons Per Minute	<u>13</u> feet after <u>4</u> hours of pumping
Duration of Pump Test (minimum 4 hours): <u>4</u> hours	

I HEREBY CERTIFY that the above statements are true to the best of my knowledge.

John W Thompson 0-679      John W Thompson  
 Print Name of Pump Installer and License No. (if applicable)      Signature of Pump Installer

Form: OLRW-2011-01  
**RECEIVED**  
 JUN 06 2012  
 BY: OLWA