

County: Carroll  
 Permit #: GW-45032 ✓  
 Driller: Irrigation Equipment  
 Date drilling completed: 06/17/2014

**STATE WELL REPORT**  
**Part 1**  
**Driller's Log**  
 Mississippi Department of Environmental Quality  
 Office of Land and Water Resources  
 P.O. Box 2309  
 Jackson, MS 39225-2309  
 (601) 961-5210  
 (601) 360-0535 (fax)

**For Office Use Only:**  
 Well #: GEL  
 Aquifer: \_\_\_\_\_  
 E-Log #: \_\_\_\_\_

*State Law requires that this report be prepared by the license holder responsible for the work and filed with the Department at the above address within 30 days of completion of drilling of the well or borehole.*

Well Owner Information <i>(Landowner if borehole is not for a water well)</i>	Well or Borehole Location
Owner Name: <u>Catfish Bayou Land Co.</u>	Latitude: <u>33 27' 11.4 N</u> Longitude: <u>90 07' 59.9 W</u>
Mailing Address: <u>P.O. Box 98</u>	Method of Lat/Long (check one): <input type="checkbox"/> Conventional Survey, <input type="checkbox"/> USGS quad, <input checked="" type="checkbox"/> Hand-held GPS, <input type="checkbox"/> Survey-grade GPS
<u>Sidon</u> Ms <u>38954</u> City State Zip code	<u>SW 1/4 NW 1/4, Sec 6 T 18 N R 2 W</u>
Telephone No. ( ) -	<u>4</u> Miles <u>Southeast</u> of <u>Greenwood</u> <i>(Distance) (Direction) (Nearest Town)</i>

**Well / Borehole Data**

Date drilling started: 06/17/2014 Date drilling completed: 06/17/2014 Hole depth: 104' Hole diameter: 20"

Location of the source of any surface water used for drilling: Surface Water

Method of dosing and volume of Chlorine used in drilling and development: 50 PPM

Logs run (check all applicable):  No log run  Electric  Gamma Ray  Density  Sonic  Neutron  Other: \_\_\_\_\_

Name of organization running log(s): \_\_\_\_\_

Purpose of borehole (check one):  Water Well  Geotechnical/Geological Investigation  Ground Source Heat Pump  
 Seismic Survey  Other (describe) \_\_\_\_\_

*If drilling is not related to water well construction, skip the remainder of this block*

Purpose of Well (check all applicable):  Home  Industrial  Public Supply  Irrigation  Fish Culture  
 Other (describe): \_\_\_\_\_

If a flowing well, method of flow regulation: Valve \_\_\_\_\_ Other (describe) \_\_\_\_\_

Static Water Level: 6' feet [ above or  below] land surface Date measured: 06/18/2014  
*(check one)*

Method of Measurement (check one)  Steel tape  Electric tape  Air line  Other: (describe) \_\_\_\_\_

Well depth: 104' Well grouted to a depth of: 10' feet Type of grout (check one):  Neat Cement  Bentonite  Mix

Casing length: 64' feet Casing diameter: 12" inches Type of casing: PVC

Screen length: 40' feet Screen diameter: 12" inches Type of screen: PVC

Screen slot size: .050 inches Setting depth: From 65' feet to 104' feet

Type of completion (check all applicable):  Gravel packed  Underreamed  Open hole  Natural Development  
 Other (describe): \_\_\_\_\_

Top of lap pipe or reduction in casing: \_\_\_\_\_ Feet

*If telescoped or more than one screen, describe on next page*

RECEIVED

County: Carroll  
 Permit #: GW-45032

**For Office Use Only:**  
 Well #: 686

*The sketch below only required for water wells*  
*If well telescopes, show depths on sketch.*

*Description of formations encountered must be provided for all wells and boreholes, unless specifically exempted by regulations*

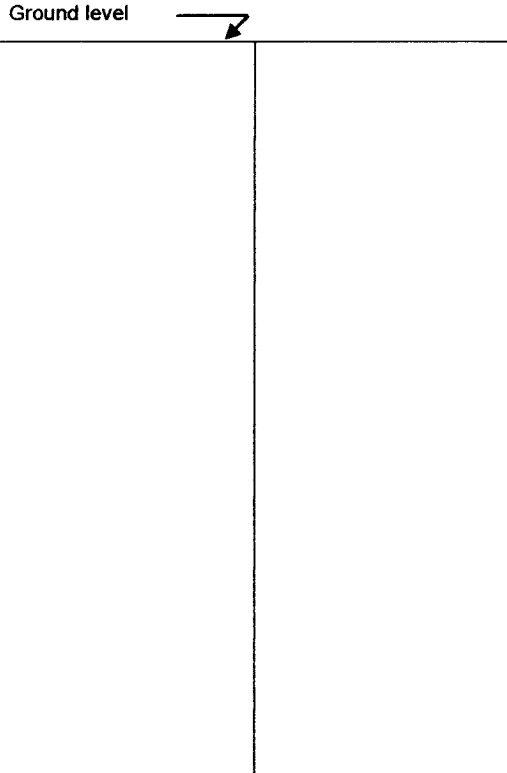

Description of Formations Encountered	From (depth)	To (depth)
<b>Clay</b>	Ground level	<b>14</b>
<b>Fine Sand</b>	<b>15</b>	<b>28</b>
<b>Fine Sand &amp; Gravel</b>	<b>29</b>	<b>40</b>
<b>Medium Sand &amp; Gravel</b>	<b>41</b>	<b>100</b>
<b>Clay</b>	<b>101</b>	<b>104</b>

If more than one screen, show location of each on sketch

Sketch the property layout and include the following:

- 1) the well location
- 2) any permanent structures on the property that may aid in locating the well
- 3) any roads, power lines, or other items that may aid in locating the property and the well
- 4) a north arrow

RECEIVED  
AUG 21 2014  
BY OLWR

Landowner Name: Catfish Bayou Land Co.

Form: OLWR-SWR-1A (04/08)

I HEREBY CERTIFY that the well/borehole was drilled, constructed, and completed in accordance with all applicable requirements of the Mississippi Department of Environmental Quality and the Mississippi Department of Health regulations, if applicable, and state laws.

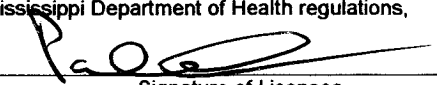
**Patrick Chism**                      **0695**                      **08/18/2014**                      

Print Name of Responsible Licensee and License No.                      Date                      Signature of Licensee

Form: OLWR-SWR-1A (4/13)

County: Carroll  
 Permit #: GW-45032  
 Driller: Irrigation Equipment  
 Date drilling completed: 06/17/2014  
*Copy information from block on Part 1*

**STATE WELL REPORT**  
**Part 2**  
**Pump Installer's Completion Report**  
 Mississippi Department of Environmental Quality  
 Office of Land and Water Resources  
 P.O. Box 2309  
 Jackson, MS 39225-2309  
 (601) 961-5210  
 (601) 360-0535 (fax)

**For Office Use Only:**

Well #: 686  
 Aquifer: \_\_\_\_\_

*This part of the report must be completed by a licensed water well contractor or a licensed pump installer. A copy of Part 1 of the report must be attached and both parts filed with the Department at the above address within 30 days of well completion.*

Well Owner Information	Well Location
Owner Name: <u>Catfish Bayou Land Co.</u>	Latitude: <u>33 27' 11.4 N</u> Longitude: <u>90 07' 59.9 W</u>
Mailing Address: <u>P.O. Box 98</u>	Method of Lat/Long (check one): <input type="checkbox"/> Conventional Survey, <input type="checkbox"/> USGS quad, <input checked="" type="checkbox"/> Hand-held GPS, <input type="checkbox"/> Survey-grade GPS
<u>Sidon</u> Ms <u>38954</u> City State Zip code	<b>SW ¼ NW ¼, Sec 6 T 18 N R 2 W</b>
Telephone No. ( ) -	<u>4</u> Miles <u>Southeast</u> of <u>Greenwood</u> (Distance) (Direction) (Nearest Town)

**Pump Type (check one)**

Submersible  Turbine  Air Lift  Centrifugal  Flowing Well  Jet  Piston  Rotary  Other (describe): \_\_\_\_\_

Date Pump Installed 06/18/2014 Rated Pump Capacity: 1100+/- Gallons Per Minute  
 Is This Pump (check one):  New  Repaired  Replacement

**Power Type (check one)**

Electric  Diesel  Gasoline  Natural Gas  Tractor PTO  Windmill  Other (describe): \_\_\_\_\_

Horse Power Rating of Motor: 40 Setting Depth: 70' feet Number of Stages: 2

**Pump Test Data for Non Flowing Well**

Date Well Tested: \_\_\_\_\_ Duration of Pump Test (minimum 4 hours): \_\_\_\_\_ Hours  
 Static Water Level (A): \_\_\_\_\_ Feet Below Land Surface Pumping Water Level (B): \_\_\_\_\_ Feet Below Land Surface  
 Drawdown [(B) - (A)]: \_\_\_\_\_ Feet Below Land Surface Test Pumping Rate: \_\_\_\_\_ Gallons Per Minute  
 Method of measurement (check one):  Steel tape  Electric tape  Air line  Other (describe): \_\_\_\_\_

**Pump Test Data for Flowing Well**

Measured shut in head: \_\_\_\_\_ Feet  
 Well yielded \_\_\_\_\_ GPM with a drawdown of \_\_\_\_\_ feet after \_\_\_\_\_ hours of pumping

**Meter Installation**

Meter Manufacturer: \_\_\_\_\_ Meter Serial Number: \_\_\_\_\_  
 Meter Model Number/Name: \_\_\_\_\_ Type of Meter: \_\_\_\_\_  
 Totalizer Register Unit and Multiplier Factor (AF x .001, gal x 1000, etc): \_\_\_\_\_  
 Installation Date: \_\_\_\_\_ Meter installed by: \_\_\_\_\_  
 Is This Meter (check one):  New  Repaired  Replacement

*Important: By submitting the above information you are certifying that this meter was installed to manufacturer standards.  
 For agricultural wells, a list of approved meters is on the MDEQ website.*

I HEREBY CERTIFY that the above statements are true to the best of my knowledge.

Patrick Chism 0695 08/18/2014  
 Print Name of Pump Installer and License No. (if applicable) Date Signature of Pump Installer  
 Form: OLWR-SWR-1B (4/13)

G86

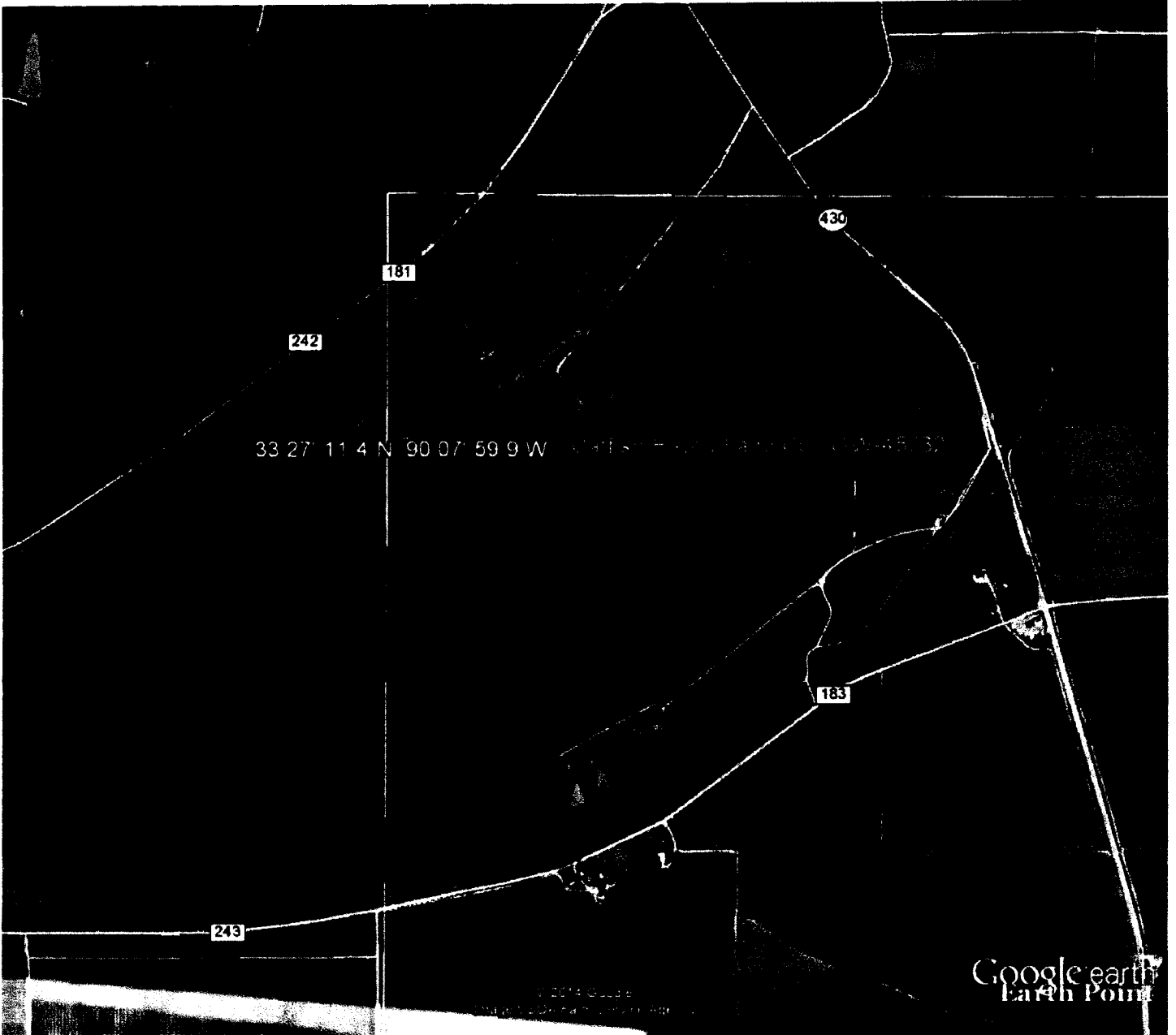

Google earth

feet 4000  
km 1



RECEIVED  
AUG 21 2014  
BY [illegible]