

County: Carroll
 Permit #: GW-49574
 Driller: Irrigation Equipment, Inc.
 Date drilling completed: 7-1-16

STATE WELL REPORT

Part 1

Driller's Log

Mississippi Department of Environmental Quality
 Office of Land and Water Resources
 P.O. Box 2309
 Jackson, MS 39225-2309
 (601) 961-5210
 (601) 360-0535 (fax)

For Office Use Only:
 Well #: A99
 Aquifer: _____
 E-Log #: _____

State Law requires that this report be prepared by the license holder responsible for the work and filed with the Department at the above address within 30 days of completion of drilling of the well or borehole.

Well Owner Information <i>(Landowner if borehole is not for a water well)</i>			Well or Borehole Location		
Owner Name: <u>Earl and James A White, Jr.</u>			Latitude: <u>33° 34' 31.7"</u> Longitude: <u>090° 03' 47.2"</u>		
Mailing Address: <u>1644 CR 183</u>			Method of Lat/Long (check one): <input type="checkbox"/> Conventional Survey,		
			<input type="checkbox"/> USGS quad, <input checked="" type="checkbox"/> Hand-held GPS, <input type="checkbox"/> Survey-grade GPS		
<u>Greenwood</u> City	<u>MS</u> State	<u>38930</u> Zip code	<u>SE 1/4 SW 1/4, Sec 23 T 20N R 2E</u>		
Telephone No. () -			<u>SW</u> Miles	<u>SW</u> (Direction)	of <u>Teoc</u> (Nearest Town)

Well / Borehole Data

Date drilling started: 7-1-16 Date drilling completed: 7-1-16 Hole depth: 87' Hole diameter: 24"

Location of the source of any surface water used for drilling: Surface Water

Method of dosing and volume of Chlorine used in drilling and development: 50 PPM

Logs run (check all applicable): No log run Electric Gamma Ray Density Sonic Neutron Other: _____

Name of organization running log(s): _____

Purpose of borehole (check one): Water Well Geotechnical/Geological Investigation Ground Source Heat Pump
 Seismic Survey Other (describe) _____

If drilling is not related to water well construction, skip the remainder of this block

Purpose of Well (check all applicable): Home Industrial Public Supply Irrigation Fish Culture
 Other (describe): _____

If a flowing well, method of flow regulation: Valve _____ Other (describe) _____

Static Water Level: 17 feet [above or below] land surface Date measured: 7-12-16
 (check one)

Method of Measurement (check one) Steel tape Electric tape Air line Other: (describe) _____

Well depth: 87' Well grouted to a depth of: 10 feet Type of grout (check one): Neat Cement Bentonite Mix

Casing length: 67 feet Casing diameter: 16 inches Type of casing: PVC

Screen length: 20 feet Screen diameter: 16 inches Type of screen: PVC

Screen slot size: .050 inches Setting depth: From 68 feet to 87 feet

Type of completion (check all applicable): Gravel packed Underreamed Open hole Natural Development
 Other (describe): _____

Top of lap pipe or reduction in casing: _____ Feet

If telescoped or more than one screen, describe on next page

RECEIVED

DEC 12 2016
 Form: OLWR-SWR-1A (4/13)

County: Carroll
 Permit #: GW-49574
 Driller: Irrigation Equipment, Inc.
 Date drilling completed: 7-1-16
Copy information from block on Part 1

STATE WELL REPORT
Part 2
Pump Installer's Completion Report
 Mississippi Department of Environmental Quality
 Office of Land and Water Resources
 P.O. Box 2309
 Jackson, MS 39225-2309
 (601) 961-5210
 (601) 360-0535 (fax)

For Office Use Only:

Well #: A99
 Aquifer: _____

This part of the report must be completed by a licensed water well contractor or a licensed pump installer. A copy of Part 1 of the report must be attached and both parts filed with the Department at the above address within 30 days of well completion.

Well Owner Information	Well Location
Owner Name: <u>Earl and James A White, Jr</u>	Latitude: <u>33° 34' 31.7"</u> Longitude: <u>090° 03' 47.2"</u>
Mailing Address: <u>1644 CR 183</u>	Method of Lat/Long (check one): <input type="checkbox"/> Conventional Survey,
<u>Greenwood</u> <u>MS</u> <u>38930</u>	<input type="checkbox"/> USGS quad, <input checked="" type="checkbox"/> Hand-held GPS, <input type="checkbox"/> Survey-grade GPS
City State Zip code	<u>SE 1/4 SW 1/4, Sec 23 T 20N R 2E</u>
Telephone No. <u>() -</u>	<u>SW</u> of <u>Teoc</u>
	(Distance) (Direction) (Nearest Town)

Pump Type (check one)

Submersible Turbine Air Lift Centrifugal Flowing Well Jet Piston Rotary Other (describe): _____

Date Pump Installed 7-12-16 Rated Pump Capacity: _____ Gallons Per Minute

Is This Pump (check one): New Repaired Replacement

Power Type (check one)

Electric Diesel Gasoline Natural Gas Tractor PTO Windmill Other (describe): _____

Horse Power Rating of Motor: 40 Setting Depth: 80 feet Number of Stages: 1

Pump Test Data for Non Flowing Well

Date Well Tested: _____ Duration of Pump Test (minimum 4 hours): _____ Hours

Static Water Level (A): _____ Feet Below Land Surface Pumping Water Level (B): _____ Feet Below Land Surface

Drawdown [(B) - (A)]: _____ Feet Below Land Surface Test Pumping Rate: _____ Gallons Per Minute

Method of measurement (check one): Steel tape Electric tape Air line Other (describe): _____

Pump Test Data for Flowing Well

Measured shut in head: _____ Feet

Well yielded _____ GPM with a drawdown of _____ feet after _____ hours of pumping

Meter Installation

Meter Manufacturer: _____ Meter Serial Number: _____

Meter Model Number/Name: _____ Type of Meter: _____

Totalizer Register Unit and Multiplier Factor (AF x .001, gal x 1000, etc): _____

Installation Date: _____ Meter installed by: _____

Is This Meter (check one): New Repaired Replacement

Important: By submitting the above information you are certifying that this meter was installed to manufacturer standards. For agricultural wells, a list of approved meters is on the MDEQ website.

I HEREBY CERTIFY that the above statements are true to the best of my knowledge.

0695 12-6-16
 Print Name of Pump Installer and License No. (if applicable) Date

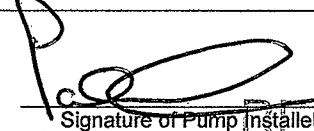
 Signature of Pump Installer
 Form: OLWR-SWR-1B (4/13)

RECEIVED
 Form: OLWR-SWR-1B (4/13)

DEC 12 2016
 BY OLWR

A99

STATE OF MISSISSIPPI
Department of Environmental Quality
Office of Land and Water Resources
P. O. Box 2309
Jackson, Mississippi 39225

PERMIT

TO DIVERT OR WITHDRAW FOR BENEFICIAL USE THE PUBLIC WATERS

This permit is issued to the landowner named below in accordance with the provisions of the Mississippi Water Laws, Mississippi Code Sections 51-3-1, et seq. (1972, as amended), and the regulations and standards as promulgated thereunder. Whether or not specifically named in this permit or in the applications for this permit, anyone using water from the diversion/withdrawal point described below shall do so in compliance with the provisions of this permit. Neither this permit, nor any authority conferred hereby, may be sold, conveyed, encumbered, assigned, or otherwise aliened, for any period of time or under any conditions whatsoever. This permit may not be modified, transferred or revoked without prior action by the Permit Board. Any attempts to modify, transfer or revoke this permit, or to take any other action on this permit, shall be invalid and unenforceable and may result in immediate revocation or suspension of this permit. The holder of this permit shall at all times be responsible for adherence to the terms and conditions of this permit. No agreement between the permit holder and any other party shall affect the obligations and liabilities of the permit holder. Water use under this permit is allowed only when the streamflow, lake level elevation, or static groundwater level (whichever, if any, is applicable) is above the established minimum, pursuant to Mississippi Code Section 51-3-7. Authorization is hereby granted to divert/withdraw water for the beneficial use designated herein, and for no other purpose, subject to the following terms, conditions, and limitations:

Permit Number: MS-GW-49574

Landowner Name: WHITE, EARL AND JAMES A, JR

Landowner Address: 1644 COUNTY ROAD 183
GREENWOOD MS 38930

Source Of Water: MISSISSIPPI RIVER VALLEY ALLUVIAL AQUIFER

Beneficial Use: IRRIGATION

Diversion/Withdrawal Location: SE 1/4 of the SW 1/4 **Section:** 23 **Township:** 20N **Range:** 02E

County: CARROLL

Quad: BROWNING

Maximum Volume: 213 Acre-Feet/Year *equivalent to* 1901 Million Gallons/Day

Maximum Rate: 900 Gallons/Minute

Applicant Name: DELTA'S EDGE PLANTING CO LLC

Applicant Address: 1644 COUNTY ROAD 183
GREENWOOD MS 38930

Date Permit Issued: 10/12/2016

Date Permit Expires: 10/12/2021

Date Permit Modified:

Date Permit Re-issued:
This permit shall be deemed null and void if construction has not begun within one (1) year of permit issue date

SPECIAL TERMS AND CONDITIONS: SEE ATTACHMENT 1, WHICH IS HEREBY DECLARED TO BE PART OF THIS PERMIT.

SPECIAL TERMS AND CONDITIONS 2:

 RECEIVED
DEC 12 2016
Gary C. Rikard, Executive Director
Mississippi Department of Environmental Quality
BY OLWR

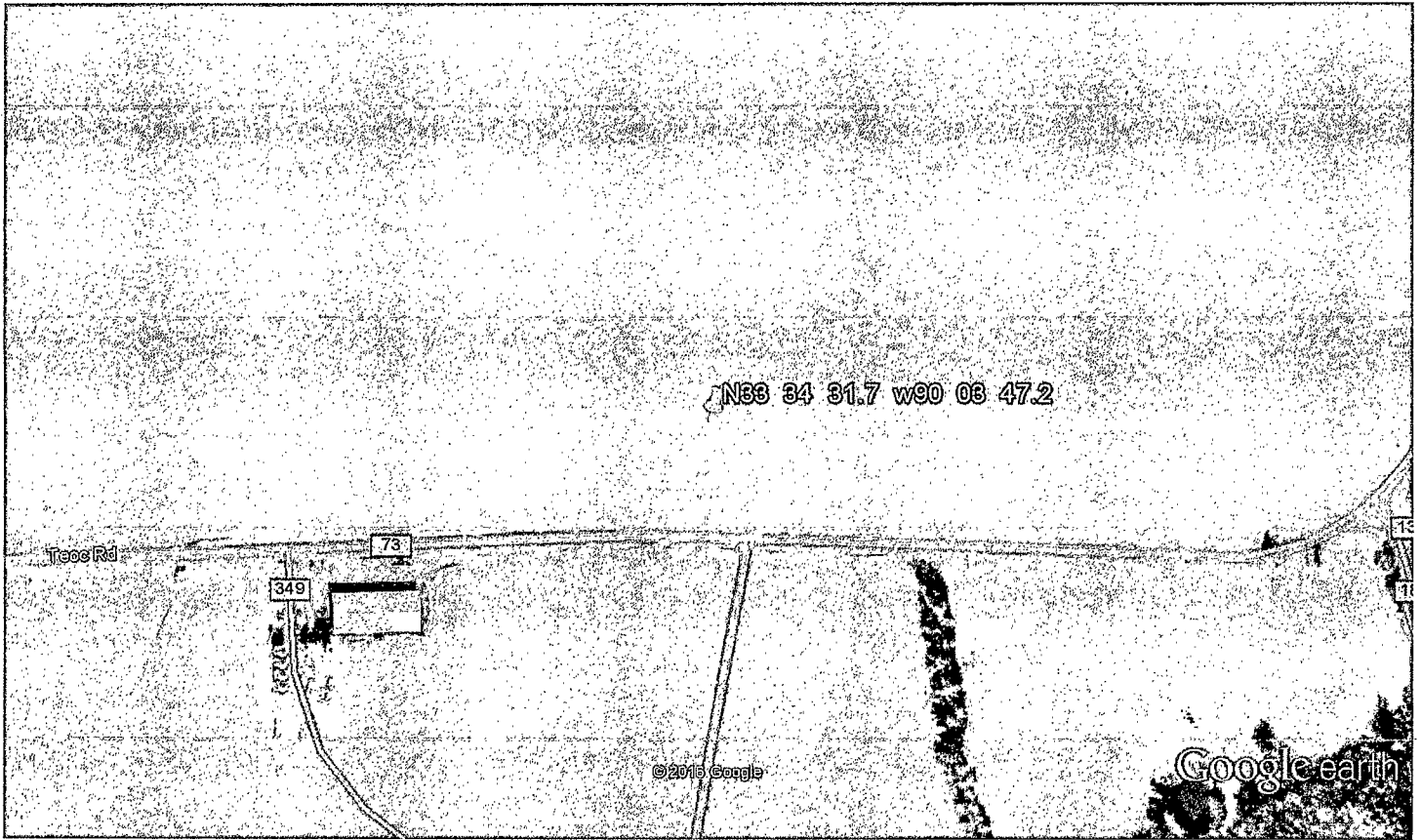

Google earth



RECEIVED
DEC 12 2016
BY OLWR