

124

County: Bolivar  
 Permit #: GW-51379  
 Driller: Chicot Irrigation, Inc.  
 Date drilling completed: 4-23-21

# STATE WELL REPORT

## Part 1

### Driller's Log

Mississippi Department of Environmental Quality  
 Office of Land and Water Resources  
 P.O. Box 2309  
 Jackson, MS 39225-2309  
 (601) 961-5210  
 (601) 360-0535 (fax)

**For Office Use Only:**  
 Well #: T 255  
 Aquifer: \_\_\_\_\_  
 E-Log #: \_\_\_\_\_

*State Law requires that this report be prepared by the license holder responsible for the work and filed with the Department at the above address within 30 days of completion of drilling of the well or borehole.*

Well Owner Information <i>(Landowner if borehole is not for a water well)</i>	Well or Borehole Location
Owner Name: <u>Mary Ellen Watkins</u>	Latitude: <u>33° 31' 59.4"N</u> Longitude: <u>90° 47' 33.2"W</u>
Mailing Address: <u>44 Thrasher Street</u>	Method of Lat/Long (check one): <input type="checkbox"/> Conventional Survey, <input type="checkbox"/> USGS quad, <input checked="" type="checkbox"/> Hand-held GPS, <input type="checkbox"/> Survey-grade GPS
<u>New Orleans</u> <u>LA</u> <u>70124</u> City                                      State                      Zip code	<u>SW ¼ SW ¼, Sec 35 T 20N R 6W</u>
Telephone No. (    ) -    -	<u>        </u> Miles <u>South</u> of <u>Shaw</u> <i>(Distance)</i> <i>(Direction)</i> <i>(Nearest Town)</i>

**Well / Borehole Data**

Date drilling started: 4-23-21      Date drilling completed: 4-23-21      Hole depth: 127'      Hole diameter: 24"

Location of the source of any surface water used for drilling: Surface Water

Method of dosing and volume of Chlorine used in drilling and development: 50 PPM

Logs run (check all applicable):  No log run  Electric  Gamma Ray  Density  Sonic  Neutron  Other: \_\_\_\_\_

Name of organization running log(s): \_\_\_\_\_

Purpose of borehole (check one):  Water Well     Geotechnical/Geological Investigation     Ground Source Heat Pump  
 Seismic Survey     Other (*describe*) \_\_\_\_\_

***If drilling is not related to water well construction, skip the remainder of this block***

Purpose of Well (*check all applicable*):  Home  Industrial  Public Supply  Irrigation  Fish Culture  
 Other (*describe*): \_\_\_\_\_

If a flowing well, method of flow regulation: Valve \_\_\_\_\_ Other (*describe*) \_\_\_\_\_

Static Water Level: \_\_\_\_\_ feet [ above or  below] land surface      Date measured: \_\_\_\_\_  
*(check one)*

Method of Measurement (check one)  Steel tape  Electric tape  Air line  Other: (*describe*) \_\_\_\_\_

Well depth: 127'      Well grouted to a depth of: 10 feet      Type of grout (*check one*):  Neat Cement  Bentonite  Mix

Casing length: 87 feet      Casing diameter: 16 inches      Type of casing: PVC

Screen length: 40 feet      Screen diameter: 16 inches      Type of screen: PVC

Screen slot size: .050 inches      Setting depth: From 88 feet to 127 feet

Type of completion (check all applicable):  Gravel packed  Underreamed  Open hole  Natural Development  
 Other (*describe*): \_\_\_\_\_

Top of lap pipe or reduction in casing: \_\_\_\_\_ Feet

***If telescoped or more than one screen, describe on next page***

RECEIVED  
 JUN 14 2021  
 BY OLWR



County: **Bolivar**  
Permit #: **GW-51379**

**For Office Use Only:**  
Well #: \_\_\_\_\_

*The sketch below only required for water wells  
If well telescopes, show depths on sketch.*

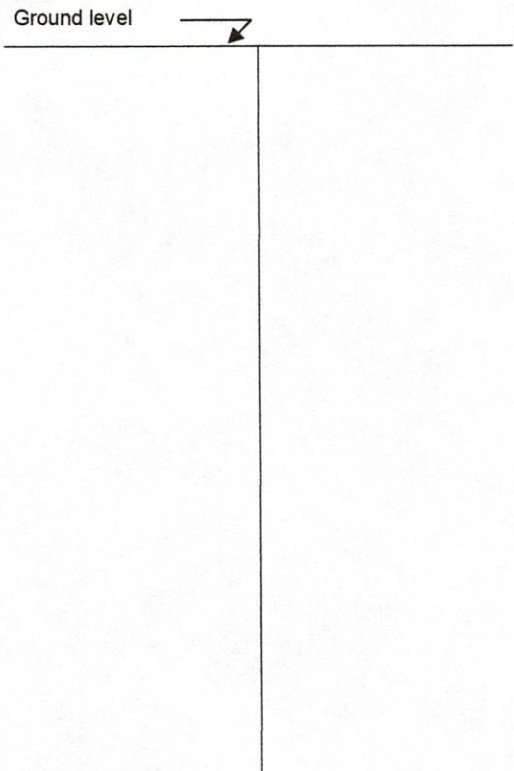

*Description of formations encountered must be provided for all wells  
and boreholes, unless specifically exempted by regulations*

Description of Formations Encountered	From (depth)	To (depth)
<b>Clay</b>	Ground level	<b>20</b>
<b>Fine Sand</b>	<b>21</b>	<b>43</b>
<b>Fine Sand &amp; Gravel</b>	<b>44</b>	<b>75</b>
<b>Med. Sand &amp; Gravel</b>	<b>76</b>	<b>127</b>

If more than one screen, show location of each on sketch

RECEIVED  
JUN 14 2021  
BY OLWR

Sketch the property layout and include the following:

- 1) the well location
- 2) any permanent structures on the property that may aid in locating the well
- 3) any roads, power lines, or other items that may aid in locating the property and the well
- 4) a north arrow

Landowner Name: \_\_\_\_\_

I HEREBY CERTIFY that the well/borehole was drilled, constructed, and completed in accordance with all applicable requirements of the Mississippi Department of Environmental Quality and the Mississippi Department of Health regulations, if applicable, and state laws.

<b>John Newcome - 0773</b> Print Name of Responsible Licensee and License No.	<b>5-11-21</b> Date	<i>[Signature]</i> Signature of Licensee
--	------------------------	---

Form: OLWR-SWR-1A (04/08)  
Form: OLWR-SWR-1A (4/13)



County: Bolivar  
 Permit #: GW-51379  
 Driller: Chicot Irrigation, Inc.  
 Date drilling completed: 4-23-21  
Copy information from block on Part 1

**STATE WELL REPORT**  
**Part 2**  
**Pump Installer's Completion Report**  
 Mississippi Department of Environmental Quality  
 Office of Land and Water Resources  
 P.O. Box 2309  
 Jackson, MS 39225-2309  
 (601) 961-5210  
 (601) 360-0535 (fax)

**For Office Use Only:**

Well #: T 255  
 Aquifer: \_\_\_\_\_

*This part of the report must be completed by a licensed water well contractor or a licensed pump installer. A copy of Part 1 of the report must be attached and both parts filed with the Department at the above address within 30 days of well completion.*

Well Owner Information	Well Location
Owner Name: <u>Mary Ellen Watkins</u>	Latitude: <u>33° 31' 59.4"N</u> Longitude: <u>90° 47' 33.2"W</u>
Mailing Address: <u>44 Thrasher Street</u>	Method of Lat/Long (check one): <input type="checkbox"/> Conventional Survey, <input type="checkbox"/> USGS quad, <input checked="" type="checkbox"/> Hand-held GPS, <input type="checkbox"/> Survey-grade GPS
<u>New Orleans</u> <u>LA</u> <u>70124</u> City State Zip code	<u>SW ¼ SW ¼, Sec 35 T 20N R 6W</u>
Telephone No. <u>( ) -</u>	<u>South</u> of <u>Shaw</u> (Distance) (Direction) (Nearest Town)

**Pump Type (check one)**

Submersible  Turbine  Air Lift  Centrifugal  Flowing Well  Jet  Piston  Rotary  Other (describe): \_\_\_\_\_

Date Pump Installed \_\_\_\_\_ Rated Pump Capacity: 2100 +/- Gallons Per Minute

Is This Pump (check one):  New  Repaired  Replacement

**Power Type (check one)**

Electric  Diesel  Gasoline  Natural Gas  Tractor PTO  Windmill  Other (describe): \_\_\_\_\_

Horse Power Rating of Motor: 60 Setting Depth: 70 feet Number of Stages: 1

**Pump Test Data for Non Flowing Well**

Date Well Tested: \_\_\_\_\_ Duration of Pump Test (minimum 4 hours): \_\_\_\_\_ Hours

Static Water Level (A): \_\_\_\_\_ Feet Below Land Surface Pumping Water Level (B): \_\_\_\_\_ Feet Below Land Surface

Drawdown [(B) - (A)]: \_\_\_\_\_ Feet Below Land Surface Test Pumping Rate: \_\_\_\_\_ Gallons Per Minute

Method of measurement (check one):  Steel tape  Electric tape  Air line  Other (describe): \_\_\_\_\_

**Pump Test Data for Flowing Well**

Measured shut in head: \_\_\_\_\_ Feet

Well yielded \_\_\_\_\_ GPM with a drawdown of \_\_\_\_\_ feet after \_\_\_\_\_ hours of pumping

**Meter Installation**

Meter Manufacturer: \_\_\_\_\_ Meter Serial Number: \_\_\_\_\_

Meter Model Number/Name: \_\_\_\_\_ Type of Meter: \_\_\_\_\_

Totalizer Register Unit and Multiplier Factor (AF x .001, gal x 1000, etc): \_\_\_\_\_

Installation Date: \_\_\_\_\_ Meter installed by: \_\_\_\_\_

Is This Meter (check one):  New  Repaired  Replacement

*Important: By submitting the above information you are certifying that this meter was installed to manufacturer standards.  
For agricultural wells, a list of approved meters is on the MDEQ website.*

I HEREBY CERTIFY that the above statements are true to the best of my knowledge.

John Newcome - 0773 5-11-21  
 Print Name of Pump Installer and License No. (if applicable) Date

[Signature]  
 Signature of Pump Installer

Form: OLWR-SWR-1B (4/13)

# STATE OF MISSISSIPPI



Department of Environmental Quality  
Office of Land and Water Resources

## CERTIFICATE OF PERMIT COVERAGE

*Under Mississippi's GROUNDWATER WITHDRAWAL GENERAL PERMIT  
TO WITHDRAW groundwater from the Mississippi River Valley Alluvial Aquifer  
FOR the beneficial use of Irrigation, Aquaculture, or Enhancement of Wildlife Habitat*

**General Permit:** MRVA-002  
**Certificate Number:** MS-GW-51379  
**Total Permitted Acreage:** 80

**Landowner Name:** WATKINS, MARY ELLEN  
**Landowner Address:** 44 THRASHER STREET  
NEW ORLEANS, LA 70124

**Source of Water:** MISSISSIPPI RIVER VALLEY ALLUVIAL AQUIFER  
**Beneficial Use(s):** IRRIGATION

**Diversion/Withdrawal Location:** SW 1/4 of the SW 1/4    **Section:** 35    **Township:** 20N    **Range:** 06W

**County:** BOLIVAR    **Quadrangle:** SHAW MS

**Permitted Acreage:**    **Irrigation:** 80    **Fish Culture:** 0    **Wildlife Management:** 0

**Maximum Volume:** See Special Terms And Conditions (attachment I)

**Applicant Name:** VANLANDINGHAM, GEORGE  
**Applicant Address:** 45 BROWN ROAD  
LELAND, MS 38756

**Date Original Permit Issued:** 11/12/2020

**Date Coverage Expires:** 04/28/2026

**Date Coverage Modified:**

**Date Coverage Granted:** 04/28/2021

RECEIVED  
JUN 14 2021  
BY OLWR

### SPECIAL TERMS AND CONDITIONS 1:

See Attachment I which is hereby declared part of this permit.

Kay Whittington, Director  
Office of Land and Water Resources



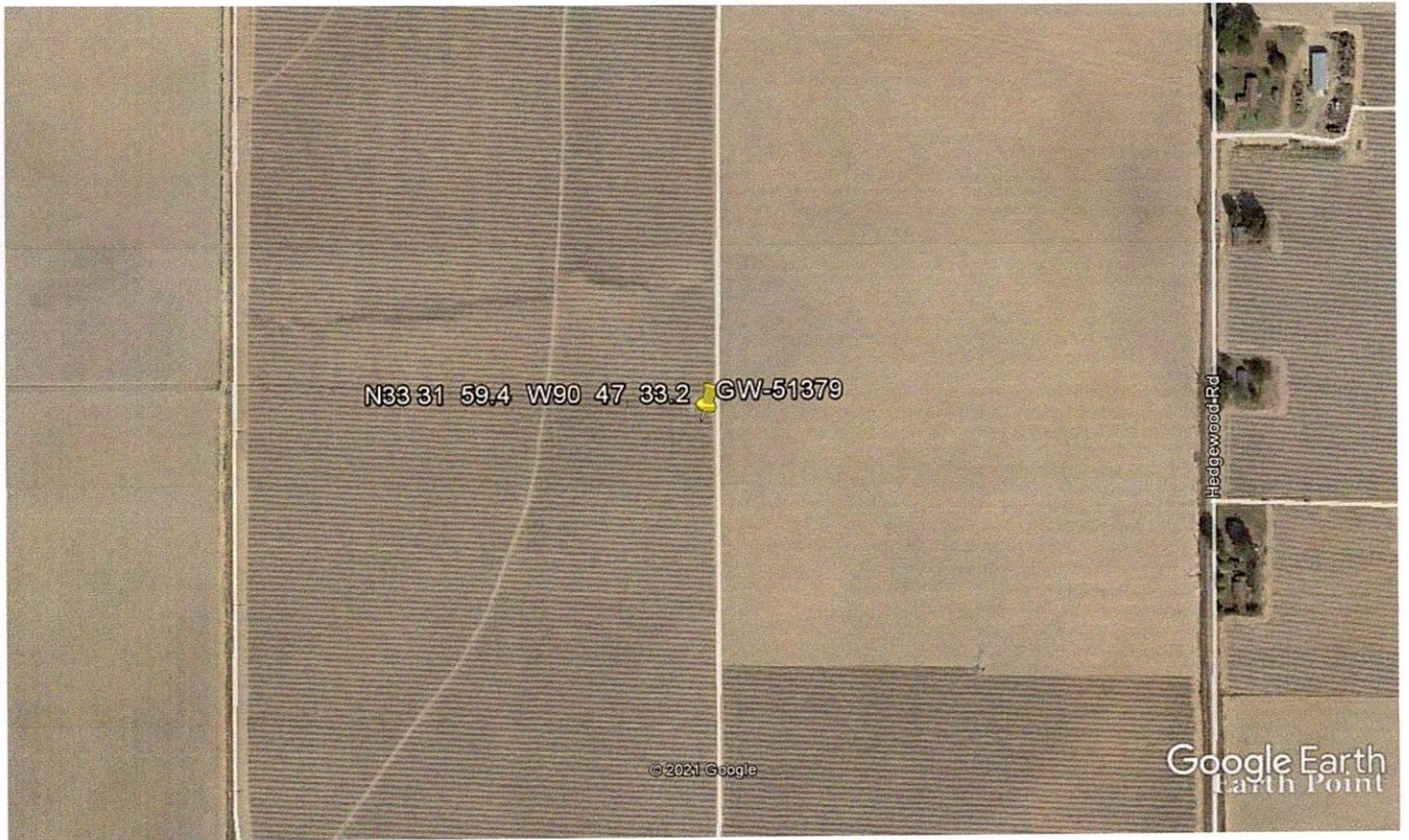

Google Earth

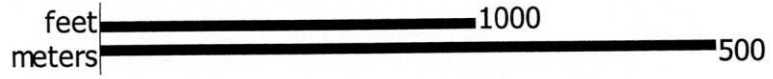

RECEIVED  
JUN 14 2021  
BY OLWR