

# STATE WELL REPORT

## Part 1

### Driller's Log

Mississippi Department of Environmental Quality  
 Office of Land and Water Resources  
 P.O. Box 2309  
 Jackson, MS 39225-2309  
 (601)961-5210  
 (601)360-0535 (fax)

### For Office Use Only:

Well #: P232  
 Aquifer: \_\_\_\_\_  
 E-Log #: \_\_\_\_\_

County: Bolivar  
 Permit #: GW-50372 ✓  
 Driller: Jonathan Gordon  
 Date drilling completed: 4-12-18

*State Law requires that this report be prepared by the license holder responsible for the work and filed with the Department at the above address within 30 days of completion of drilling of the well or borehole.*

Well Owner Information <i>(Landowner if borehole is not for a water well)</i>	Well or Borehole Location
Owner Name: <u>Gamma Delta Lands, LLC</u>	Latitude: <u>33° 37' 25.48"</u> Longitude: <u>90° 50' 23.42"</u>
Mailing Address: <u>107 Court St</u>	Method of Lat/Long (check one): Conventional Survey _____
<u>Clarksdale</u> <u>MS</u> <u>38614</u>	USGS quad _____, Hand-held GPS <input checked="" type="checkbox"/> , Survey-grade GPS _____
City State Zip Code	<u>SW 1/4 NE 1/4</u> , Sec <u>32</u> T <u>21N</u> R <u>06W</u>
Telephone No. ( ) _____	<u>4</u> Miles <u>SE</u> of <u>Shaw</u>
	(Distance) (Direction) (Nearest Town)

**Well / Borehole Data**

Date drilling started: 4-12-18 Date drilling completed: 4-12-18 Hole depth: 125' Hole diameter: 26"

Location of the source of any surface water used for drilling: Existing Well

Method of dosing and volume of Chlorine used in drilling and development: \_\_\_\_\_

Logs run (circle all applicable): No log run Electric Gamma Ray Density Sonic Neutron Other: \_\_\_\_\_

Name of organization running log(s): \_\_\_\_\_

Purpose of borehole (circle one) Water Well Geotechnical/Geological Investigation Ground Source Heat Pump  
 Seismic Survey Other (describe) \_\_\_\_\_

*If drilling is not related to water well construction, skip the remainder of this block*

Purpose of Well (circle all applicable): Home Industrial Public Supply Irrigation Fish Culture

Other (describe): \_\_\_\_\_

If a flowing well, method of flow regulation: Valve \_\_\_\_\_ Other (describe) \_\_\_\_\_

Static Water Level: 40' feet [above or (below) land surface Date measured: 4-13-18  
 (circle one)

Method of measurement (circle one): Steel tape Electric tape Air line Other (describe): \_\_\_\_\_

Well depth: 125' Well grouted to a depth of: 10 feet Type of grout (circle one): Neat Cement Bentonite Mix

Casing length: 75 feet Casing diameter: 16 inches Type of casing: PVC

Screen length: 50 feet Screen diameter: 16 inches Type of screen: PVC

Screen slot size: 050 inches Setting depth: From 75 feet to 125 feet

Type of completion (circle all applicable): Gravel packed Underreamed Open hole Natural Development

Other (describe): \_\_\_\_\_

Top of lap pipe or reduction in casing: N/A feet

*If telescoped or more than one screen, describe on next page*

RECEIVED  
 MAY 01 2018  
 BY OLWR

County: Bolivar  
 Permit #: GW-50372

For Office Use Only:  
 Well #: P232

The sketch below only required for water wells

If well telescopes, show depths on sketch.

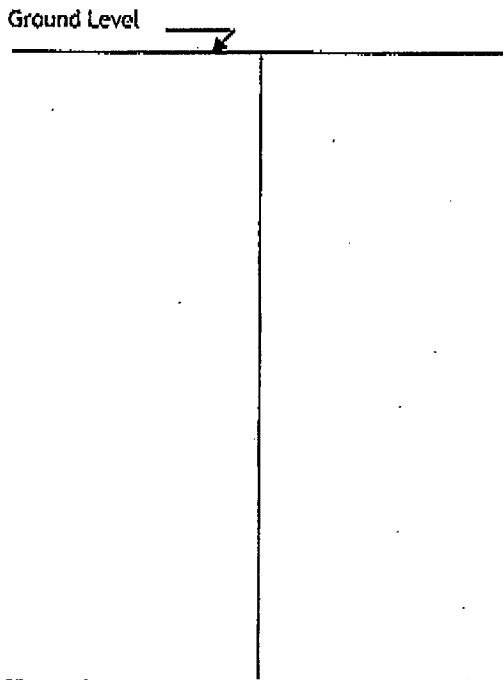

Description of formations encountered must be provided for all wells and boreholes, unless specifically exempted by regulations

Description of Formations Encountered	From (depth)	To (depth)
Top Soil and Clay	Ground level	15
Clay	15	25
Fine Sand	25	45
Med Sand	45	65
Coarse Sand	65	75
Coarse Sand / light gravel	75	115
Coarse Sand	115	125

If more than one screen, show location of each on sketch

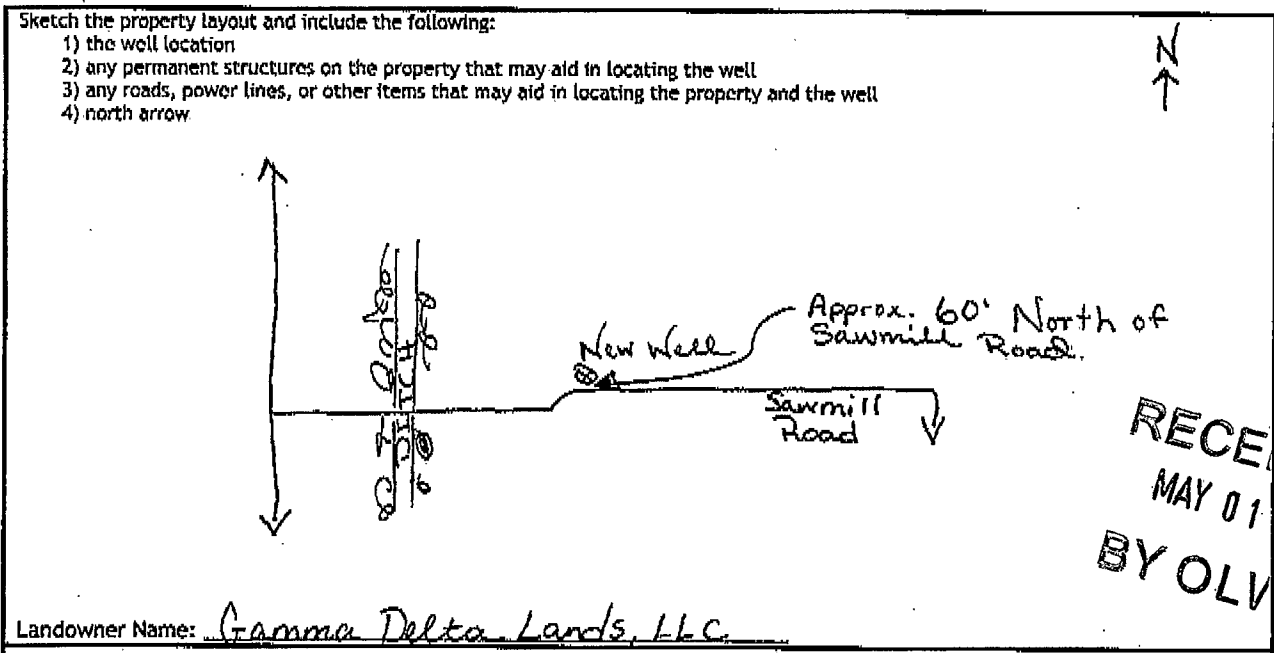

RECEIVED  
 MAY 01 2018  
 BY OLWR

Landowner Name: Gamma Delta Lands, LLC

I HEREBY CERTIFY that the well/borehole was drilled, constructed, and completed in accordance with all applicable requirements of the Mississippi Department of Environmental Quality and the Mississippi Department of Health regulations, if applicable, and state laws.

Peyton Overstreet 00032026      4-27-18      Peyton Overstreet  
 Print Name of Responsible Licensee and License No.      Date      Signature of Licensee

### STATE WELL REPORT

#### Part 2

County: Bolivar  
 Permit #: GW-50372  
 Driller: Jonathan Gordon  
 Date completed: 4-13-18  
*Copy information from block on Part 1*

**Pump Installer's Completion Report**  
 Mississippi Department of Environmental Quality  
 Office of Land and Water Resources  
 P.O. Box 2309  
 Jackson, MS 39225-2309  
 (601)961-5210  
 (601) 360-0535 (fax)

**For Office Use Only:**  
 Well #: P232  
 Aquifer: \_\_\_\_\_

*This part of the report must be completed by a licensed water well contractor or a licensed pump installer. A copy of Part 1 of the report must be attached and both parts filed with the Department at the above address within 30 days of well completion.*

Well Owner Information	Well Location
Owner Name: <u>Gamma Delta Lands, LLC</u>	Latitude: <u>33° 37' 25.48"</u> Longitude: <u>90° 50' 23.42"</u>
Mailing Address: <u>107 Court St</u>	Method of Lat/Long (check one): Conventional Survey _____
<u>Clarksdale</u> MS <u>38614</u>	USGS quad _____, Hand-held GPS <input checked="" type="checkbox"/> , Survey-grade GPS _____
City State Zip Code	<u>SW 1/4 NE 1/4, Sec 32 T 21N R 06W</u>
Telephone No. ( ) _____	<u>4</u> Miles <u>SE</u> of <u>Shaw</u>
	(Distance) (Direction) (Nearest Town)

**Pump Type (circle one)**  
 Submersible  Turbine Air Lift Centrifugal Flowing Well Jet Piston Rotary Other (describe): \_\_\_\_\_  
 Date Pump Installed: 4-13-18 Rated Pump Capacity: \_\_\_\_\_ Gallons Per Minute  
 Is This Pump (circle one):  New Repaired Replacement

**Power Type (circle one)**  
 Electric Diesel Gasoline Natural Gas Tractor PTO Windmill Other (describe): \_\_\_\_\_  
 Horse Power Rating of Motor: 60hp Setting Depth: 80 feet Number of Stages: 1

**Pump Test Data for Non Flowing Well**  
 Date Well Tested: NOT TESTED Duration of Pump Test (minimum 4 hours): N/A hours  
 Static Water Level (A): 40' Feet Below Land Surface Pumping Water Level (B): N/A Feet Below Land Surface  
 Drawdown [(B) - (A)]: N/A Feet Below Land Surface Test Pumping Rate: N/A Gallons Per Minute  
 Method of measurement (circle one): Steel tape  Electric tape Air line Other (describe): \_\_\_\_\_

**Pump Test Data for Flowing Well** N/A  
 Measured shut in head: \_\_\_\_\_ feet.  
 Well yielded \_\_\_\_\_ GPM with a drawdown of \_\_\_\_\_ feet after \_\_\_\_\_ hours of pumping

**Meter Installation** N/A  
 Meter Manufacturer: \_\_\_\_\_ Meter Serial Number: \_\_\_\_\_  
 Meter Model Number/Name: \_\_\_\_\_ Type of Meter: \_\_\_\_\_  
 Totalizer Register Unit and Multiplier Factor (AF x .001, gal x 1000, etc): \_\_\_\_\_  
 Installation Date: \_\_\_\_\_ Meter installed by: \_\_\_\_\_  
 Is This Meter (circle one): New Repaired Replacement  
*Important: By submitting the above information you are certifying that this meter was installed to manufacturer standards. For agricultural wells, a list of approved meters is on the MDEQ website.*

**RECEIVED**  
 MAY 01 2018  
 BY OLWR

I HEREBY CERTIFY that the above statements are true to the best of my knowledge.  
Payton Overstreet 00008026 4-27-18 Payton Overstreet  
 Print Name of Pump Installer and License No. (if applicable) Date Signature of Pump Installer

P232

**STATE OF MISSISSIPPI**  
**Department of Environmental Quality**  
**Office of Land and Water Resources**  
**P. O. Box 2309**  
**Jackson, Mississippi 39225**

**PERMIT**

**TO DIVERT OR WITHDRAW FOR BENEFICIAL USE THE PUBLIC WATERS**

This permit is issued to the landowner named below in accordance with the provisions of the Mississippi Water Laws, Mississippi Code Sections 51-3-1, et seq. (1972, as amended), and the regulations and standards as promulgated thereunder. Whether or not specifically named in this permit or in the applications for this permit, anyone using water from the diversion/withdrawal point described below shall do so in compliance with the provisions of this permit. Neither this permit, nor any authority conferred hereby, may be sold, conveyed, encumbered, assigned, or otherwise aliened, for any period of time or under any conditions whatsoever. This permit may not be modified, transferred or revoked without prior action by the Permit Board. Any attempts to modify, transfer or revoke this permit, or to take any other action on this permit, shall be invalid and unenforceable and may result in immediate revocation or suspension of this permit. The holder of this permit shall at all times be responsible for adherence to the terms and conditions of this permit. No agreement between the permit holder and any other party shall affect the obligations and liabilities of the permit holder. Water use under this permit is allowed only when the streamflow, lake level elevation, or static groundwater level (whichever, if any, is applicable) is above the established minimum, pursuant to Mississippi Code Section 51-3-7. Authorization is hereby granted to divert/withdraw water for the beneficial use designated herein, and for no other purpose, subject to the following terms, conditions, and limitations:

**Permit Number:** MS-GW-50372

**Landowner Name:** GAMMA DELTA LANDS  
**Landowner Address:** 107 COURT STREET  
 CLARKSDALE MS 38614

**Source Of Water:** MISSISSIPPI RIVER VALLEY ALLUVIAL AQUIFER

**Beneficial Use:** IRRIGATION

**Diversion/Withdrawal Location:** SW 1/4 of the NE 1/4      **Section:** 32    **Township:** 21N    **Range:** 06W

**County:** BOLIVAR

**Quad:** SHAW

**Maximum Volume:** 510 Acre-Feet/Year    *equivalent to* .4552 Million Gallons/Day

**Maximum Rate:** 2400 Gallons/Minute

**Applicant Name:** MCKNIGHT, NAT

**Applicant Address:** 402 NORTH SHARPE AVENUE  
 CLEVELAND MS 38732

**Date Permit Issued:** 04/05/2018

**Date Permit Expires:** 04/05/2023

**Date Permit Modified:**

**Date Permit Re-issued:**

This permit shall be deemed null and void if construction has not begun within one (1) year of permit issue date

**SPECIAL TERMS AND CONDITIONS:** SEE ATTACHMENT 1, WHICH IS HEREBY DECLARED TO BE PART OF THIS PERMIT.

**SPECIAL TERMS AND CONDITIONS 2:** WATER VOLUME MUST BE REDUCED BY AMOUNT OF WATER APPLIED TO THE SAME ACREAGE FROM OTHER PERMITTED POINTS.

RECEIVED

MAY 01 2018

BY OLWR

  
 Gary C. Rikard, Executive Director  
 Mississippi Department of Environmental Quality