

State Well Report

Part 1

Mississippi Department of Environmental Quality
Office of Land and Water Resources
P.O. Box 10631
Jackson, MS 39289-0631
(601)961-5210
(601)354-6938 (fax)

County: Bolivar
Permit #: GW4269A
Irrigation Equipment
Driller:
Date drilling completed: 7-7-08

For Office Use Only:
Aquifer:
Well #: P-182
L. S. Elevation:
E-log #:

State Law requires that this report be prepared by the driller in detail and filed with the Department within 30 days of completion of drilling of the well.

Well Owner Information	Well Location
Owner Name: <u>Myers Farm LLC</u>	Latitude: <u>33° 38' 46.0</u> Longitude: <u>90° 48' 47.1</u>
Mailing Address: <u>4563 East 30th Place</u>	Method of Lat/Long (circle one): <u>46</u> Conventional Survey, <u>47</u>
<u>Yuma</u> <u>Az</u> <u>85365</u>	USGS quad, Hand-held GPS, Survey-grade GPS
City State Zip Code	<u>SW</u> <u>SE</u> <u>1/4</u> Sec <u>22</u> Twn <u>21N</u> Rng <u>6W</u>
Telephone No. ()	Distance <u>4</u> Miles Direction <u>NW</u> of Nearest Town <u>Shaw</u>

Well Data

Purpose of Well (circle one) Home Industrial Public Supply Irrigation Fish Culture Other: _____

Date well drilling started: 7-7-08 Date well drilling completed: 7-7-08

If flowing, method of flow regulation: Valve _____ Other (describe) _____

Static Water Level: 39 feet above of below (circle one) land surface Date measured: 7-8-08

Method of Measurement (circle one) steel tape electric tape air line other: _____

Hole depth: 125 Well depth: 125 Well grouted to a depth of 10 feet

Type of grout (circle one): Cement Bentonite Mix

Casing length: 85 feet Casing diameter: 10 inches Type of casing: PVC

Screen length: 40 feet Screen diameter: 10 inches Type of screen: PVC

Screen slot size: .050 inches Setting depth: From 86 feet to 125 feet

Type of completion (circle all applicable): Gravel packed Underreamed Telescoped Open hole Natural Development

Other (describe): _____

Top of lap pipe or reduction in casing: _____ feet. If telescoped or more than one screen, describe on back of page

Logs run (circle all applicable): No log run Electric Gamma Ray Density Sonic Neutron Other: _____

Name of organization running log(s): _____

I certify that the well was drilled, constructed, and completed in accordance with all applicable requirements of the Mississippi Department of Environmental Quality and/or the Mississippi Department of Health regulations and state laws.

Irrigation Equipment Inc
Patrick M. Chism 0695

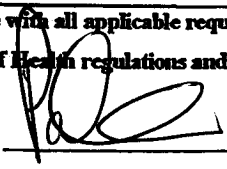
Print Name of Water Well Contractor and License No. _____ Signature of Water Well Contractor: 

RECEIVED

JUL 22 2008

BY: OLWR

P-182

If well telescopes please sketch below and show depths.

Ground Level

Description of Formations Encountered	From	To
Clay	0	16
Fine Sand	17	34
Fine Sand + Gravel	35	54
Medium Sand + Gravel	55	125

If more than one screen, show location of each on sketch

Sketch the property layout and include the following: 1) the well location; 2) any permanent structures on the property that may aid in locating the well; 3) any roads, power lines, or other items that may aid in locating the property and the well; 4) indicate direction.

Landowner Name: Myers Farm LLC

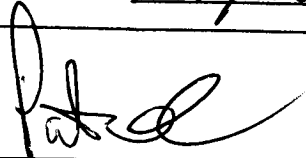
Signature of Water Well Contractor

RECEIVED

JUL 22 2008

BY: OLWR

STATE WELL REPORT

Part 2

Pump Installer's Completion Report
 Mississippi Department of Environmental Quality
 Office of Land and Water Resources
 P.O. Box 10631
 Jackson, MS 39289-0631
 (601)961-5210
 (601)354-6938 (fax)

County: Bolivar
 Permit #: _____
 Driller: Irrigation Equipment
 Date completed: 7-7-08

For Office Use Only:

Aquifer: _____
 Well #: P-182
 Elevation: _____

This report should be prepared by the pump installer in detail and filed with the Department within 30 days of the installation of pump.

Well Owner Information	Well Location
Owner Name: <u>Myers Farm LLC</u> Mailing Address: <u>4563 East 30th Place</u> <u>Yuma</u> <u>AZ</u> <u>85365</u> <small>City State Zip Code</small> Telephone No. () _____	Latitude: _____ Longitude: _____ Method of Lat/Long (circle one): <u>Conventional Survey</u> USGS quad, Hand-held GPS, Survey-grade GPS <u>SW 1/4 SE 1/4 Sec 22 Twn 21N Rng 6W</u> Distance Direction Nearest Town <u>4</u> Miles <u>NW</u> of <u>Shaw</u>

Pump Type Circle one	Power Type Circle one
Air Lift Jet <input checked="" type="radio"/> <u>Submersible</u> Bucket Piston Turbine Centrifugal Rotary Flowing Well Other (specify): _____ Date Pump Installed: <u>7-8-08</u> Rated Pump Capacity: <u>1100 ±</u> Gallons Per Minute	Diesel Engine Gasoline Engine Natural Gas <input checked="" type="radio"/> <u>Electric Motor</u> Hand Tractor PTO Windmill Other (specify): _____ Horse Power Rating of Motor: <u>25</u> Setting Depth: <u>70</u> feet Number of Stages: <u>1</u>

Pump Test Data	Method of Measuring Water Level Circle one
Date Well Tested: _____ Static Water Level (A): _____ Feet Below Land Surface Pumping Water Level (B): _____ Feet Below Land Surface Drawdown [(B) - (A)]: _____ Feet Below Land Surface Test Pumping Rate: _____ Gallons Per Minute Duration of Pump Test (minimum 4 hours): _____ hours	Air Line Electric Measuring Line Steel Tape Other (specify): _____ For flowing well, measured shut in head: _____ feet Well yielded _____ GPM with a drawdown of _____ feet after _____ hours of pumping

I HEREBY CERTIFY that the above statements are true to the best of my knowledge.

Patrick M. Chism 0695
 Print Name of Pump Installer and License No. (if applicable) Signature of Pump Installer

RECEIVED

JUL 22 2008
 BY: OLWR

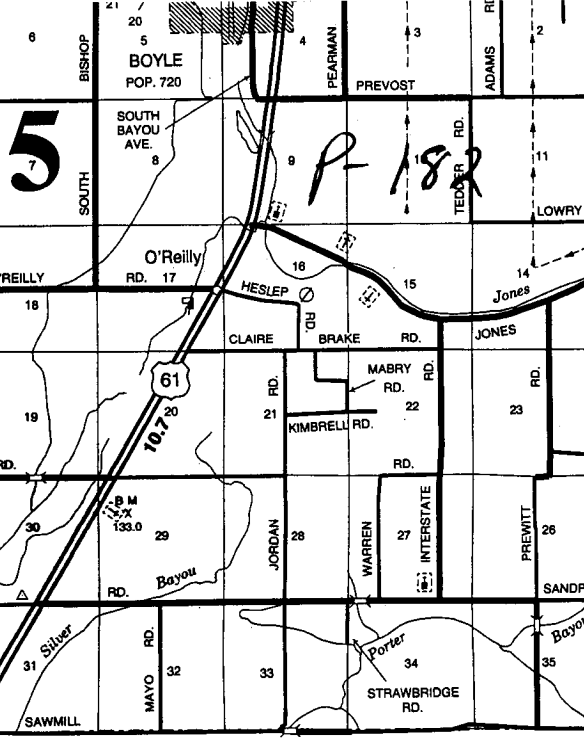
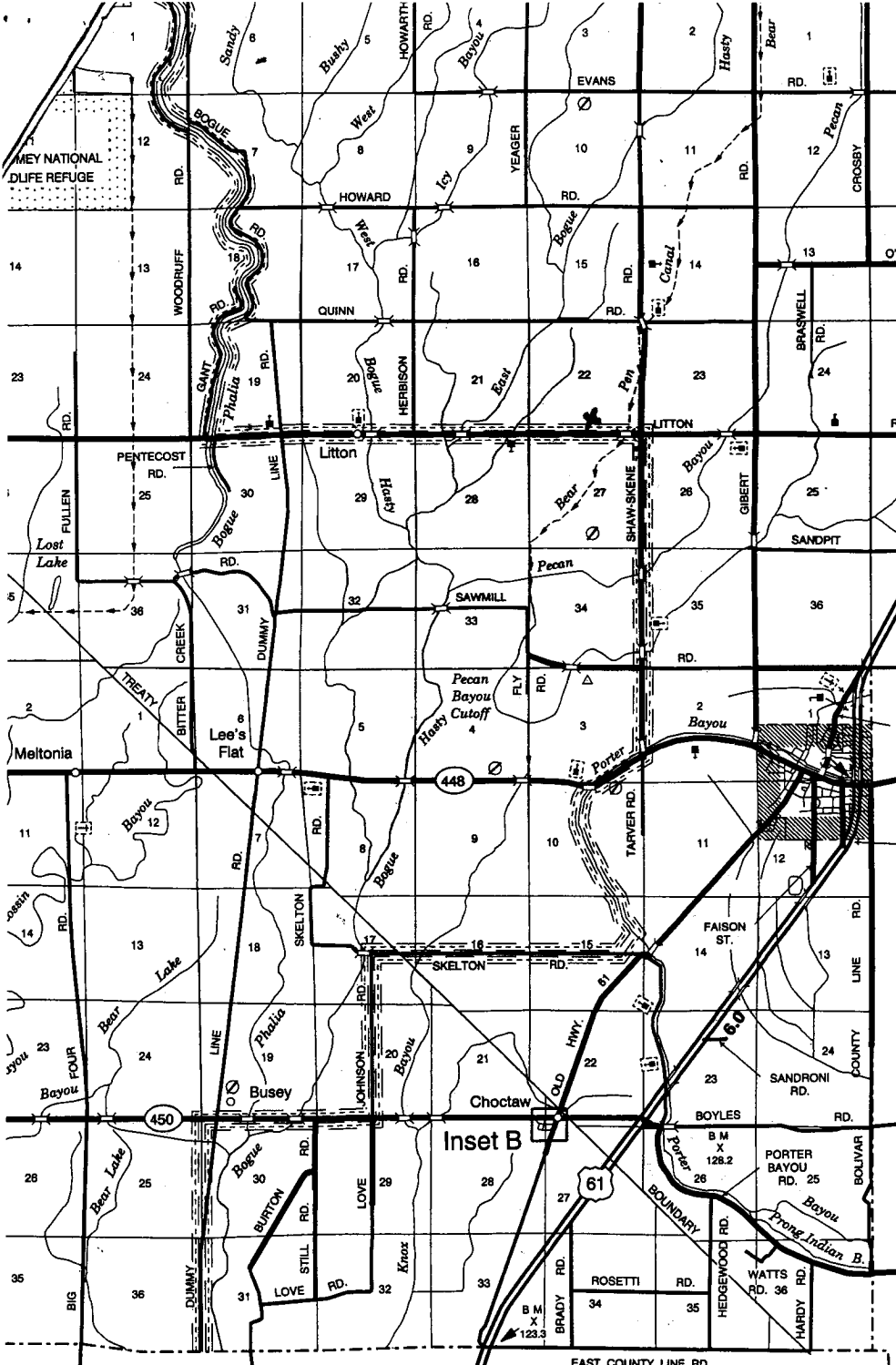

5

P 182

SUNFLOWER COUNTY

R 5 W

Myers Farm Map

GENERAL HIGHWAY

BOLIVAR COUNTY

MISSISSIPPI

© 2006

MISSISSIPPI DEPARTMENT OF TRANSPORTATION

PLANNING DIVISION

IN COOPERATION WITH

U.S. DEPARTMENT OF TRANSPORTATION

FEDERAL HIGHWAY ADMINISTRATION

TRANSVERSE MERCATOR PROJECTION

STATE PLANE COORDINATE SYSTEM

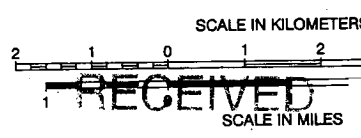

JUL 22 2008

BY: OLWR

DATA SOURCES	
2004 ASCS AERIAL PHOTOS	
1987 USGS DLG	
2002 MDOT FIELD INVENTORY	
2000 POPULATION 40,633	
2006 BEAT LINES	

90° 50'

90° 45'

660 000 m