

State Well Report

Part 1

Mississippi Department of Environmental Quality
Office of Land and Water Resources
P.O. Box 10631
Jackson, MS 39289-0631
(601)961-5210
(601)354-6938 (fax)

For Office Use Only:

Aquifer: _____
Well #: N-124
L. S. Elevation: _____
E-log #: _____

Bolivar
County: Washington
Permit #: GW 42000
Driller: John Newcome
Date drilling completed: 4-8-07

State Law requires that this report be prepared by the driller in detail and filed with the Department within 30 days of completion of drilling of the well.

Well Owner Information	Well Location
Owner Name: <u>Delta Pine Land Ngt</u>	Latitude: <u>33° 38' 50"</u> Longitude: <u>91° 05' 42"</u>
Mailing Address: <u>PO Box 5669</u>	Method of Lat/Long (circle one): <input type="checkbox"/> Conventional Survey, <input checked="" type="checkbox"/> Survey-grade GPS
<u>Greenville MS 38704</u>	<input checked="" type="checkbox"/> USGS quad, <input checked="" type="checkbox"/> Hand-held GPS
City State Zip Code	<u>22° 02' 21" N 91° 05' 42" W</u>
Telephone No. <u>(601) 820-8686</u>	IR SW Distance Direction Nearest Town
	<u>6</u> Miles <u>NW</u> of <u>SCOTT, MS</u>

Well Data

Purpose of Well (circle one) Home Industrial Public Supply Irrigation Fish Culture Other: _____

Date well drilling started: 4-8-07 Date well drilling completed: 4-8-07

If flowing, method of flow regulation: Valve _____ Other (describe) _____

Static Water Level: _____ feet above or below (circle one) land surface Date measured: _____

Method of Measurement (circle one) steel tape electric tape air line other: _____

Hole depth: 113 Well depth: 113 Well grouted to a depth of 10 feet

Type of grout (circle one): Cement Bentonite Mix

Casing length: 78 feet Casing diameter: 16 inches Type of casing: PVC

Screen length: 35 feet Screen diameter: 16 inches Type of screen: PVC

Screen slot size: 0.50 inches Setting depth: From 60-80-90-100 feet to 108-113 feet

Type of completion (circle all applicable): Gravel packed Underreamed Telescoped Open hole Natural Development
Other (describe): _____

Top of lap pipe or reduction in casing: _____ feet. If telescoped or more than one screen, describe on back of page

Logs run (circle all applicable): No log run Electric Gamma Ray Density Sonic Neutron Other: _____

Name of organization running log(s): _____

I certify that the well was drilled, constructed, and completed in accordance with all applicable requirements of the Mississippi Department of Environmental Quality and/or the Mississippi Department of Health regulations and state laws.

John Newcome 0-773
Print Name of Water Well Contractor and License No.

[Signature]
Signature of Water Well Contractor

RECEIVED
JUL 13 2007
BY: OLWR

N

If well telescopes please sketch below and show depths.

Ground Level

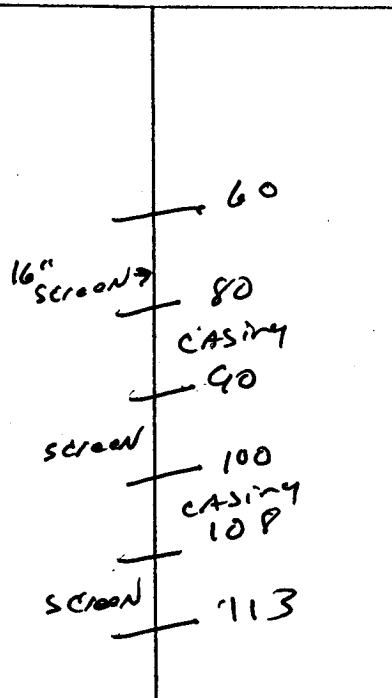

Description of Formations Encountered	From	To
Top Soil	0	10
Mix CLAY	10	38
Fine Sand	38	60
COARSE SAND	60	80
Fine Sand	80	90
COARSE SAND	90	100
Fine Sand	100	108
COARSE SAND - Gray CLAY	108	113

If more than one screen, show location of each on sketch

Sketch the property layout and include the following: 1) the well location; 2) any permanent structures on the property that may aid in locating the well; 3) any roads, power lines, or other items that may aid in locating the property and the well; 4) indicate direction.

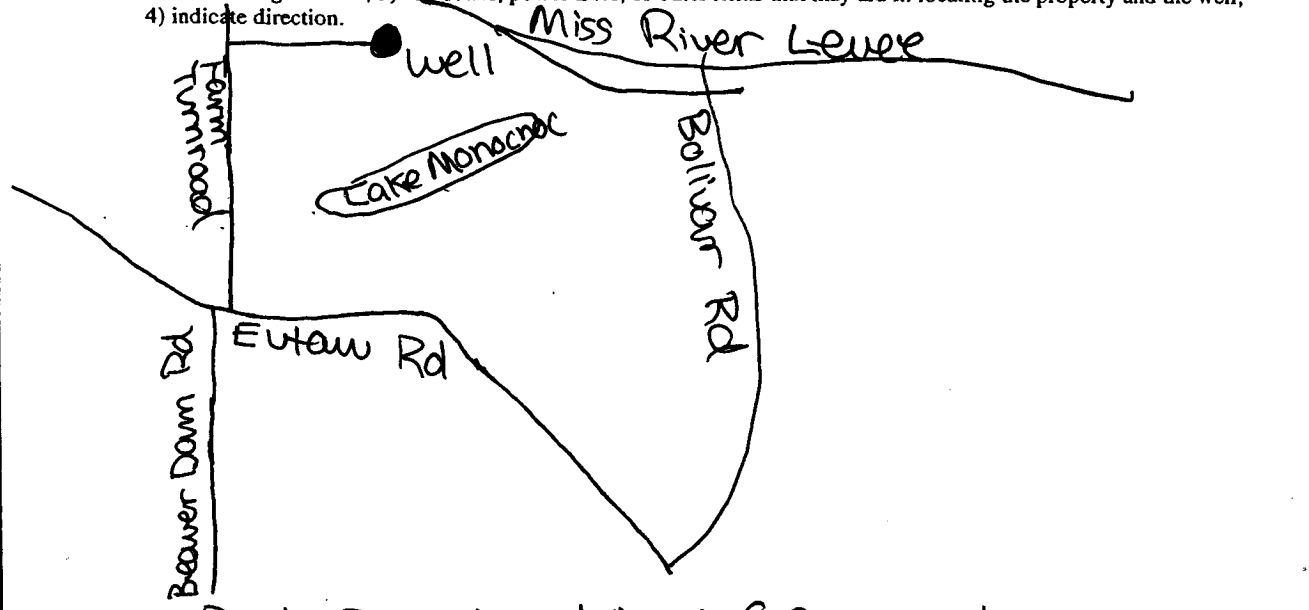

Landowner Name: Delta Pine Land Mgt (Gaylen Lawrence)

[Signature]
Signature of Water Well Contractor

STATE WELL REPORT

Part 2

Pump Installer's Completion Report
 Mississippi Department of Environmental Quality
 Office of Land and Water Resources
 P.O. Box 10631
 Jackson, MS 39289-0631
 (601)961-5210
 (601)354-6938 (fax)

For Office Use Only:

Aquifer: _____

Well #: N-124

Elevation: _____

County: FOLIVAR
 Permit #: 6W42000
 Driller: J. NAWCOMB
 Date completed: 4-8-07

This report should be prepared by the pump installer in detail and filed with the Department within 30 days of the installation of pump.

Well Owner Information	Well Location
Owner Name: <u>Gaylon Lawrence</u>	Latitude: <u>33-38-50</u> Longitude: <u>91-05-42</u>
Mailing Address: <u>DELTA PINE LAND MGMT</u> <u>PO BOX 5469</u> <u>GREENVILLE, MS. 38704</u>	Method of Lat/Long (circle one): Conventional Survey, USGS quad, <u>Hand-held GPS</u> , Survey-grade GPS
City: _____ State: _____ Zip Code: _____	<u>NW</u> 1/4 <u>NE</u> 1/4 Sec <u>22</u> Twp <u>21N</u> Rng <u>9W</u>
Telephone: <u>662-820-8686</u>	Distance _____ Direction _____ Nearest Town _____ <u>6</u> Miles <u>NW</u> of <u>SCOT</u>

Pump Type Circle one	Power Type Circle one
Air Lift: Jet <input type="checkbox"/> Submersible <input type="checkbox"/>	<u>Diesel Engine</u> Gasoline Engine Natural Gas
Bucket: Piston <input type="checkbox"/> <u>Turbine</u> <input checked="" type="checkbox"/>	Electric Motor Hand Tractor PTO
Centrifugal: Rotary <input type="checkbox"/> Flowing Well <input type="checkbox"/>	Windmill Other (specify): _____
Other (specify): _____	Horse Power Rating of Motor: <u>80</u>
Date Pump Installed: <u>4-9-07</u>	Setting Depth: <u>600</u> feet
Rated Pump Capacity: <u>1500</u> Gallons Per Minute	Number of Stages: <u>4-stage</u>

Pump Test Data	Method of Measuring Water Level Circle one
Date Well Tested: _____	Air Line Electric Measuring Line Steel Tape
Static Water Level (A): _____ Feet Below Land Surface	Other (specify): _____
Pumping Water Level (B): <u>NOT TEST</u> Feet Below Land Surface	For flowing well, measured shut in head: _____ feet
Drawdown [(B) - (A)]: _____ Feet Below Land Surface	Well yielded _____ GPM with a drawdown of _____ feet after _____ hours of pumping
Test Pumping Rate: _____ Gallons Per Minute	
Duration of Pump Test (minimum 4 hours): _____ hours	

I HEREBY CERTIFY that the above statements are true to the best of my knowledge.

GLYN ROWE #710-8
 Print Name of Pump Installer and License No. (if applicable)

[Signature]
 Signature of Pump Installer

RECEIVED

JUL 10 2007

BY: OLWR