

State Well Report

Part 1

Mississippi Department of Environmental Quality
Office of Land and Water Resources
P.O. Box 10631
Jackson, MS 39289-0631
(601)961-5210
(601)354-6938 (fax)

For Office Use Only:

Aquifer: _____
Well #: H-168
L. S. Elevation: _____
E-log #: _____

County: Belivar
Permit #: GW 41767
Driller: Willie Bryant
Date drilling completed: 4-21-07

State Law requires that this report be prepared by the driller in detail and filed with the Department within 30 days of completion of drilling of the well.

Well Owner Information	Well Location
Owner Name: <u>Curt's Smith</u>	Latitude: <u>33° 51' 48" N</u> Longitude: <u>090° 44' 28" W</u>
Mailing Address: <u>P.O. Box 244</u> <u>501 South Lane Rd.</u> <u>Mound Bayou MS 38702</u>	Method of Lat/Long (circle one): Conventional Survey, USGS quad, <u>Hand-held GPS</u> , Survey-grade GPS <u>NE 1/4 SW 1/4 Sec 8 Twn 23N Rng 5W</u>
Telephone No. <u>(662) 741-2500</u>	Distance: <u>1.5</u> Miles Direction: <u>South</u> of Nearest Town: <u>Mound Bayou</u>

Well Data

Purpose of Well (circle one) Home Industrial Public Supply Irrigation Fish Culture Other: _____

Date well drilling started: 4-21-07 Date well drilling completed: 4-21-07

If flowing, method of flow regulation: Valve _____ Other (describe) _____

Static Water Level: 25' feet above or below (circle one) land surface Date measured: 4-21-07

Method of Measurement (circle one) steel tape electric tape air line other: Roped weight

Hole depth: 100' Well depth: 100' Well grouted to a depth of 12 feet

Type of grout (circle one): Cement Bentonite Mix

Casing length: 60 feet Casing diameter: 6 inches Type of casing: PVC 160

Screen length: 40 feet Screen diameter: 6 inches Type of screen: PVC Slotted

Screen slot size: .032 inches Setting depth: From 60 feet to 100 feet

Type of completion (circle all applicable): Gravel packed Underreamed Telescoped Open hole Natural Development

Other (describe): _____

Top of lap pipe or reduction in casing: 0 feet. If telescoped or more than one screen, describe on back of page

Logs run (circle all applicable): No log run Electric Gamma Ray Density Sonic Neutron Other: _____

Name of organization running log(s): _____

I certify that the well was drilled, constructed, and completed in accordance with all applicable requirements of the Mississippi Department of Environmental Quality and/or the Mississippi Department of Health regulations and state laws.

Willie L. Bryant 0-639
Print Name of Water Well Contractor and License No.

Willie L. Bryant
Signature of Water Well Contractor

RECEIVED
MAY 15 2007
BY: OLWR

H-168

If well telescopes please sketch below and show depths.

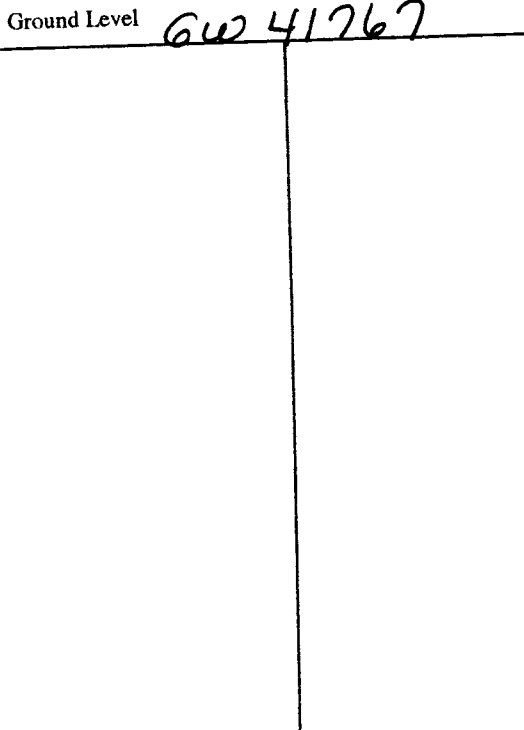

Description of Formations Encountered	From	To
Clay & Brown Sand	0	20
Brown Sand	20	40
Brown Sand	40	50
Coarse gray sand	50	60
gravel	60	80
gravel	80	100

If more than one screen, show location of each on sketch

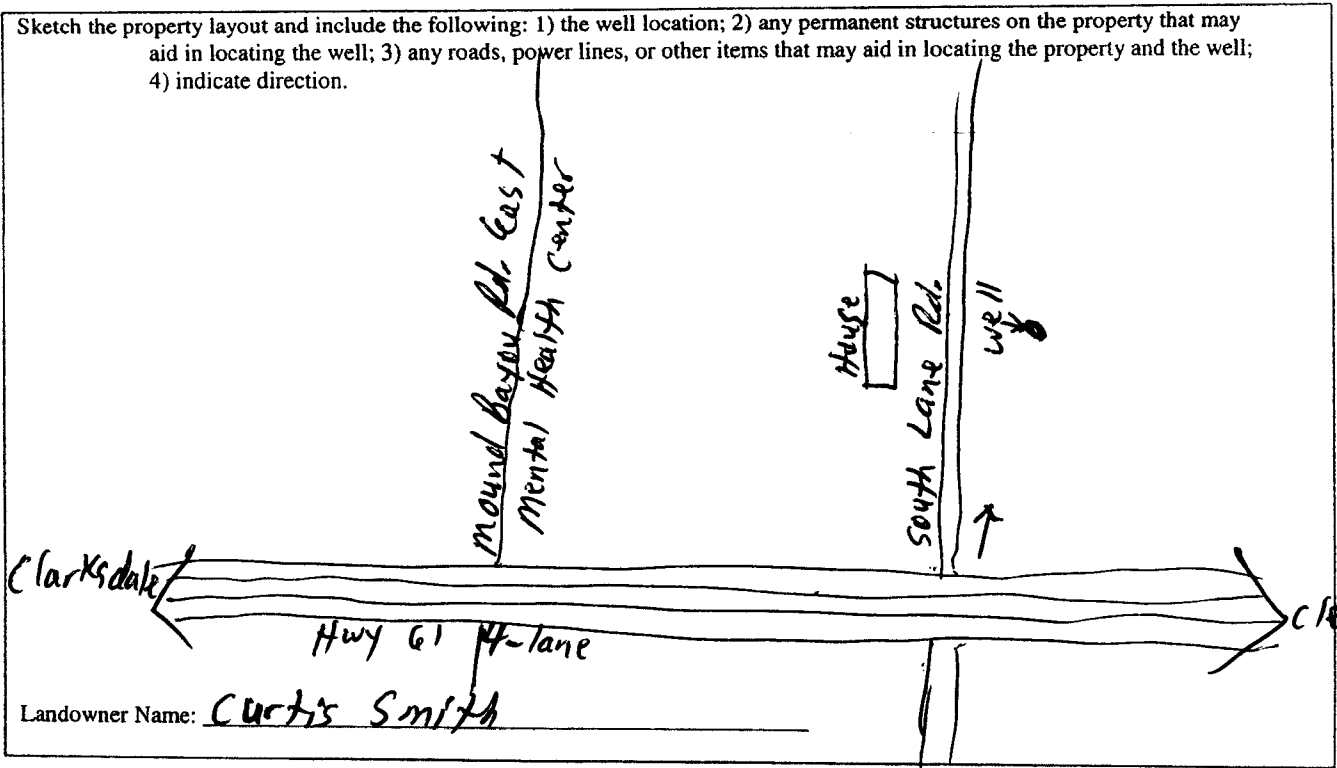

Willie L. Bryant
 Signature of Water Well Contractor

RECEIVED
 MAY 15 2007
 BY: OLWR

STATE WELL REPORT

Part 2

Pump Installer's Completion Report
 Mississippi Department of Environmental Quality
 Office of Land and Water Resources
 P.O. Box 10631
 Jackson, MS 39289-0631
 (601)961-5210
 (601)354-6938 (fax)

County: Bolivar
 Permit #: _____
 Driller: Willie Bryant
 Date completed: 4-21-07

For Office Use Only:

Aquifer: _____
 Well #: H-168
 Elevation: _____

This report should be prepared by the pump installer in detail and filed with the Department within 30 days of the installation of pump.

Well Owner Information	Well Location
Owner Name: <u>Curtis Smith</u>	Latitude: <u>33° 51.45' N</u> Longitude: <u>090° 44.25' W</u>
Mailing Address: <u>P.O. Box 244</u> <u>501 South Lane Rd.</u> <u>Mound Bayou MS 38762</u> City State Zip Code	Method of Lat/Long (circle one): Conventional Survey, USGS quad. <u>Hand-held GPS</u> , Survey-grade GPS <u>NE 1/4 SW 1/4 Sec 8</u> Twn <u>23 N</u> Rng <u>5 W</u>
Telephone No. <u>(662) 741-2500</u>	Distance Direction Nearest Town <u>1 1/2</u> Miles <u>South</u> of <u>Mound Bayou</u>

Pump Type Circle one	Power Type Circle one
Air Lift Jet <u>Submersible</u>	Diesel Engine Gasoline Engine Natural Gas
Bucket Piston Turbine	<u>Electric Motor</u> Hand Tractor PTO
Centrifugal Rotary Flowing Well	Windmill Other (specify): _____
Other (specify): _____	Horse Power Rating of Motor: <u>10</u>
Date Pump Installed: <u>4-21-07</u>	Setting Depth: <u>70</u> feet
Rated Pump Capacity: <u>375-450</u> Gallons Per Minute	Number of Stages: <u>2</u>

Pump Test Data	Method of Measuring Water Level Circle one
Date Well Tested: <u>5-16-07</u>	Air Line Electric Measuring Line Steel Tape
Static Water Level (A): <u>25</u> Feet Below Land Surface	Other (specify): <u>Rope & weight</u>
Pumping Water Level (B): <u>32</u> Feet Below Land Surface	For flowing well, measured shut in head: _____ feet
Drawdown [(B) - (A)]: <u>7</u> Feet Below Land Surface	Well yielded <u>425</u> GPM with a drawdown of
Test Pumping Rate: <u>425</u> Gallons Per Minute	<u>7</u> feet after <u>5</u> hours of pumping
Duration of Pump Test (minimum 4 hours): <u>5</u> hours	

I HEREBY CERTIFY that the above statements are true to the best of my knowledge.

Willie L. Bryant 0-639 Willie L. Bryant
 Print Name of Pump Installer and License No. (if applicable) Signature of Pump Installer

RECEIVED
 MAY 29 2007
 BY: OLWR