

# STATE WELL REPORT

## Part 1

### Driller's Log

Mississippi Department of Environmental Quality  
 Office of Land and Water Resources  
 P.O. Box 2309  
 Jackson, MS 39225-2309  
 (601)961-5555  
 (601)961-5228 (fax)

145

County: Bolivar  
 Permit #: GW 51746  
 Driller: Tyler Burnside  
 Date drilling completed: 11-17-21

**For Office Use Only:**  
 Well #: F 303  
 Acquirer: **RECEIVED**  
 E-Log #: DEC 14 2021

*State Law requires that this report be prepared by the license holder responsible for the work and filed with the Department at the above address within 30 days of completion of drilling of the well or borehole.*

**BY OLWR**

Well Owner Information <small>(Landowner if borehole is not for a water well)</small>	Well or Borehole Location
Owner Name: <u>CT Donna Farms</u>	Latitude: <u>33° 52' 7.9"</u> Longitude: <u>90° 56' 17.96"</u>
Mailing Address: <u>469 Dattle Rd</u>	Method of Lat/Long (check one): Conventional Survey _____
<u>Rosedale MS 38769</u>	USGS quad _____, Hand-held GPS _____, Survey-grade GPS _____
City State Zip Code	<u>NE 1/4 SE 1/4, Sec. 5 T 23N R 7W</u>
Telephone No. ( <u>662</u> ) <u>721-8025</u>	<u>2.5</u> Miles <u>south</u> of <u>Conger Rd</u> (Distance) (Direction) (Nearest Town)

**Well / Borehole Data**

Date drilling started: 11-16-21 Date drilling completed: 11-17-21 Hole depth: 120' Hole diameter: 2 1/2"

Location of the source of any surface water used for drilling: nearby well

Method of dosing and volume of Chlorine used in drilling and development: \_\_\_\_\_

Logs run (check all applicable):  log run  Electric  Gamma Ray  Density  Sonic  Neutron Other: No log run

Name of organization running log(s): \_\_\_\_\_

Purpose of borehole (check one):  Water Well  Geotechnical/Geological Investigation  Ground Source Heat Pump  
 Seismic Survey Other (describe) \_\_\_\_\_

*If drilling is not related to water well construction, skip the remainder of this block*

Purpose of Well (check all applicable):  Home  Industrial  Public Supply  Irrigation  Fish Culture

Other (describe): \_\_\_\_\_

If a flowing well, method of flow regulation: Valve \_\_\_\_\_ Other (describe) \_\_\_\_\_

Static Water Level: 30 feet  above or  below land surface Date measured: 11-19-21  
(check one)

Method of measurement (check one):  Steel tape  Electric tape  Air line  Other (describe): \_\_\_\_\_

Well depth: 120 Well grouted to a depth of: 10 feet Type of grout (check one):  Neat Cement  Bentonite  Mix

Casing length: 70 feet Casing diameter: 16 inches Type of casing: PVC

Screen length: 50 feet Screen diameter: 16 inches Type of screen: PVC

Screen slot size: .050 inches Setting depth: From 70 feet to 120 feet

Type of completion (check all applicable):  gravel packed  Underreamed  Open hole  Natural Development

Other (describe): \_\_\_\_\_

Top of lap pipe or reduction in casing: NA feet

*If telescoped or more than one screen, describe on next page*

County: Bolivar  
 Permit #: GW 51746

**For Office Use Only:**  
 Well #: \_\_\_\_\_

The sketch below only required for water wells  
If well telescopes, show depths on sketch.

Description of formations encountered must be provided for all wells and boreholes, unless specifically exempted by regulations

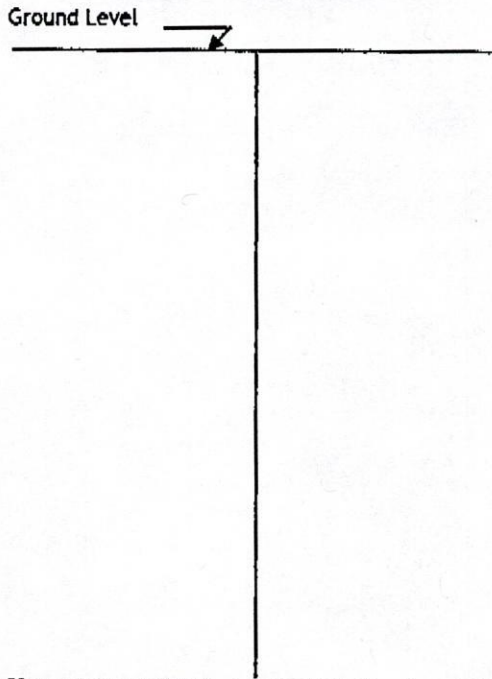

Description of Formations Encountered	From (depth)	To (depth)
Clay	Ground level	15
Fine Sand	15	35
medium sand	35	90
coarse sand and pea gravel	90	120

**RECEIVED**  
 DEC 14 2021  
**BY OLWR**

If more than one screen, show location of each on sketch

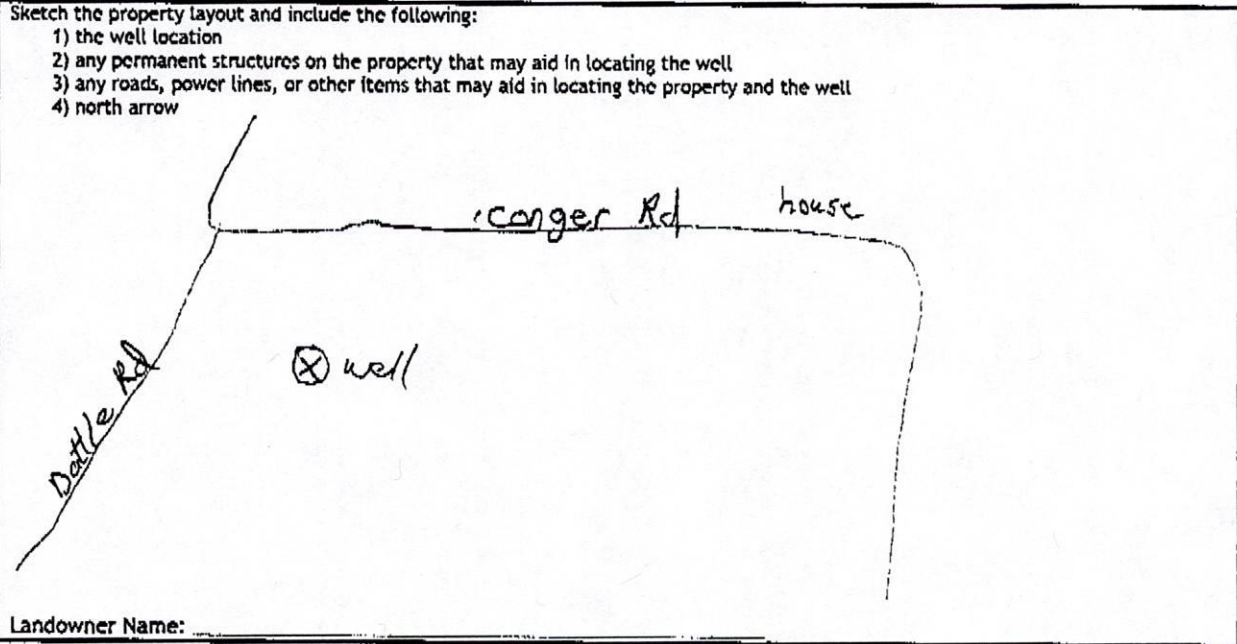

I HEREBY CERTIFY that the well/borehole was drilled, constructed, and completed in accordance with all applicable requirements of the Mississippi Department of Environmental Quality and the Mississippi Department of Health regulations, if applicable, and state laws.

Clayton Miller 0-703 12-14-21     Clayton Miller  
 Print Name of Responsible Licensee and License No.     Date     Signature of Licensee

### STATE WELL REPORT

County: Bolivar  
 Permit #: GW 51746  
 Driller: Fred Mitchell  
 Date completed: 11-19-21  
Copy information from block on Part 1

**Part 2**  
**Pump Installer's Completion Report**  
 Mississippi Department of Environmental Quality  
 Office of Land and Water Resources  
 P.O. Box 2309  
 Jackson, MS 39225-2309  
 (601)961-5210  
 (601) 360-0535 (fax)

**For Office Use Only:**  
 Well #: F 303  
 Aquifer: \_\_\_\_\_  
**RECEIVED**

*This part of the report must be completed by a licensed water well contractor or a licensed pump installer. A copy of Part 2 of the report must be attached and both parts filed with the Department at the above address within 30 days of well completion.*

<b>Well Owner Information</b>		<b>Well Location</b>	
Owner Name: <u>CT Donna Farms</u>		Latitude: <u>33° 52' 7.9"</u> Longitude: <u>90° 56' 17.96"</u>	
Mailing Address: <u>469 Dattle Rd</u>		Method of Lat/Long (check one): Conventional Survey _____	
<u>Rosedale MS 38769</u>		USGS quad _____, Hand-held GPS _____, Survey-grade GPS _____	
City	State	Zip Code	<u>ME</u> $\frac{1}{4}$ <u>SE</u> $\frac{1}{4}$ , Sec <u>5</u> T <u>23N</u> R <u>7W</u>
Telephone No. ( ) _____		<u>.25</u> Miles <u>south</u> of <u>Conger Rd</u>	
		(Distance)	(Direction) (Nearest Town)

**Pump Type (check one)**

Submersible  Turbine  Air Lift  Centrifugal  Flowing Well  Jet  Piston  Rotary  Other (describe): \_\_\_\_\_

Date Pump Installed: 11-19-2021 Rated Pump Capacity: 200 Gallons Per Minute

Is This Pump (check one):  New  Repaired  Replacement

**Power Type (check one)**

Electric  Diesel  Gasoline  Natural Gas  Tractor PTO  Windmill  Other (describe): \_\_\_\_\_

Horse Power Rating of Motor: 60 Setting Depth: 70' feet Number of Stages: 2

**Pump Test Data for Non Flowing Well**

Date Well Tested: Not tested Duration of Pump Test (minimum 4 hours): \_\_\_\_\_ hours

Static Water Level (A): 30 Feet Below Land Surface Pumping Water Level (B): \_\_\_\_\_ Feet Below Land Surface

Drawdown [(B) - (A)]: \_\_\_\_\_ Feet Below Land Surface Test Pumping Rate: \_\_\_\_\_ Gallons Per Minute

Method of measurement (check one): Steel tape  Electric tape  Air line  Other (describe): \_\_\_\_\_

**Pump Test Data for Flowing Well**

Measured shut in head: \_\_\_\_\_ feet.

Well yielded \_\_\_\_\_ GPM with a drawdown of \_\_\_\_\_ feet after \_\_\_\_\_ hours of pumping

**Meter Installation**

Meter Manufacturer: No meter Meter Serial Number: \_\_\_\_\_

Meter Model Number/Name: \_\_\_\_\_ Type of Meter: \_\_\_\_\_

Totalizer Register Unit and Multiplier Factor (AF x .001, gal x 1000, etc): \_\_\_\_\_

Installation Date: \_\_\_\_\_ Meter Installed by: \_\_\_\_\_

Is This Meter (check one):  New  Repaired  Replacement

*Important: By submitting the above information you are certifying that this meter was installed to manufacturer standards. For agricultural wells, a list of approved meters is on the MDEQ website.*

I HEREBY CERTIFY that the above statements are true to the best of my knowledge.

Clayton Miller 0-703 12-14-21 Clayton Miller

Print Name of Pump Installer and License No. (if applicable) Date Signature of Pump Installer