

# STATE WELL REPORT

## Part 1

### Driller's Log

Mississippi Department of Environmental Quality  
Office of Land and Water Resources  
P.O. Box 2309  
Jackson, MS 39275-2309  
(601)961-5210  
(601)360-0535 (fax)

### For Office Use Only:

Well #: E 223  
Aquifer: \_\_\_\_\_  
E-Log #: \_\_\_\_\_

County: Bolivar  
Permit #: \_\_\_\_\_  
Driller: W. Bryant  
Date drilling completed: 6-5-16

*State Law requires that this report be prepared by the license holder responsible for the work and filed with the Department at the above address within 30 days of completion of drilling of the well or borehole.*

<p style="text-align: center;"><b>Well Owner Information</b> (Landowner if borehole is not for a water well)</p> <p>Owner Name: <u>Wilma J. Warren</u> Mailing Address: <u>P.O. Box 7</u> <u>Old Hwy 61 S.</u> <u>Mound Bayou MS 38762</u> City State Zip Code Telephone No. <u>(662) 719-0335</u></p>	<p style="text-align: center;"><b>Well or Borehole Location</b></p> <p>Latitude: <u>33° 53' 49"</u> Longitude: <u>90° 44' 29" W</u> Method of Lat/Long (check one): Conventional Survey _____ USGS quad _____, Hand-held GPS <input checked="" type="checkbox"/>, Survey-grade GPS _____ <u>SE</u> 1/4 <u>SW</u> 1/4, Sec <u>29</u> T <u>24</u>N R <u>5</u>W <u>1</u> Miles <u>N</u> of <u>Mound Bayou, MS</u> (Distance) (Direction) (Nearest Town)</p>
--	--

**Well / Borehole Data**

Date drilling started: 6-5-16 Date drilling completed: 6-5-16 Hole depth: 125' Hole diameter: 7"  
Location of the source of any surface water used for drilling: Near by ditch  
Method of dosing and volume of Chlorine used in drilling and development: Chlorine Tablets  
Logs run (circle all applicable):  No log run  Electric  Gamma Ray  Density  Sonic  Neutron  Other: \_\_\_\_\_  
Name of organization running log(s): \_\_\_\_\_  
Purpose of borehole (circle one):  Water Well  Geotechnical/Geological Investigation  Ground Source Heat Pump  
 Seismic Survey  Other (describe) \_\_\_\_\_  
*If drilling is not related to water well construction, skip the remainder of this block*

Purpose of Well (circle all applicable): Home  Industrial  Public Supply   Irrigation  Fish Culture  
Other (describe): \_\_\_\_\_  
If a flowing well, method of flow regulation: Valve \_\_\_\_\_ Other (describe) \_\_\_\_\_  
Static Water Level: 42' feet [above or  below] land surface Date measured: 6-5-16  
(circle one)  
Method of measurement (circle one): Steel tape  Electric tape  Air line  Other (describe): Sonic water level meter  
Well depth: 125' Well grouted to a depth of: 10 feet Type of grout (circle one): Heat Cement   Bentonite  Mix  
Casing length: 95 feet Casing diameter: 4 inches Type of casing: 4" PVC  
Screen length: 30 feet Screen diameter: 4 inches Type of screen: PVC slotted  
Screen slot size: .013 inches Setting depth: From 95 feet to 125 feet  
Type of completion (circle all applicable):  Gravel packed  Underreamed  Open hole  Natural Development  
Other (describe): \_\_\_\_\_  
Top of lap pipe or reduction in casing: \_\_\_\_\_ feet  
*If telescoped or more than one screen, describe on next page*

Received

Form: OLWR-SWR-1A (4/13)

JUL 13 2016

By OLWR

County: Solivar  
 Permit #: \_\_\_\_\_

**For Office Use Only:**  
 Well #: \_\_\_\_\_

The sketch below only required for water wells  
If well telescopes, show depths on sketch

Description of formations encountered must be provided for all wells  
and boreholes, unless specifically exempted by regulations

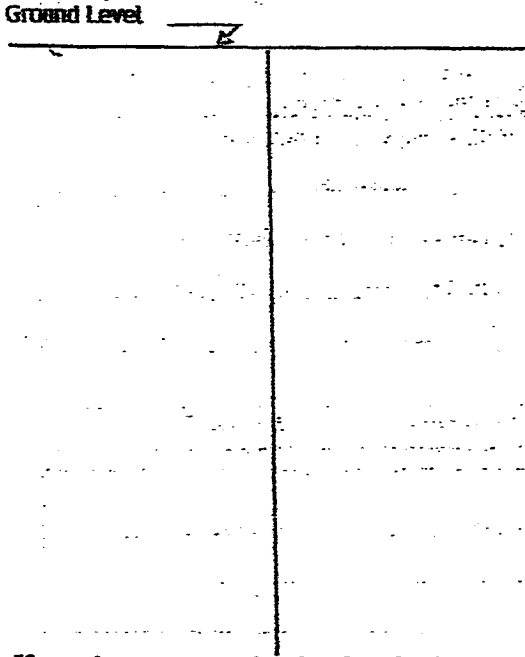

Description of Formations Encountered	From (depth)	To (depth)
clay	Ground level	10
brown sand	10	20
med. sand	20	40
coarse sand	40	80
gravel	80	125

If more than one screen, show location of each on sketch

- Sketch the property layout and include the following:
- 1) the well location
  - 2) any permanent structures on the property that may aid in locating the well
  - 3) any roads, power lines, or other items that may aid in locating the property and the well
  - 4) north arrow

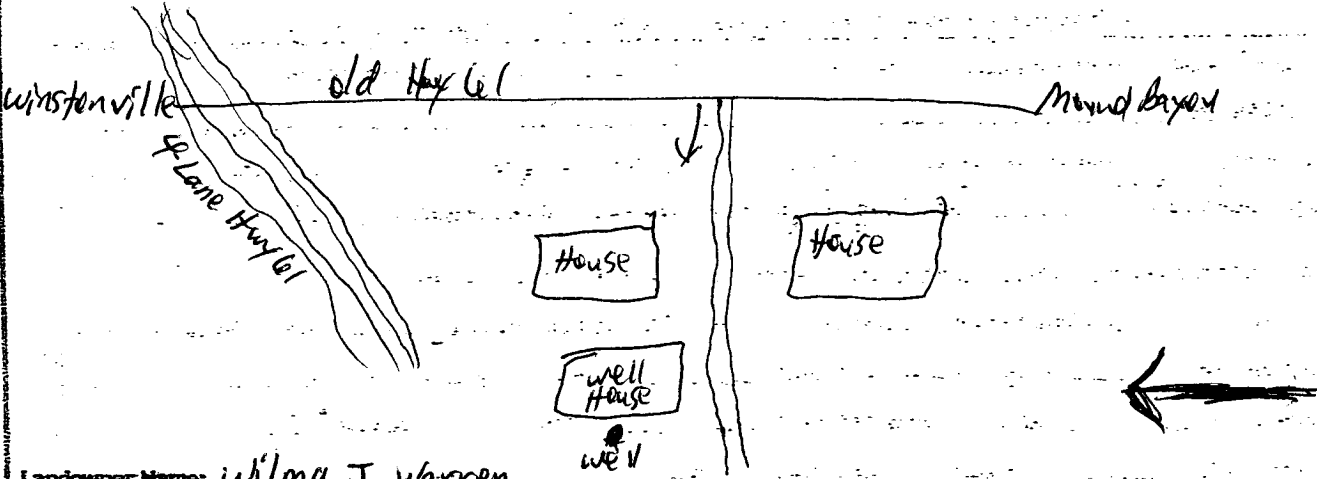

Landowner Name: Wilma J. Warren

I HEREBY CERTIFY that the well/borehole was drilled, constructed, and completed in accordance with all applicable requirements of the Mississippi Department of Environmental Quality and the Mississippi Department of Health regulations, if applicable, and state laws.

Willie L. Bryant    0-639    7-10-16    Willie L. Bryant  
 Print Name of Responsible Licensee and License No.      Date      Signature of Licensee

# STATE WELL REPORT

## Part 2

**Pump Installer's Completion Report**  
 Mississippi Department of Environmental Quality  
 Office of Land and Water Resources  
 P.O. Box 2309  
 Jackson, MS 39225-2309  
 (601)961-5210  
 (601) 360-0535 (fax)

**For Office Use Only:**

Well #: E 223  
 Aquifer: \_\_\_\_\_

County: Bolivar  
 Permit #: \_\_\_\_\_  
 Driller: W. Bryant  
 Date completed: 6-5-16  
*Copy information from block on Part 1*

*This part of the report must be completed by a licensed water well contractor or a licensed pump installer. A copy of Part I of the report must be attached and both parts filed with the Department at the above address within 30 days of well completion.*

Well Owner Information	Well Location
Owner Name: <u>Wilma J. Warren</u>	Latitude: <u>33° 53.82' N</u> Longitude: <u>090° 44.37' W</u>
Mailing Address: <u>P.O. Box 7</u>	Method of Lat/Long (check one): Conventional Survey _____
<u>Old Hwy 61 S</u>	USGS quad _____, Hand-held GPS <input checked="" type="checkbox"/> , Survey-grade GPS _____
<u>Mound Bayou MS 38762</u>	_____ 1/4 _____ 1/4, Sec <u>29</u> T <u>24N</u> R <u>5W</u>
City _____ State _____ Zip Code _____	<u>1</u> Miles <u>N</u> of <u>Mound Bayou MS</u>
Telephone No. <u>(662) 719-0335</u>	(Distance) (Direction) (Nearest Town)

**Pump Type (circle one)**

Submersible  Turbine  Air Lift  Centrifugal  Flowing Well  Jet  Piston  Rotary  Other (describe): \_\_\_\_\_

Date Pump Installed: \_\_\_\_\_ Rated Pump Capacity: 60 Gallons Per Minute

Is This Pump (circle one):  New  Repaired  Replacement

**Power Type (circle one)**

Electric  Diesel  Gasoline  Natural Gas  Tractor PTO  Windmill  Other (describe): \_\_\_\_\_

Horse Power Rating of Motor: 3 Setting Depth: 100 feet Number of Stages: 8

**Pump Test Data for Non Flowing Well**

Date Well Tested: \_\_\_\_\_ Duration of Pump Test (minimum 4 hours): 5 hours

Static Water Level (A): 42 Feet Below Land Surface Pumping Water Level (B): 49 Feet Below Land Surface

Drawdown [(B) - (A)]: 7 Feet Below Land Surface Test Pumping Rate: 72 Gallons Per Minute

Method of measurement (circle one): Steel tape  Electric tape  Air line  Other (describe): Some water level meter

**Pump Test Data for Flowing Well**

Measured static in head: \_\_\_\_\_ feet.

Well yielded 72 GPM with a drawdown of 7 feet after 5 hours of pumping

**Meter Installation**

Meter Manufacturer: \_\_\_\_\_ Meter Serial Number: \_\_\_\_\_

Meter Model Number/Name: \_\_\_\_\_ Type of Meter: \_\_\_\_\_

Totalizer Register Unit and Multiplier Factor (AF x .001, gal x 1000, etc): \_\_\_\_\_

Installation Date: \_\_\_\_\_ Meter installed by: \_\_\_\_\_

Is This Meter (circle one):  New  Repaired  Replacement

*Important: By submitting the above information you are certifying that this meter was installed to manufacturer standards. For agricultural wells, a list of approved meters is on the MDEQ website.*

I HEREBY CERTIFY that the above statements are true to the best of my knowledge.

Willie L. Bryant 0-639 7-10-16 Willie L. Bryant  
 Print Name of Pump Installer and License No. (if applicable) Date Signature of Pump Installer

Received

Form: OLWR-SWR-1B (4/13)  
 JUL 13 2016  
 By OLWR