

# State Well Report

## Part 1

Mississippi Department of Environmental Quality  
Office of Land and Water Resources  
P.O. Box 10631  
Jackson, MS 39289-0631  
(601)961-5210  
(601)354-6938 (fax)

### For Office Use Only:

Aquifer: \_\_\_\_\_  
Well #: N-25  
L. S. Elevation: \_\_\_\_\_  
E-log #: \_\_\_\_\_

County: BENTON  
Permit #: \_\_\_\_\_  
Driller: Leeper Drilling  
Date drilling completed: 3-24-06

State Law requires that this report be prepared by the driller in detail and filed with the Department within 30 days of completion of drilling of the well.

Well Owner Information	Well Location
Owner Name: <u>K. C. Smith</u>	Latitude: _____ Longitude: _____
Mailing Address: <u>Beck Springs Rd</u>	Method of Lat/Long (circle one): Conventional Survey, USGS quad, Hand-held GPS, Survey-grade GPS
<u>POTTS CAMP MS</u> City State Zip Code	_____ 1/4 _____ 1/4 Sec <u>14</u> Twn <u>55</u> Rng <u>1W</u>
Telephone No. ( <u>662</u> ) <u>266-3412</u>	Distance Direction Nearest Town <u>3</u> Miles <u>E</u> of <u>POTTS CAMP</u>

### Well Data

Purpose of Well (circle one) Home Industrial Public Supply Irrigation Fish Culture Other: \_\_\_\_\_

Date well drilling started: 3-20-06 Date well drilling completed: 3-24-06

If flowing, method of flow regulation: Valve \_\_\_\_\_ Other (describe) \_\_\_\_\_

Static Water Level: 170 feet above or below (circle one) land surface Date measured: 3-25-06

Method of Measurement (circle one) steel tape electric tape air line other: \_\_\_\_\_

Hole depth: 840 ft Well depth: 840 ft Well grouted to a depth of 10 feet

Type of grout (circle one): Cement Bentonite Mix

Casing length: ~~3730~~ feet Casing diameter: 4" inches Type of casing: PVC

Screen length: 60 feet Screen diameter: 2" inches Type of screen: PVC

Screen slot size: .010 inches Setting depth: From 780 feet to 840 feet

Type of completion (circle all applicable): Gravel packed Underreamed Telescoped Open hole Natural Development  
Other (describe): \_\_\_\_\_

Top of lap pipe or reduction in casing: \_\_\_\_\_ feet. If telescoped or more than one screen, describe on back of page

Logs run (circle all applicable): No log run Electric Gamma Ray Density Sonic Neutron Other: \_\_\_\_\_

Name of organization running log(s): \_\_\_\_\_

I certify that the well was drilled, constructed, and completed in accordance with all applicable requirements of the Mississippi Department of Environmental Quality and/or the Mississippi Department of Health regulations and state laws.

Leeper Drilling  
Print Name of Water Well Contractor and License No.

[Signature]  
Signature of Water Well Contractor

RECEIVED  
APR 17 2006  
BY: OLWR

# STATE WELL REPORT

## Part 2

**Pump Installer's Completion Report**  
 Mississippi Department of Environmental Quality  
 Office of Land and Water Resources  
 P.O. Box 10631  
 Jackson, MS 39289-0631  
 (601)961-5210  
 (601)354-6938 (fax)

**For Office Use Only:**

Aquifer: \_\_\_\_\_  
 Well #: N-25  
 Elevation: \_\_\_\_\_

County: Beardson  
 Permit #: \_\_\_\_\_  
 Driller: Leeper Drilling  
 Date completed: 3-25-06

**This report should be prepared by the pump installer in detail and filed with the Department within 30 days of the installation of pump.**

Well Owner Information	Well Location
Owner Name: <u>K.C. Smith</u>	Latitude: _____ Longitude: _____
Mailing Address: <u>Beck Springs Road</u>	Method of Lat/Long (circle one): Conventional Survey, USGS quad, Hand-held GPS, Survey-grade GPS
<u>Potts Camp MS</u> City State Zip Code	_____ 1/4 _____ 1/4 Sec. <u>14</u> Twn <u>55</u> Rng <u>1W</u>
Telephone No. <u>(662) 266-3412</u>	Distance Direction Nearest Town <u>3</u> Miles <u>E</u> of <u>Potts Camp</u>

Pump Type Circle one	Power Type Circle one
Air Lift Jet <input type="radio"/> <u>Submersible</u> <input checked="" type="radio"/>	Diesel Engine Gasoline Engine Natural Gas
Bucket Piston <input type="radio"/> Turbine <input type="radio"/>	<u>Electric Motor</u> <input checked="" type="radio"/> Hand <input type="radio"/> Tractor PTO <input type="radio"/>
Centrifugal Rotary <input type="radio"/> Flowing Well <input type="radio"/>	Windmill Other (specify): _____
Other (specify): _____	Horse Power Rating of Motor: <u>1 HP</u>
Date Pump Installed: <u>3-25-06</u>	Setting Depth: <u>210</u> feet
Rated Pump Capacity: <u>10</u> Gallons Per Minute	Number of Stages: <u>14</u>

Pump Test Data	Method of Measuring Water Level Circle one
Date Well Tested: <u>3-25-06</u>	Air Line Electric Measuring Line <u>Steel Tape</u> <input checked="" type="radio"/>
Static Water Level (A): <u>170</u> Feet Below Land Surface	Other (specify): _____
Pumping Water Level (B): _____ Feet Below Land Surface	For flowing well, measured shut in head: _____ feet
Drawdown [(B) - (A)]: _____ Feet Below Land Surface	Well yielded _____ GPM with a drawdown of _____ feet after _____ hours of pumping
Test Pumping Rate: _____ Gallons Per Minute	
Duration of Pump Test (minimum 4 hours): _____ hours	

I HEREBY CERTIFY that the above statements are true to the best of my knowledge.

Leeper Drilling #0079  
 Print Name of Pump Installer and License No. (if applicable)

Signature of Pump Installer

**RECEIVED**  
 APR 17 2006  
 BY: OLWR

If well telescopes please sketch below and show depths.

N-25

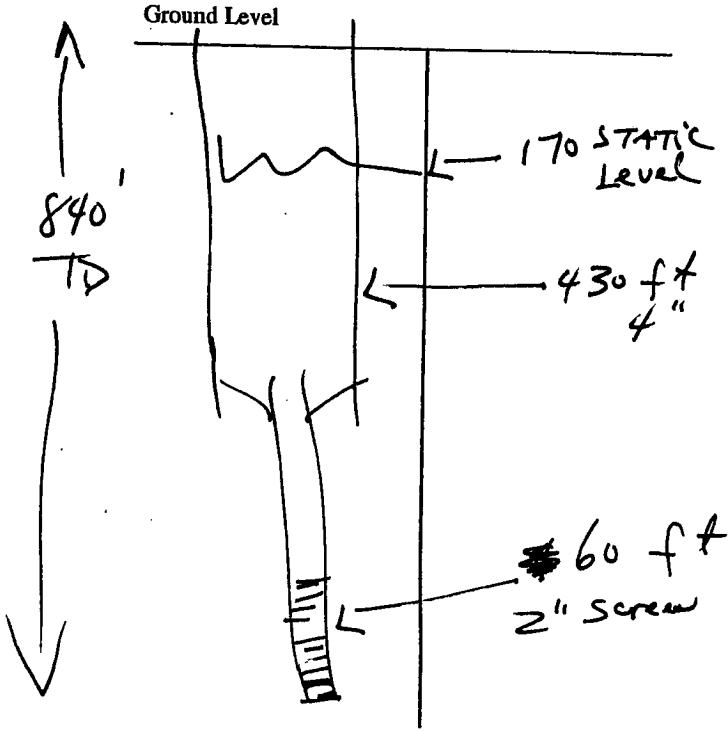

Description of Formations Encountered	From	To
Red Clay	0	50
Blue Clay	50	100
Black Clay	100	420
CHALK	420	780
SAND	780	840

If more than one screen, show location of each on sketch

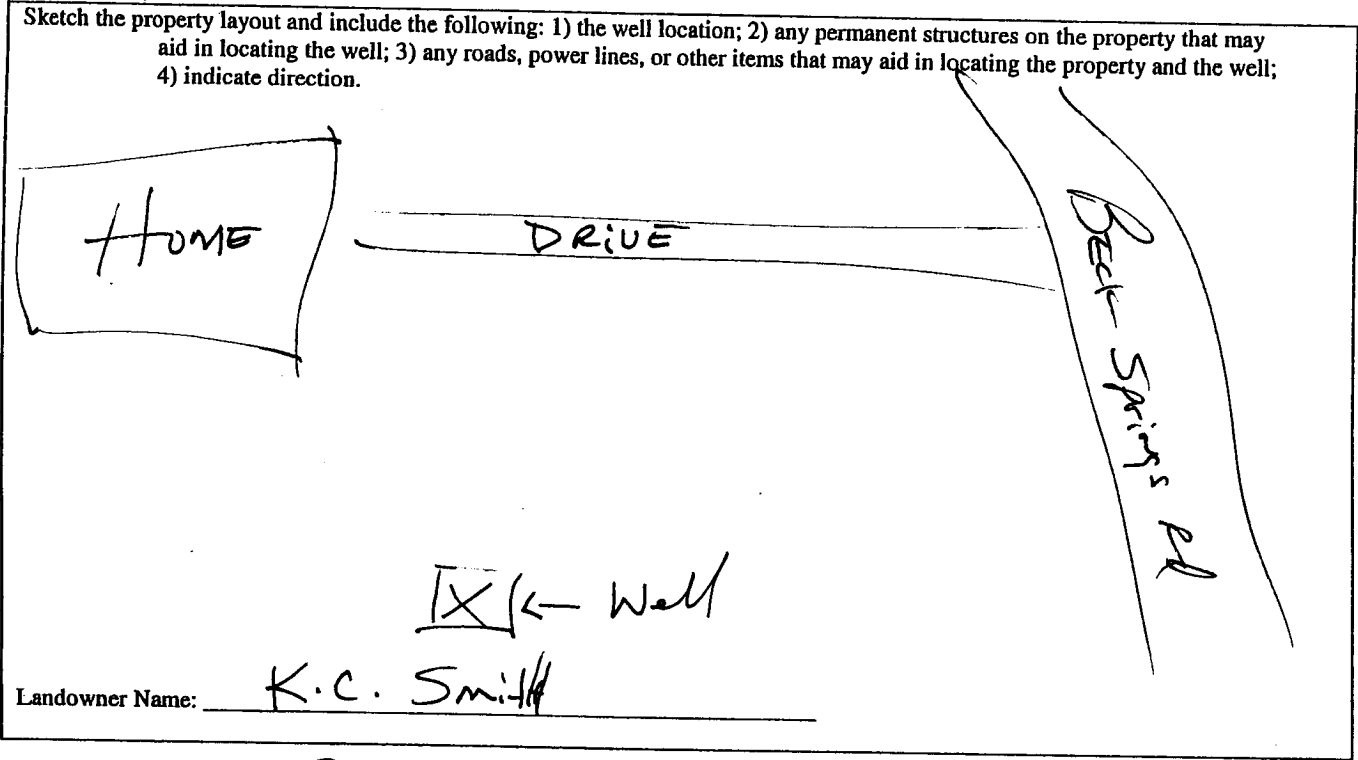

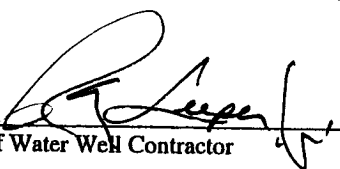
Signature of Water Well Contractor 

RECEIVED  
 APR 17 2006  
 BY: OLWR