

STATE WELL REPORT

Part 1

Driller's Log

Mississippi Department of Environmental Quality
Office of Land and Water Resources
P.O. Box 2309
Jackson, MS 39225-2309
(601)961-5210
(601)360-0535 (fax)

For Office Use Only:

Well #: 1125
Aquifer: _____
E-Log #: _____

County: Amite
Permit #: _____
Driller: Fitzgerald Well
Date drilling completed: 5-7-15

State Law requires that this report be prepared by the license holder responsible for the work and filed with the Department at the above address within 30 days of completion of drilling of the well or borehole.

Well Owner Information (Landowner if borehole is not for a water well)	Well or Borehole Location
Owner Name: <u>Steven Smith</u>	Latitude: <u>31° 4' 53.4"</u> Longitude: <u>90° 37' 53.3"</u>
Mailing Address: <u>McClendon Rd</u>	Method of Lat/Long (check one): Conventional Survey _____
<u>Liberty</u> <u>MS</u>	USGS quad _____, Hand-held GPS _____, Survey-grade GPS _____
City State Zip Code	<u>NW 1/4 NW 1/4, Sec 5 T1N R1E</u>
Telephone No. (____) _____	_____ Miles _____ of _____ (Distance) (Direction) (Nearest Town)

Well / Borehole Data

Date drilling started: 5-7-15 Date drilling completed: 5-7-15 Hole depth: 114' Hole diameter: 8"
Location of the source of any surface water used for drilling: _____
Method of dosing and volume of Chlorine used in drilling and development: _____
Logs run (circle all applicable): No log run Electric Gamma Ray Density Sonic Neutron Other: _____
Name of organization running log(s): _____
Purpose of borehole (circle one): Water Well Geotechnical/Geological Investigation Ground Source Heat Pump
Seismic Survey Other (describe) _____
If drilling is not related to water well construction, skip the remainder of this block

Purpose of Well (circle all applicable): Home Industrial Public Supply Irrigation Fish Culture
Other (describe): _____
If a flowing well, method of flow regulation: Valve _____ Other (describe) _____
Static Water Level: 70' feet [above or below] land surface Date measured: 5-7-15
(circle one)
Method of measurement (circle one): Steel tape Electric tape Air line Other (describe): _____
Well depth: 114' Well grouted to a depth of: 10' feet Type of grout (circle one): Neat Cement Bentonite Mix
Casing length: 104 feet Casing diameter: 4" inches Type of casing: PVC
Screen length: 10 feet Screen diameter: 4" inches Type of screen: PVC
Screen slot size: .010 inches Setting depth: From 104 feet to 114 feet
Type of completion (circle all applicable): Gravel packed Underreamed Open hole Natural Development
Other (describe): _____
Top of lap pipe or reduction in casing: _____ feet

If telescoped or more than one screen, describe on next page

RECEIVED
2015
BY: [Signature]

The sketch below only required for water wells

If well telescopes, show depths on sketch.
Ground Level →

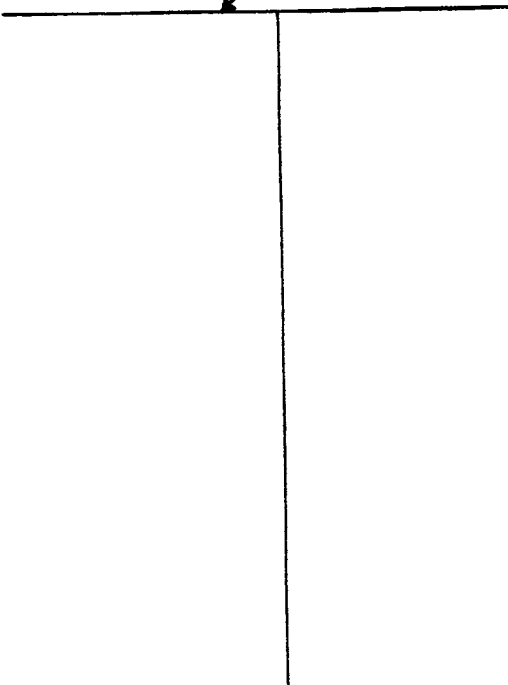

Description of formations encountered must be provided for all wells and boreholes, unless specifically exempted by regulations

Description of Formations Encountered	From (depth)	To (depth)
	Ground Level	
clay	0	20
Sand	20	60
granite	60	90
Clay Sand	90	114

If more than one screen, show location of each on sketch

Sketch the property layout and include the following: 1) the well location; 2) any permanent structures on the property that may aid in locating the well; 3) any roads, power lines, or other items that may aid in locating the property and the well; 4) a north arrow.

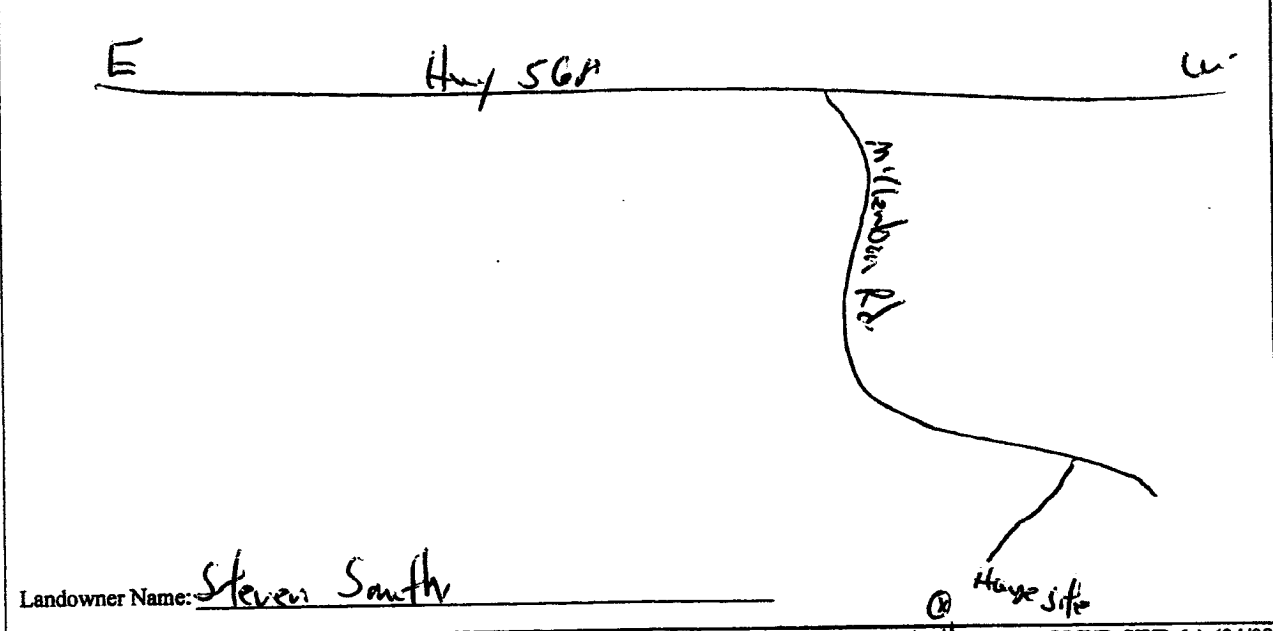

Landowner Name: Steven South

well Form: OLWR-SWR-1A (04/08)

I certify that the well/borehole was drilled, constructed, and completed in accordance with all applicable requirements of the Mississippi Department of Environmental Quality and the Mississippi Department of Health regulations, if applicable, and state laws.

Brad Fitzgerald 030 5-7-15
Print Name of Responsible Licensee and License No. Date

[Signature]
Signature of Licensee

STATE WELL REPORT

Part 2

Pump Installer's Completion Report
 Mississippi Department of Environmental Quality
 Office of Land and Water Resources
 P.O. Box 2309
 Jackson, MS 39225
 (601)961-5210
 (601)961-5228 (fax)

County: Amite
 Permit #: _____
 Driller: Fitzgerald Well
 Date completed: 5-7-15
Copy information from block on Part 1

For Office Use Only:

Aquifer: _____
 Well #: U128
 Elevation: _____

This part of the report must be completed by a licensed water well contractor or a licensed pump installer. A copy of Part 1 of the report must be attached and both parts filed with the Department at the above address within 30 days of well completion.

Well Owner Information	Well Location
Owner Name: <u>Steven Smith</u>	Latitude: <u>31° 4' 53.4"</u> Longitude: <u>90° 37' 53.2"</u>
Mailing Address: <u>McClendon Rd</u>	Method of Lat/Long (check one): Conventional Survey _____
<u>Liberty</u> <u>MS</u>	USGS quad _____, Hand-held GPS _____, Survey-grade GPS _____
City State Zip Code	_____ 1/4 _____ 1/4 Sec _____ T _____ R _____
Telephone No. () _____	Distance _____ Direction _____ Nearest Town _____
	_____ Miles _____ of _____

Pump Type	Power Type
Circle one	Circle one
Air Lift <input type="checkbox"/> Jet <input type="checkbox"/> <input checked="" type="checkbox"/> Submersible	Diesel Engine <input type="checkbox"/> Gasoline Engine <input type="checkbox"/> Natural Gas <input type="checkbox"/>
Bucket <input type="checkbox"/> Piston <input type="checkbox"/> Turbine <input type="checkbox"/>	<input checked="" type="checkbox"/> Electric Motor <input type="checkbox"/> Hand <input type="checkbox"/> Tractor PTO <input type="checkbox"/>
Centrifugal <input type="checkbox"/> Rotary <input type="checkbox"/> Flowing Well <input type="checkbox"/>	Windmill <input type="checkbox"/> Other (specify): _____
Other (specify): _____	Horse Power Rating of Motor: <u>1</u>
Date Pump Installed: <u>5-7-15</u>	Setting Depth: <u>90'</u> feet
Rated Pump Capacity: <u>14</u> Gallons Per Minute	Number of Stages: <u>12</u>

Pump Test Data	Method of Measuring Water Level
Date Well Tested: _____	Circle one
Static Water Level (A): _____ Feet Below Land Surface	Air Line <input type="checkbox"/> Electric Measuring Line <input type="checkbox"/> <input checked="" type="checkbox"/> Steel Tape
Pumping Water Level (B): _____ Feet Below Land Surface	Other (specify): _____
Drawdown [(B) - (A)]: _____ Feet Below Land Surface	For flowing well, measured shut in head: _____ feet
Test Pumping Rate: _____ Gallons Per Minute	Well yielded _____ GPM with a drawdown of _____ feet after _____ hours of pumping
Duration of Pump Test (minimum 4 hours): _____ hours	

This is for (circle one): **New Well** Replacement of Existing Pump Repair of Existing Pump

I HEREBY CERTIFY that the above statements are true to the best of my knowledge.

Brad Fitzgerald 029 Paul Hill
 Print Name of Pump Installer and License No. (if applicable) Signature of Pump Installer

RECEIVED

Form: OLWR-SWR-1C (07-09) 2015

BY OLWR