

County: Amite
 Permit #: _____
 Driller: Fitzgerald Well Serv.
 Date drilling completed: 10-22-12

State Well Report
Part 1 - Driller's Log
 Mississippi Department of Environmental Quality
 Office of Land and Water Resources
 P.O. Box 2309
 Jackson, MS 39225
 (601)961- 5210
 (601)961- 5228 (fax)

For Office Use Only:
 Aquifer: _____
 Well #: R85
 L. S. Elevation: _____
 E-log #: _____

State Law requires that this report be prepared by the license holder responsible for the work and filed with the Department at the above address within 30 days of completion of drilling of the well or borehole.

Information on Well Owner (Landowner if borehole is not for a water well)	Well or Borehole Location
Owner Name: <u>James Dixon</u>	Latitude: <u>31° 3' 42.6"</u> Longitude: <u>90° 52' 2.2"</u>
Mailing Address: <u>street Rd.</u>	Method of Lat/Long (circle one): Conventional Survey, USGS quad, Hand-held GPS, Survey-grade GPS
<u>Liberty</u> <u>MS</u> City State Zip Code	<u>NW 1/4 SW 1/4 Sec 18 Twn 1N Rng 3E</u>
Telephone No. () _____	Distance _____ Direction _____ Nearest Town: _____ Miles of _____

Well / Borehole Data

Date drilling started: 10-22-12 Date drilling completed: 10-22-12 Hole depth: 115' Hole diameter: 8"

Location of the source of any surface water used for drilling: _____
 Method of dosing and volume of Chlorine used in drilling and development: _____

Logs run (circle all applicable): No log run Electric Gamma Ray Density Sonic Neutron Other: _____
 Name of organization running log(s): _____

Purpose of borehole (check one): Water Well Geotechnical/Geological Investigation Ground Source Heat Pump _____
 Seismic Survey Other (describe) _____

If drilling is not related to water well construction, skip the remainder of this block

Purpose of Well (check one): Home Industrial Public Supply Irrigation Fish Culture Other: _____

If a flowing well, method of flow regulation: Valve _____ Other (describe) _____

Static Water Level: 53' feet above or below (circle one) land surface Date measured: 10-22-12

Method of Measurement (circle one) steel tape electric tape air line other: _____

Well depth: 115' Well grouted to a depth of 10' feet Type of grout (circle one): Neat Cement Bentonite Mix

Casing length: 105' feet Casing diameter: 4" inches Type of casing: Pvc

Screen length: 10' feet Screen diameter: 4" inches Type of screen: Pvc

Screen slot size: .012 inches Setting depth: From 105' feet to 115' feet

Type of completion (circle all applicable): Gravel packed Underreamed Telescoped Open hole Natural Development
 Other (describe): _____

Top of lap pipe or reduction in casing: _____ feet. *If telescoped or more than one screen, describe on next page*

Pump set by The Warehouse

The sketch below only required for water wells

If well telescopes, show depths on sketch.

Ground Level →

Description of formations encountered must be provided for all wells and boreholes, unless specifically exempted by regulations

Description of Formations Encountered	From (depth)	To (depth)
	Ground Level	
Clay	0	20
Sand	20	40
gravel	40	60
Clay	60	80
Sand	80	90
Sand	90	100
Coarse Sand	100	115

If more than one screen, show location of each on sketch

Sketch the property layout and include the following: 1) the well location; 2) any permanent structures on the property that may aid in locating the well; 3) any roads, power lines, or other items that may aid in locating the property and the well; 4) a north arrow.

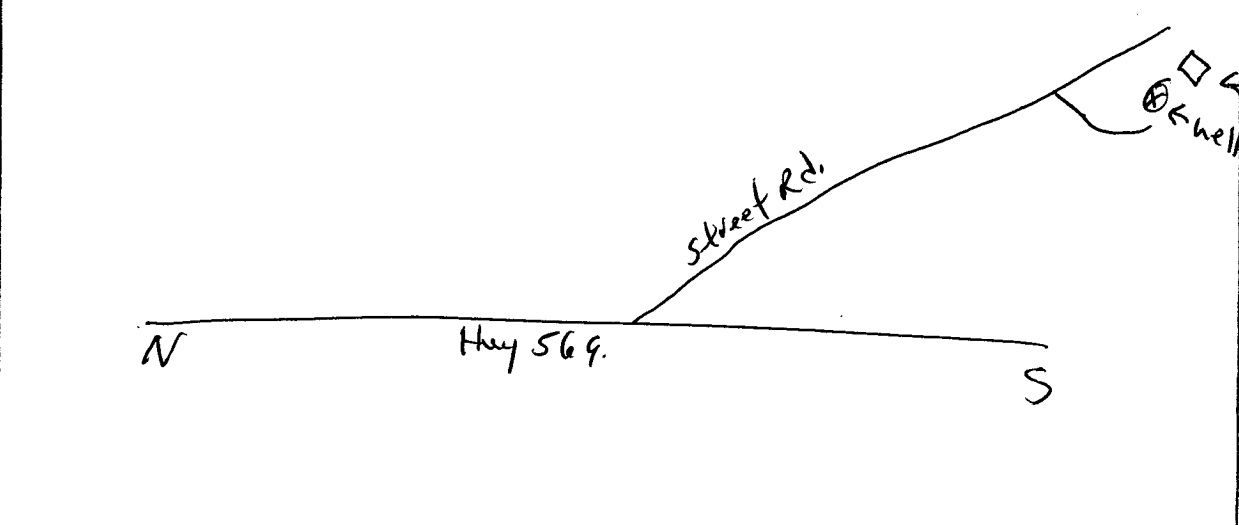

Landowner Name: James Dixon

Form: OLWR-SWR-1A (04/08)

I certify that the well/borehole was drilled, constructed, and completed in accordance with all applicable requirements of the Mississippi Department of Environmental Quality and the Mississippi Department of Health regulations, if applicable, and state laws.

Brad Fitzgerald 029 10-22-12

Beal _____

Print Name of Responsible Licensee and License No.

Date

Signature of Licensee

NOV 1 2012

BY: OLWR

STATE WELL REPORT

Part 2

Pump Installer's Completion Report
 Mississippi Department of Environmental Quality
 Office of Land and Water Resources
 P.O. Box 10631
 Jackson, MS 39289-0631
 (601)961-5210
 (601)354-6938 (fax)

County: Amite
 Permit #: _____
 Driller: Enterprise Well
 Date completed: 10-22-12

For Office Use Only:

Aquifer: R85
 Well #: _____
 Elevation: _____

This report should be prepared by the pump installer in detail and filed with the Department within 30 days of the installation of pump.

Well Owner Information	Well Location
Owner Name: <u>James Dixon</u> Mailing Address: <u>St. Rd</u> <u>Lebates</u> <u>Miss.</u> City State Zip Code Telephone No. () _____	Latitude: <u>31° 3' 43" N</u> Longitude: <u>90° 52' 02" W</u> Method of Lat/Long (circle one): Conventional Survey. USGS quad, Hand-held GPS. Survey-grade GPS <u>NW SW</u> Sec <u>18</u> Twn <u>1N</u> Rng <u>3E</u> Distance Direction Nearest Town _____ Miles _____ of _____

Pump Type Circle one	Power Type Circle one
Air Lift Jet <input type="radio"/> <u>Submersible</u> Bucket Piston <input type="radio"/> Turbine <input type="radio"/> Centrifugal Rotary <input type="radio"/> Flowing Well <input type="radio"/> Other (specify): _____ Date Pump Installed: _____ Rated Pump Capacity: _____ Gallons Per Minute	Diesel Engine Gasoline Engine Natural Gas <u>Electric Motor</u> Hand Tractor PTO Windmill Other (specify): _____ Horse Power Rating of Motor: _____ Setting Depth: _____ feet Number of Stages: _____

Pump Test Data	Method of Measuring Water Level Circle one
Date Well Tested: <u>11-7-12</u> Static Water Level (A): <u>53'</u> Feet Below Land Surface Pumping Water Level (B): <u>100'</u> Feet Below Land Surface Drawdown [(B) - (A)]: <u>47'</u> Feet Below Land Surface Test Pumping Rate: <u>10</u> Gallons Per Minute Duration of Pump Test (minimum 4 hours): _____ hours	Air Line Electric Measuring Line <u>Steel Tape</u> Other (specify): _____ For flowing well, measured shut in head: _____ feet Well yielded _____ GPM with a drawdown of _____ feet after _____ hours of pumping

I HEREBY CERTIFY that the above statements are true to the best of my knowledge.

0305
 Print Name of Pump Installer and License No. (if applicable)

Amie Parker
 Signature of Pump Installer

RECEIVED
 NOV 15 2012
BY: OLWR