

County: Amite  
 Permit #: \_\_\_\_\_  
 Driller: Fitzgerald Well Serv.  
 Date drilling completed: 10-10-12

### State Well Report Part 1 - Driller's Log

Mississippi Department of Environmental Quality  
 Office of Land and Water Resources  
 P.O. Box 2309  
 Jackson, MS 39225  
 (601)961- 5210  
 (601)961- 5228 (fax)

**For Office Use Only:**  
 Aquifer: \_\_\_\_\_  
 Well #: 0103  
 L. S. Elevation: \_\_\_\_\_  
 E-log #: \_\_\_\_\_

*State Law requires that this report be prepared by the license holder responsible for the work and filed with the Department at the above address within 30 days of completion of drilling of the well or borehole.*

<p><b>Information on Well Owner</b> (Landowner if borehole is not for a water well)</p> <p>Owner Name: <u>Charles White</u>          Mailing Address: <u>Bates School Rd.</u>  <u>Liberty</u> <u>MS.</u>          City State Zip Code          Telephone No. ( ) _____</p>	<p><b>Well or Borehole Location</b></p> <p>Latitude: <u>31° 5' 41.5"</u> Longitude: <u>90° 41' 46.4"</u>          Method of Lat/Long (circle one): Conventional Survey,          USGS quad, Hand-held GPS, Survey-grade GPS  <u>SE</u> <math>\frac{1}{4}</math> <u>NW</u> <math>\frac{1}{4}</math> Sec <u>34</u> Twn <u>2N</u> Rng <u>5E</u>          Distance Direction Nearest Town          _____ Miles _____ of _____</p>
--	---

**Well / Borehole Data**

Date drilling started: 10-10-12, Date drilling completed: 10-10-12 Hole depth: 118' Hole diameter: 8"

Location of the source of any surface water used for drilling: \_\_\_\_\_  
 Method of dosing and volume of Chlorine used in drilling and development: \_\_\_\_\_

Logs run (circle all applicable): No log run Electric Gamma Ray Density Sonic Neutron Other: \_\_\_\_\_  
 Name of organization running log(s): \_\_\_\_\_

Purpose of borehole (check one): Water Well  Geotechnical/Geological Investigation \_\_\_\_\_ Ground Source Heat Pump \_\_\_\_\_  
 Seismic Survey \_\_\_\_\_ Other (describe) \_\_\_\_\_

*If drilling is not related to water well construction, skip the remainder of this block*

Purpose of Well (check one): Home  Industrial \_\_\_\_\_ Public Supply \_\_\_\_\_ Irrigation \_\_\_\_\_ Fish Culture \_\_\_\_\_ Other: \_\_\_\_\_

If a flowing well, method of flow regulation: Valve \_\_\_\_\_ Other (describe) \_\_\_\_\_

Static Water Level: 74' feet above or below (circle one) land surface Date measured: 10-10-12

Method of Measurement (circle one) steel tape electric tape air line other: \_\_\_\_\_

Well depth: 118' Well grouted to a depth of 10' feet Type of grout (circle one): Neat Cement Bentonite Mix

Casing length: 108' feet Casing diameter: 4" inches Type of casing: Pvc

Screen length: 10' feet Screen diameter: 4" inches Type of screen: Pvc

Screen slot size: .012 inches Setting depth: From 108' feet to 118' feet

Type of completion (circle all applicable): Gravel packed Underreamed Telescoped Open hole Natural Development  
 Other (describe): \_\_\_\_\_

Top of lap pipe or reduction in casing: \_\_\_\_\_ feet. *If telescoped or more than one screen, describe on next page*

Form: OLWR-SWR-1A (04/08)

RECEIVED  
NOV 14 2012

BY: OLWR

The sketch below only required for water wells

If well telescopes, show depths on sketch.

Ground Level →

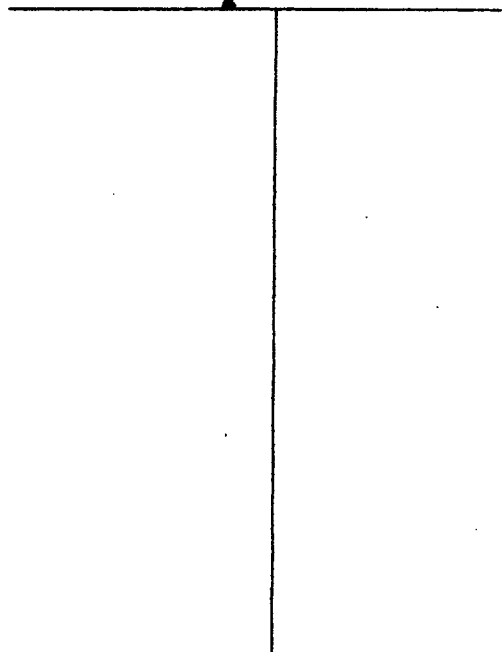

Description of formations encountered must be provided for all wells and boreholes, unless specifically exempted by regulations

Description of Formations Encountered	From (depth)	To (depth)
	Ground Level	
Clay	0	20
Clay	20	40
Gravel	40	80
Clay	80	90
Sand	90	100
Coarse Sand	100	110

If more than one screen, show location of each on sketch

Sketch the property layout and include the following: 1) the well location; 2) any permanent structures on the property that may aid in locating the well; 3) any roads, power lines, or other items that may aid in locating the property and the well; 4) a north arrow.

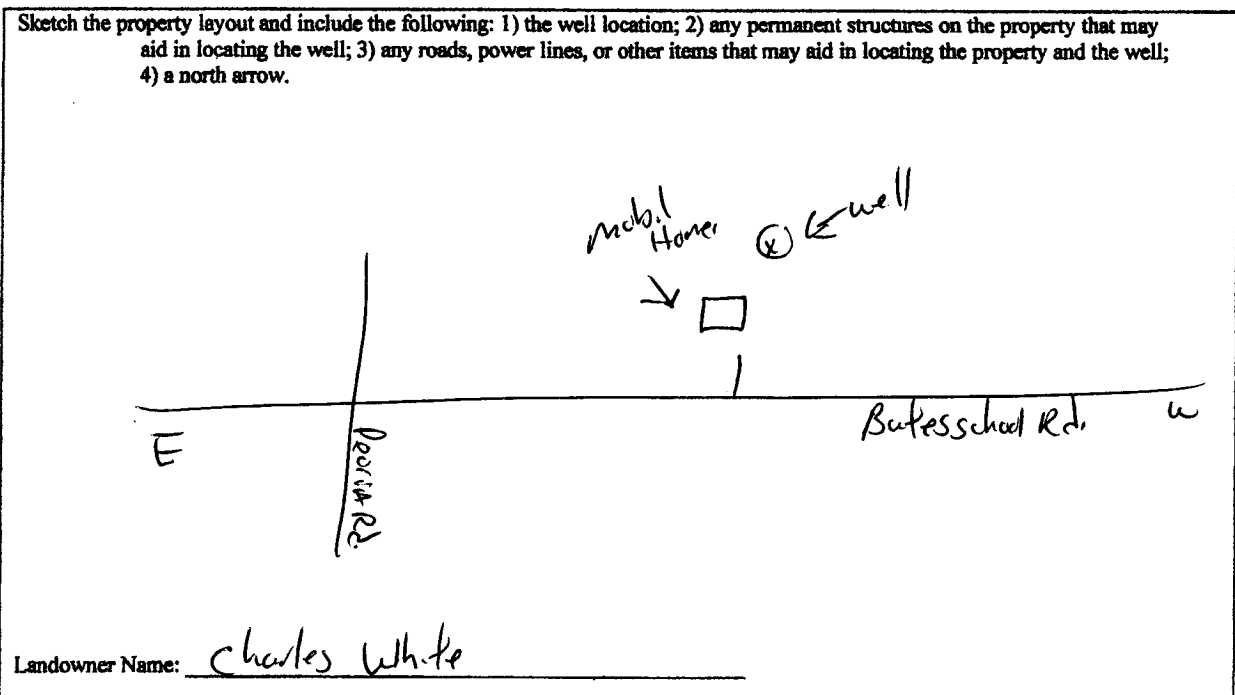

Landowner Name: Charles White

Form: OLWR-SWR-1A (04/08)

I certify that the well/borehole was drilled, constructed, and completed in accordance with all applicable requirements of the Mississippi Department of Environmental Quality and the Mississippi Department of Health regulations, if applicable, and state laws.

Brod Fitzgerald 029  
Print Name of Responsible Licensee and License No.

10-10-12  
Date

[Signature]  
Signature of Licensee

RECEIVED  
NOV 11 2012  
BY: OLWR

# STATE WELL REPORT

## Part 2

**Pump Installer's Completion Report**  
 Mississippi Department of Environmental Quality  
 Office of Land and Water Resources  
 P.O. Box 2309  
 Jackson, MS 39225  
 (601)961-5210  
 (601)961-5228 (fax)

For Office Use Only:

Aquifer:           
 Well #: 0103  
 Elevation:         

County: Amite  
 Permit #:           
 Driller: Eitzgerald Well Corp  
 Date completed: 10-10-12  
*Copy information from block on Part 1*

*This part of the report must be completed by a licensed water well contractor or a licensed pump installer. A copy of Part 1 of the report must be attached and both parts filed with the Department at the above address within 30 days of well completion.*

Well Owner Information	Well Location
Owner Name: <u>Charles White</u>	Latitude: <u>31° 5' 46.5"</u> Longitude: <u>90° 41' 46.4"</u>
Mailing Address: <u>Baker School Rd.</u>	Method of Lat/Long (check one): Conventional Survey <u>        </u>
<u>Liberty</u> MS	USGS quad <u>        </u> , Hand-held GPS <u>        </u> , Survey-grade GPS <u>        </u>
City State Zip Code	<u>SE 1/4 NW 1/4 Sec 35 T 2N R 5E</u>
Telephone No. ( ) <u>        </u>	Distance <u>        </u> Miles Direction <u>        </u> of Nearest Town <u>        </u>

Pump Type	Power Type
Circle one	Circle one
Air Lift <input type="checkbox"/> Jet <input type="checkbox"/> <u>Submersible</u>	Diesel Engine <input type="checkbox"/> Gasoline Engine <input type="checkbox"/> Natural Gas <input type="checkbox"/>
Bucket <input type="checkbox"/> Piston <input type="checkbox"/> Turbine <input type="checkbox"/>	<u>Electric Motor</u> <input type="checkbox"/> Hand <input type="checkbox"/> Tractor PTO <input type="checkbox"/>
Centrifugal <input type="checkbox"/> Rotary <input type="checkbox"/> Flowing Well <input type="checkbox"/>	Windmill <input type="checkbox"/> Other (specify): <u>        </u>
Other (specify): <u>        </u>	Horse Power Rating of Motor: <u>1/2</u>
Date Pump Installed: <u>10-10-12</u>	Setting Depth: <u>100'</u> feet
Rated Pump Capacity: <u>12</u> Gallons Per Minute	Number of Stages: <u>8</u>

Pump Test Data	Method of Measuring Water Level
Date Well Tested: <u>        </u>	Circle one
Static Water Level (A): <u>        </u> Feet Below Land Surface	Air Line <input type="checkbox"/> Electric Measuring Line <input type="checkbox"/> <u>Steel Tape</u>
Pumping Water Level (B): <u>        </u> Feet Below Land Surface	Other (specify): <u>        </u>
Drawdown [(B) - (A)]: <u>        </u> Feet Below Land Surface	For flowing well, measured shut in head: <u>        </u> feet
Test Pumping Rate: <u>        </u> Gallons Per Minute	Well yielded <u>        </u> GPM with a drawdown of
Duration of Pump Test (minimum 4 hours): <u>        </u> hours	<u>        </u> feet after <u>        </u> hours of pumping

This is for (circle one): New Well Replacement of Existing Pump Repair of Existing Pump

I HEREBY CERTIFY that the above statements are true to the best of my knowledge.

Brad Fitzgerald 029 Brad Fitzgerald  
 Print Name of Pump Installer and License No. (if applicable) Signature of Pump Installer

Form: OLWR-SWR-1C (07-09)

RECEIVED  
 NOV 1 2012  
 BY: OLWR