

County: Amite
 Permit #: _____
 Driller: James M. Wells
 Date drilling completed: 11-3-16

STATE WELL REPORT

Part 1

Driller's Log

Mississippi Department of Environmental Quality
 Office of Land and Water Resources
 P.O. Box 2309
 Jackson, MS 39225-2309
 (601)961-5210
 (601)360-0535 (fax)

For Office Use Only:

Well #: J87
 Aquifer: _____
 E-Log #: _____

State Law requires that this report be prepared by the license holder responsible for the work and filed with the Department at the above address within 30 days of completion of drilling of the well or borehole.

<p>③ Well Owner Information (Landowner if borehole is not for a water well) Owner Name: <u>Andy NGC</u> Mailing Address: _____ <u>5289 Hwy 569 N</u> <u>Liberty MS 39645</u> City State Zip Code Telephone No. (____) _____</p>	<p>Well or Borehole Location Latitude: <u>31° 14.10</u> Longitude: <u>90° 43.28</u> <u>31-14-10</u> <u>90-43-28</u> Method of Lat/Long (check one): Conventional Survey _____ USGS quad _____, Hand-held GPS _____, Survey-grade GPS _____ <u>NW ¼ SE ¼, Sec 8 T.3N R.5E</u> _____ Miles _____ of _____ (Distance) (Direction) (Nearest Town)</p>
--	--

Well / Borehole Data

Date drilling started: 11-3-16 Date drilling completed: 11-3-16 Hole depth: 170 Hole diameter: 7 1/2"

Location of the source of any surface water used for drilling: running creek

Method of dosing and volume of Chlorine used in drilling and development: granule chlorine

Logs run (circle all applicable): No log run Electric Gamma Ray Density Sonic Neutron Other: _____

Name of organization running log(s): _____

Purpose of borehole (circle one): Water Well Geotechnical/Geological Investigation Ground Source Heat Pump
 Seismic Survey Other (describe) _____

If drilling is not related to water well construction, skip the remainder of this block.

Purpose of Well (circle all applicable): Home Industrial Public Supply Irrigation Fish Culture Other (describe): chicken house

If a flowing well, method of flow regulation: Valve _____ Other (describe) _____

Static Water Level: 80 feet [above or below] land surface Date measured: 11-3-16

Method of measurement (circle one): Steel tape Electric tape Air line Other (describe): _____

Well depth: 170 Well grouted to a depth of: 10 feet Type of grout (circle one): Neat Cement Bentonite Mix

Casing length: 140 feet Casing diameter: 4 inches Type of casing: PVC

Screen length: 30 feet Screen diameter: 4 inches Type of screen: PVC

Screen slot size: .008 inches Setting depth: From 140 feet to 170 feet

Type of completion (circle all applicable): Gravel packed Underreamed Open hole Natural Development

Other (describe): _____

Top of lap pipe or reduction in casing: _____ feet

If telescoped or more than one screen, describe on next page

RECEIVED
 MAY 24 2017
 BY OLWR

County: Amite
Permit #: _____

For Office Use Only:
Well #: J87

The sketch below only required for water wells

If well telescopes, show depths on sketch.

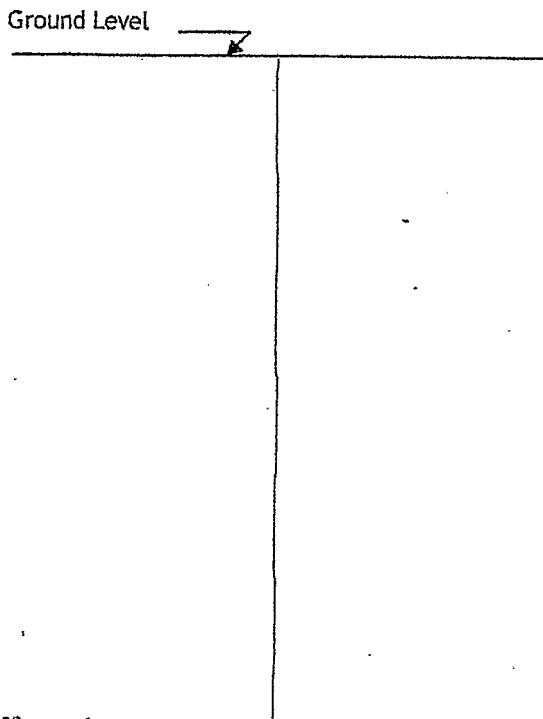

Description of formations encountered must be provided for all wells and boreholes, unless specifically exempted by regulations

Description of Formations Encountered	From (depth)	To (depth)
topsoil	Ground level	1
clay	1	125
sand	125	170

If more than one screen, show location of each on sketch

- Sketch the property layout and include the following:
- 1) the well location
 - 2) any permanent structures on the property that may aid in locating the well
 - 3) any roads, power lines, or other items that may aid in locating the property and the well
 - 4) north arrow

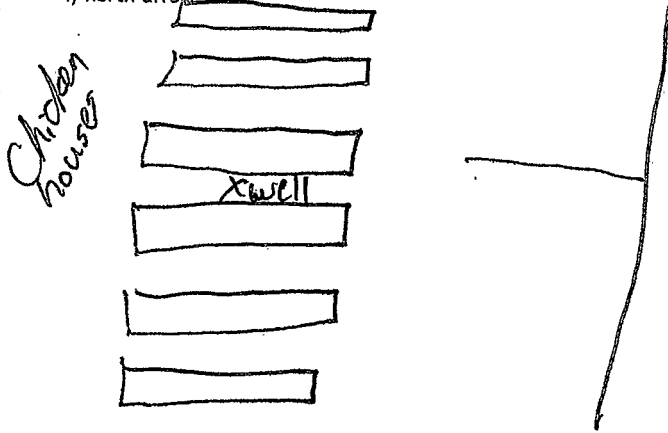

RECEIVED
MAY 24 2017
BY OLWR

Landowner Name: Andy NGC

I HEREBY CERTIFY that the well/borehole was drilled, constructed, and completed in accordance with all applicable requirements of the Mississippi Department of Environmental Quality and the Mississippi Department of Health regulations, if applicable, and state laws.

James M. Wells 00005889
Print Name of Responsible Licensee and License No.

5-22-17
Date

James M. Wells
Signature of Licensee

STATE WELL REPORT

Part 2

Pump Installer's Completion Report
Mississippi Department of Environmental Quality
Office of Land and Water Resources
P.O. Box 2309
Jackson, MS 39225-2309
(601)961-5210
(601) 360-0535 (fax)

County: Amite
Permit #: _____
Driller: James M. Wells
Date completed: 11-3-16
Copy information from block on Part 1

For Office Use Only:
Well #: J87
Aquifer: _____

This part of the report must be completed by a licensed water well contractor or a licensed pump installer. A copy of Part 1 of the report must be attached and both parts filed with the Department at the above address within 30 days of well completion.

Well Owner Information		3-14-10 Well Location 90-43-28	
Owner Name: <u>Andy NGC</u>		Latitude: <u>31°14.10</u>	Longitude: <u>90°43.28</u>
Mailing Address: _____		Method of Lat/Long (check one): Conventional Survey _____, USGS quad _____, Hand-held GPS _____, Survey-grade GPS _____	
<u>5289 Hwy 569N</u>		<u>NW ¼ SE ¼, Sec 8 T 3N R 5E</u>	
<u>Liberty</u>	<u>MS</u>	<u>39645</u>	
City	State	Zip Code	
Telephone No. (____) _____		Miles _____ of _____	(Distance) (Direction) (Nearest Town)

Pump Type (circle one)
 Submersible Turbine Air Lift Centrifugal Flowing Well Jet Piston Rotary Other (describe): _____
Date Pump Installed: 11-3-16 Rated Pump Capacity: 85 Gallons Per Minute
Is This Pump (circle one): New Repaired Replacement

Power Type (circle one)
 Electric Diesel Gasoline Natural Gas Tractor PTO Windmill Other (describe): _____
Horse Power Rating of Motor: 7 1/2 Setting Depth: 150 feet Number of Stages: _____

Pump Test Data for Non Flowing Well
Date Well Tested: 11-3-16 Duration of Pump Test (minimum 4 hours): 4 hours
Static Water Level (A): 80 Feet Below Land Surface Pumping Water Level (B): 150 Feet Below Land Surface
Drawdown [(B) - (A)]: 105 Feet Below Land Surface Test Pumping Rate: 100 Gallons Per Minute
Method of measurement (circle one): Steel tape Electric tape Air line Other (describe): _____

Pump Test Data for Flowing Well
Measured shut in head: _____ feet.
Well yielded _____ GPM with a drawdown of _____ feet after _____ hours of pumping

Meter Installation

Meter Manufacturer: _____	Meter Serial Number: _____	RECEIVED
Meter Model Number/Name: _____	Type of Meter: _____	
Totalizer Register Unit and Multiplier Factor (AF x .001, gal x 1000, etc): _____		MAY 24 2017
Installation Date: _____	Meter installed by: _____	BY OLWR

Is This Meter (circle one): New Repaired Replacement

Important: By submitting the above information you are certifying that this meter was installed to manufacturer standards. For agricultural wells, a list of approved meters is on the MDEQ website.

I HEREBY CERTIFY that the above statements are true to the best of my knowledge.

James M. Wells 00005889 5-2217 James M. Wells
Print Name of Pump Installer and License No. (if applicable) Date Signature of Pump Installer