

STATE WELL REPORT

Part 1

Driller's Log

Mississippi Department of Environmental Quality
Office of Land and Water Resources
P.O. Box 2309
Jackson, MS 39225-2309
(601)961-5210
(601)360-0535 (fax)

For Office Use Only:

Well #: F 42

Aquifer: _____

E-Log #: _____

County: Amite
Permit #: _____
Driller: Fitzgerald Well
Date drilling completed: 7/16/14

State Law requires that this report be prepared by the license holder responsible for the work and filed with the Department at the above address within 30 days of completion of drilling of the well or borehole.

Well Owner Information (Landowner if borehole is not for a water well)	Well or Borehole Location
Owner Name: <u>Cleave Boudreaux</u>	Latitude: <u>31° 14' 22.4"</u> Longitude: <u>91° 1' 59.7"</u>
Mailing Address: <u>Stump Rd</u>	Method of Lat/Long (check one): Conventional Survey _____
<u>Gloster</u> <u>MS</u>	USGS quad _____, Hand-held GPS _____, Survey-grade GPS _____
City State Zip Code	<u>S1W 1/4 NE 1/4, Sec 8 T. 3N R. 2E</u>
Telephone No. (____) _____	_____ Miles _____ of _____ (Distance) (Direction) (Nearest Town)

Well / Borehole Data

Date drilling started: 7/16/14 Date drilling completed: 7/16/14 Hole depth: 266 Hole diameter: 8"

Location of the source of any surface water used for drilling: _____

Method of dosing and volume of Chlorine used in drilling and development: _____

Logs run (circle all applicable): No log run Electric Gamma Ray Density Sonic Neutron Other: _____

Name of organization running log(s): _____

Purpose of borehole (circle one): Water Well Geotechnical/Geological Investigation Ground Source Heat Pump

Seismic Survey Other (describe) _____

If drilling is not related to water well construction, skip the remainder of this block

Purpose of Well (circle all applicable): Home Industrial Public Supply Irrigation Fish Culture

Other (describe): _____

If a flowing well, method of flow regulation: Valve _____ Other (describe) _____

Static Water Level: 170 feet [above or below] land surface Date measured: 7/16/14
(circle one)

Method of measurement (circle one): Steel tape Electric tape Air line Other (describe): _____

Well depth: 266 Well grouted to a depth of: 10 feet Type of grout (circle one): Neat Cement Bentonite Mix

Casing length: 250 feet Casing diameter: 4 inches Type of casing: PVC

Screen length: 10 feet Screen diameter: 4 inches Type of screen: PVC

Screen slot size: .010 inches Setting depth: From 250 feet to 266 feet

Type of completion (circle all applicable): Gravel packed Underreamed Open hole Natural Development

Other (describe): _____

Top of lap pipe or reduction in casing: _____ feet

If telescoped or more than one screen, describe on next page

I certify that the well/borehole was drilled, constructed, and completed in accordance with all applicable requirements of the Mississippi Department of Environmental Quality and the Mississippi Department of Health regulations, if applicable, and state laws.

Print Name of Responsible Licensee and License No. David Fitzgerald 029
 Date 7-16-14
 Signature of Licensee [Handwritten Signature]

Form: OI.WR-SWR-1A (04/08)

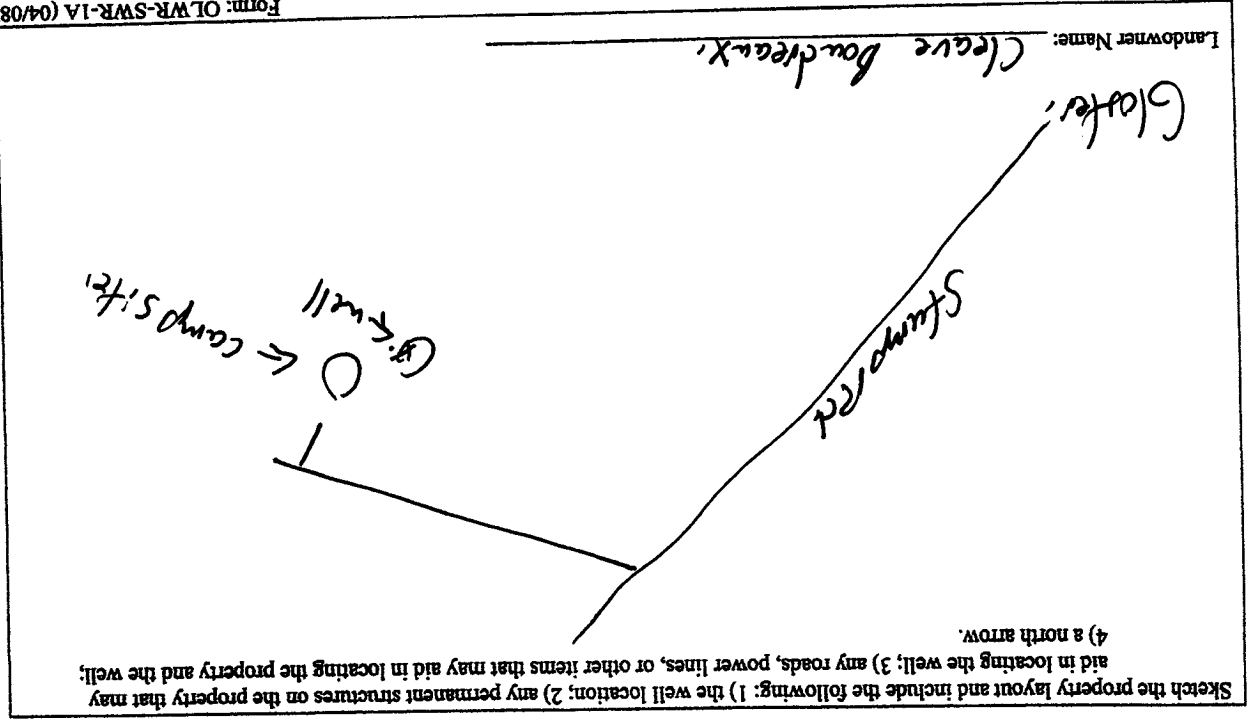

If more than one screen, show location of each on sketch

Description of Formations Encountered	From (depth)	To (depth)
Clay	0	20
Clay	20	50
Clay	50	80
Clay	80	100
Clay	100	220
Clay	220	240
Clay	240	280
Clay	280	320
Clay	320	380
Clay	380	420
Clay	420	460
Clay	460	500
Clay	500	540
Clay	540	580
Clay	580	620
Clay	620	660
Clay	660	700
Clay	700	740
Clay	740	780
Clay	780	820
Clay	820	860
Clay	860	900
Clay	900	940
Clay	940	980
Clay	980	1020
Clay	1020	1060
Clay	1060	1100
Clay	1100	1140
Clay	1140	1180
Clay	1180	1220
Clay	1220	1260
Clay	1260	1300
Clay	1300	1340
Clay	1340	1380
Clay	1380	1420
Clay	1420	1460
Clay	1460	1500
Clay	1500	1540
Clay	1540	1580
Clay	1580	1620
Clay	1620	1660
Clay	1660	1700
Clay	1700	1740
Clay	1740	1780
Clay	1780	1820
Clay	1820	1860
Clay	1860	1900
Clay	1900	1940
Clay	1940	1980
Clay	1980	2020
Clay	2020	2060
Clay	2060	2100
Clay	2100	2140
Clay	2140	2180
Clay	2180	2220
Clay	2220	2260
Clay	2260	2300
Clay	2300	2340
Clay	2340	2380
Clay	2380	2420
Clay	2420	2460
Clay	2460	2500
Clay	2500	2540
Clay	2540	2580
Clay	2580	2620
Clay	2620	2660
Clay	2660	2700
Clay	2700	2740
Clay	2740	2780
Clay	2780	2820
Clay	2820	2860
Clay	2860	2900
Clay	2900	2940
Clay	2940	2980
Clay	2980	3020
Clay	3020	3060
Clay	3060	3100
Clay	3100	3140
Clay	3140	3180
Clay	3180	3220
Clay	3220	3260
Clay	3260	3300
Clay	3300	3340
Clay	3340	3380
Clay	3380	3420
Clay	3420	3460
Clay	3460	3500
Clay	3500	3540
Clay	3540	3580
Clay	3580	3620
Clay	3620	3660
Clay	3660	3700
Clay	3700	3740
Clay	3740	3780
Clay	3780	3820
Clay	3820	3860
Clay	3860	3900
Clay	3900	3940
Clay	3940	3980
Clay	3980	4020
Clay	4020	4060
Clay	4060	4100
Clay	4100	4140
Clay	4140	4180
Clay	4180	4220
Clay	4220	4260
Clay	4260	4300
Clay	4300	4340
Clay	4340	4380
Clay	4380	4420
Clay	4420	4460
Clay	4460	4500
Clay	4500	4540
Clay	4540	4580
Clay	4580	4620
Clay	4620	4660
Clay	4660	4700
Clay	4700	4740
Clay	4740	4780
Clay	4780	4820
Clay	4820	4860
Clay	4860	4900
Clay	4900	4940
Clay	4940	4980
Clay	4980	5020
Clay	5020	5060
Clay	5060	5100
Clay	5100	5140
Clay	5140	5180
Clay	5180	5220
Clay	5220	5260
Clay	5260	5300
Clay	5300	5340
Clay	5340	5380
Clay	5380	5420
Clay	5420	5460
Clay	5460	5500
Clay	5500	5540
Clay	5540	5580
Clay	5580	5620
Clay	5620	5660
Clay	5660	5700
Clay	5700	5740
Clay	5740	5780
Clay	5780	5820
Clay	5820	5860
Clay	5860	5900
Clay	5900	5940
Clay	5940	5980
Clay	5980	6020
Clay	6020	6060
Clay	6060	6100
Clay	6100	6140
Clay	6140	6180
Clay	6180	6220
Clay	6220	6260
Clay	6260	6300
Clay	6300	6340
Clay	6340	6380
Clay	6380	6420
Clay	6420	6460
Clay	6460	6500
Clay	6500	6540
Clay	6540	6580
Clay	6580	6620
Clay	6620	6660
Clay	6660	6700
Clay	6700	6740
Clay	6740	6780
Clay	6780	6820
Clay	6820	6860
Clay	6860	6900
Clay	6900	6940
Clay	6940	6980
Clay	6980	7020
Clay	7020	7060
Clay	7060	7100
Clay	7100	7140
Clay	7140	7180
Clay	7180	7220
Clay	7220	7260
Clay	7260	7300
Clay	7300	7340
Clay	7340	7380
Clay	7380	7420
Clay	7420	7460
Clay	7460	7500
Clay	7500	7540
Clay	7540	7580
Clay	7580	7620
Clay	7620	7660
Clay	7660	7700
Clay	7700	7740
Clay	7740	7780
Clay	7780	7820
Clay	7820	7860
Clay	7860	7900
Clay	7900	7940
Clay	7940	7980
Clay	7980	8020
Clay	8020	8060
Clay	8060	8100
Clay	8100	8140
Clay	8140	8180
Clay	8180	8220
Clay	8220	8260
Clay	8260	8300
Clay	8300	8340
Clay	8340	8380
Clay	8380	8420
Clay	8420	8460
Clay	8460	8500
Clay	8500	8540
Clay	8540	8580
Clay	8580	8620
Clay	8620	8660
Clay	8660	8700
Clay	8700	8740
Clay	8740	8780
Clay	8780	8820
Clay	8820	8860
Clay	8860	8900
Clay	8900	8940
Clay	8940	8980
Clay	8980	9020
Clay	9020	9060
Clay	9060	9100
Clay	9100	9140
Clay	9140	9180
Clay	9180	9220
Clay	9220	9260
Clay	9260	9300
Clay	9300	9340
Clay	9340	9380
Clay	9380	9420
Clay	9420	9460
Clay	9460	9500
Clay	9500	9540
Clay	9540	9580
Clay	9580	9620
Clay	9620	9660
Clay	9660	9700
Clay	9700	9740
Clay	9740	9780
Clay	9780	9820
Clay	9820	9860
Clay	9860	9900
Clay	9900	9940
Clay	9940	9980
Clay	9980	10020

Description of Formations Encountered must be provided for all wells and boreholes, unless specifically exempted by regulations

The sketch below only required for water wells
 If well telescopes, show depths on sketch.
 Ground Level

STATE WELL REPORT

Part 2

Pump Installer's Completion Report
Mississippi Department of Environmental Quality
Office of Land and Water Resources
P.O. Box 2309
Jackson, MS 39225-2309
(601)961-5210
(601) 360-0535 (fax)

For Office Use Only:

Well #: 762
Aquifer: _____

County: Wilkinson Amite
Permit #: _____
Driller: Fitzgerald
Date completed: 7/16/14
Copy information from block on Part 1

This part of the report must be completed by a licensed water well contractor or a licensed pump installer. A copy of Part 1 of the report must be attached and both parts filed with the Department at the above address within 30 days of well completion.

Well Owner Information	Well Location
Owner Name: <u>Cleave Boudreaux</u>	Latitude: <u>31° 14' 22.4"</u> Longitude: <u>91° 1' 59.7"</u>
Mailing Address: <u>Strump Rd</u>	Method of Lat/Long (check one): Conventional Survey _____, USGS quad _____, Hand-held GPS _____, Survey-grade GPS _____
<u>Gloster</u> City <u>MS</u> State Zip Code _____	<u>S 1/4 NE 1/4</u> Sec <u>8</u> T <u>3N</u> R <u>2E</u>
Telephone No. (____) _____	____ Miles of _____ (Distance) (Direction) (Nearest Town)

Pump Type (circle one)
 Submersible Turbine Air Lift Centrifugal Flowing Well Jet Piston Rotary Other (describe): _____
Date Pump Installed: 7/16/14 Rated Pump Capacity: 12 Gallons Per Minute
Is This Pump (circle one): New Repaired Replacement

Power Type (circle one)
 Electric Diesel Gasoline Natural Gas Tractor PTO Windmill Other (describe): _____
Horse Power Rating of Motor: 3/4 Setting Depth: 220 feet Number of Stages: 12

Pump Test Data for Non Flowing Well
Date Well Tested: _____ Duration of Pump Test (minimum 4 hours): _____ hours
Static Water Level (A): _____ Feet Below Land Surface Pumping Water Level (B): _____ Feet Below Land Surface
Drawdown [(B) - (A)]: _____ Feet Below Land Surface Test Pumping Rate: _____ Gallons Per Minute
Method of measurement (circle one): Steel tape Electric tape Air line Other (describe): _____

Pump Test Data for Flowing Well
Measured shut in head: _____ feet.
Well yielded _____ GPM with a drawdown of _____ feet after _____ hours of pumping

Meter Installation
Meter Manufacturer: _____ Meter Serial Number: _____
Meter Model Number/Name: _____ Type of Meter: _____
Totalizer Register Unit and Multiplier Factor (AF x .001, gal x 1000, etc): _____
Installation Date: _____ Meter installed by: _____
Is This Meter (circle one): New Repaired Replacement
Important: By submitting the above information you are certifying that this meter was installed to manufacturer standards. For agricultural wells, a list of approved meters is on the MDEQ website.

I HEREBY CERTIFY that the above statements are true to the best of my knowledge.
Brad Fitzgerald 029 7-16-14 Paul [Signature]
Print Name of Pump Installer and License No. (if applicable) Date Signature of Pump Installer