

# STATE WELL REPORT

## Part I

### Driller's Log

Mississippi Department of Environmental Quality  
Office of Land and Water Resources  
P.O. Box 2309  
Jackson, MS 39225-2309  
(601)961-5210  
(601)360-0535 (fax)

#### For Office Use Only:

Well #: K94  
Aquifer: \_\_\_\_\_  
E-Log #: \_\_\_\_\_

County: Alcorn  
Permit #: MS-GW-17518  
Driller: Donald Smith Company, Inc  
Date drilling completed: 10/14/2021

*State Law requires that this report be prepared by the license holder responsible for the work and filed with the Department at the above address within 30 days of completion of drilling of the well or borehole.*

Well Owner Information <small>(Landowner if borehole is not for a water well)</small>	Well or Borehole Location
Owner Name: <u>Alcorn County Water Association</u>	Latitude: <u>34°50' 38.84 N</u> Longitude: <u>88°33' 36.43 W</u>
Mailing Address: <u>116 South Cass Street</u>	Method of Lat/Long (check one): Conventional Survey _____, USGS quad _____, Hand-held GPS _____, Survey-grade GPS _____
Corinth MS 38834 City State Zip Code	<u>SE</u> ¼ <u>SE</u> ¼, Sec. <u>4</u> T. <u>3S</u> R. <u>7E</u>
Telephone No. (____) _____	<u>5</u> Miles <u>South</u> of <u>Corinth</u> (Distance) (Direction) (Nearest Town)

RECEIVED  
JAN 25 2022  
BY OLWR

Well / Borehole Data
Date drilling started: <u>07/10/2021</u> Date drilling completed: <u>10/14/2021</u> Hole depth: <u>540'</u> Hole diameter: <u>17.5"</u>
Location of the source of any surface water used for drilling: <u>Potable water used</u>
Method of dosing and volume of Chlorine used in drilling and development: <u>Public water supply</u>
Logs run (circle all applicable): No log run <u>Electric</u> <u>Gamma Ray</u> Density Sonic Neutron Other: _____
Name of organization running log(s): <u>Mississippi Office of Geology</u>
Purpose of borehole (circle one): <u>Water Well</u> Geotechnical/Geological Investigation Ground Source Heat Pump Seismic Survey Other (describe) _____
<i>If drilling is not related to water well construction, skip the remainder of this block</i>
Purpose of Well (circle all applicable): Home Industrial <u>Public Supply</u> Irrigation Fish Culture
Other (describe): _____
If a flowing well, method of flow regulation: Valve _____ Other (describe) _____
Static Water Level: <u>152</u> feet [above or below] land surface Date measured: <u>09/23/2021</u> (circle one)
Method of measurement (circle one): Steel tape Electric tape Air line Other (describe): _____
Well depth: <u>540'</u> Well grouted to a depth of: <u>465'</u> feet Type of grout (circle one): Neat Cement Bentonite Mix
Casing length: <u>465</u> feet Casing diameter: <u>12</u> inches Type of casing: <u>Carbon Steel</u>
Screen length: <u>70</u> feet Screen diameter: <u>8</u> inches Type of screen: <u>Stainless-Steel</u>
Screen slot size: <u>.030</u> inches Setting depth: From <u>470</u> feet to <u>540</u> feet
Type of completion (circle all applicable): Gravel packed Underreamed Open hole Natural Development
Other (describe): _____
Top of lap pipe or reduction in casing: <u>415</u> feet
<i>If telescoped or more than one screen, describe on next page</i>

County: Alcorn Co.  
 Permit #: MS-GW-17518

**For Office Use Only:**  
 Well #: 3 Bigger'sville  
1294

The sketch below only required for water wells

If well telescopes, show depths on sketch.

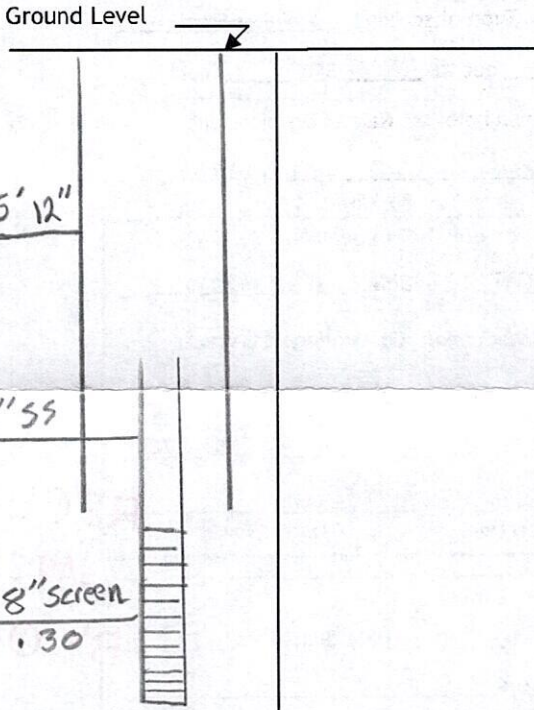

If more than one screen, show location of each on sketch

Description of formations encountered must be provided for all wells and boreholes, unless specifically exempted by regulations

Description of Formations Encountered	From (depth)	To (depth)
Sandy Red clay - Chalk	Ground level	15
Blue clay	15	25
Sandy chalk	25	30
Sandy clay - Blue clay	30	40
Blue clay - Shell	40	60
Grey clay shell	60	90
Rock	90	95
Sand grey	95	174
Sandy grey clay	174	193
Rock	193	199
Sandy Blue clay	199	224
Sandy clay - lignite	224	279
Sandy shell - lignite	279	404
Sand Fine Black	404	449
Sand Fine Black lignite chert	449	471
Sand - Chert	471	489
Chert	489	540
Clay	540	550
Chert	550	580

Sketch the property layout and include the following:

- 1) the well location
- 2) any permanent structures on the property that may aid in locating the well
- 3) any roads, power lines, or other items that may aid in locating the property and the well
- 4) north arrow

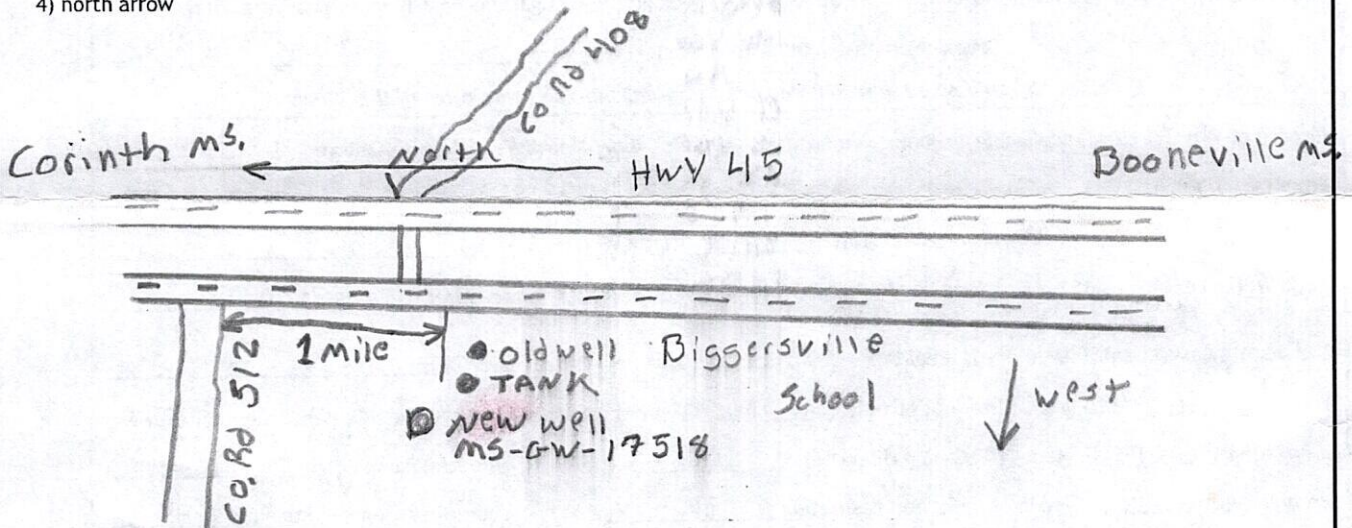

Landowner Name: \_\_\_\_\_

I HEREBY CERTIFY that the well/borehole was drilled, constructed, and completed in accordance with all applicable requirements of the Mississippi Department of Environmental Quality and the Mississippi Department of Health regulations, if applicable, and state laws.

Robert Young UNR-5671

1-20-22

Robert Young, Jr

Print Name of Responsible Licensee and License No.

Date

Signature of Licensee