

**STATE WELL REPORT**

**Part 1**

**Driller's Log**

Mississippi Department of Environmental Quality  
Office of Land and Water Resources  
P.O. Box 2309  
Jackson, MS 39225-2309  
(601)961-5210  
(601)360-0535 (fax)

**For Office Use Only:**

Well #: F0082  
Aquifer: \_\_\_\_\_  
E-Log #: \_\_\_\_\_

County: Alcorn  
Permit #: MS-GW-17346  
Driller: Donald Smith Co., Inc  
Date drilling completed: 7/26/17

*State Law requires that this report be prepared by the license holder responsible for the work and filed with the Department at the above address within 30 days of completion of drilling of the well or borehole.*

Well Owner Information <small>(Landowner if borehole is not for a water well)</small>	Well or Borehole Location
Owner Name: <u>Town of Kossuth</u>	Latitude: <u>34 52 39.4<sup>N</sup></u> Longitude: <u>88 42 34.1<sup>W</sup></u>
Mailing Address: <u>907 Hwy 2</u>	Method of Lat/Long (check one): Conventional Survey _____
<u>Corinth</u> <u>MS</u> <u>38834</u>	USGS quad _____, Hand-held GPS <input checked="" type="checkbox"/> , Survey-grade GPS _____
City State Zip Code	<u>NE</u> $\frac{1}{4}$ <u>SW</u> $\frac{1}{4}$ , Sec <u>30</u> T <u>2S</u> R <u>6E</u>
Telephone No. ( ) _____	<u>3 1/2</u> Miles <u>SW</u> of <u>Kossuth</u>
	(Distance) (Direction) (Nearest Town)

**Well / Borehole Data**

Date drilling started: 5/16/17 Date drilling completed: 7/26/17 Hole depth: 807' Hole diameter: 17 3/4"

Location of the source of any surface water used for drilling: Public Water Supply

Method of dosing and volume of Chlorine used in drilling and development: Potable Water used

Logs run (circle all applicable): No log run  Electric  Gamma Ray  Density  Sonic  Neutron  Other: \_\_\_\_\_

Name of organization running log(s): MS Office of Geology

Purpose of borehole (circle one):  Water Well  Geotechnical/Geological Investigation  Ground Source Heat Pump

Seismic Survey  Other (describe) \_\_\_\_\_

*If drilling is not related to water well construction, skip the remainder of this block*

Purpose of Well (circle all applicable): Home  Industrial   Public Supply  Irrigation  Fish Culture

Other (describe): \_\_\_\_\_

If a flowing well, method of flow regulation: Valve \_\_\_\_\_ Other (describe) \_\_\_\_\_

Static Water Level: 340.58 feet [above or  below] land surface Date measured: 7/17/17  
(circle one)

Method of measurement (circle one): Steel tape  Electric tape  Air line  Other (describe): \_\_\_\_\_

Well depth: 750' Well grouted to a depth of: 595' feet Type of grout (circle one):  Neat Cement  Bentonite  Mix

Casing length: 595' feet Casing diameter: 12 inches Type of casing: Carbon Steel

Screen length: 120' feet Screen diameter: 8" inches Type of screen: SS Ribbed

Screen slot size: .20 inches Setting depth: From 600' feet to 715' feet  
640' 725' 750'

Type of completion (circle all applicable):  Gravel packed  Underreamed  Open hole  Natural Development

Other (describe): \_\_\_\_\_

Top of lap pipe or reduction in casing: 540 feet

*If telescoped or more than one screen, describe on next page*

RECEIVED  
SEP 14 2017  
BY OLWR

County: Alcorn  
 Permit #: MS-GW-17346

For Office Use Only:  
 Well #: F0082

*The sketch below only required for water wells  
 If well telescopes, show depths on sketch.*

*Description of formations encountered must be provided for all wells  
 and boreholes, unless specifically exempted by regulations*

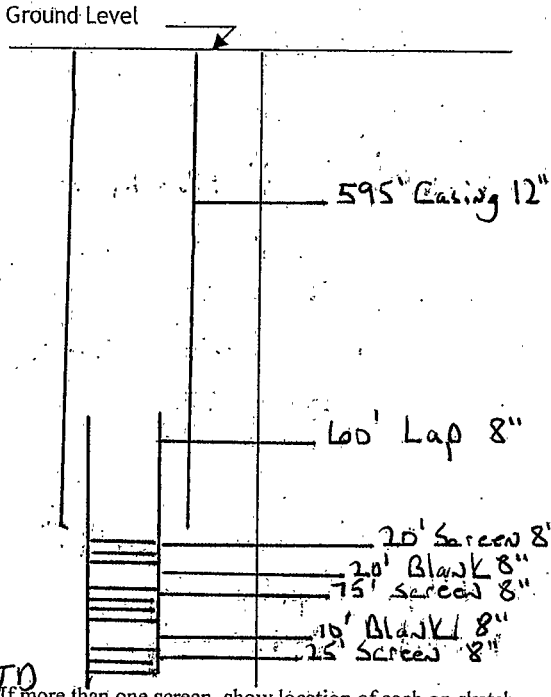

Description of Formations Encountered	From (depth) To (depth)	
	Ground-level	
Sandy Red Clay w/ white Clay Strks	0	105
White Chalky Clay	105	145
Dark gray Clay w/ sand Strks	145	176
Rock	176	178
Sand	178	235
Sand w/ Gray Clay Strks	235	280
Gray Clay w/ gravel Strks	280	543
Rock	543	544
Sand w/ Clay Strks, chert & lignite	544	661
Gray Clay	661	682
Sand w/ few Clay Strks Chert & Lignite	682	782
Gray Clay	782	801

750' TO  
 If more than one screen, show location of each on sketch

Sketch the property layout and include the following:  
 1) the well location  
 2) any permanent structures on the property that may aid in locating the well  
 3) any roads, power lines, or other items that may aid in locating the property and the well  
 4) north arrow

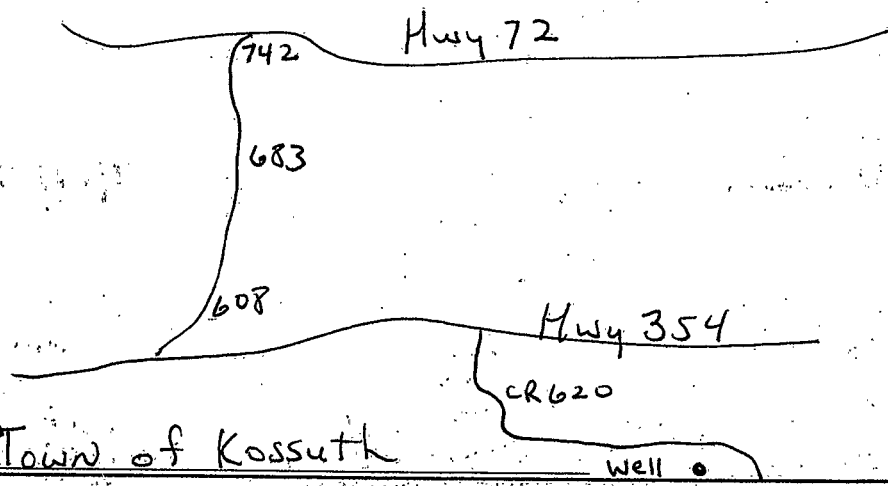

Landowner Name: Town of Kossuth Well

I HEREBY CERTIFY that the well/borehole was drilled, constructed, and completed in accordance with all applicable requirements of the Mississippi Department of Environmental Quality and the Mississippi Department of Health regulations, if applicable, and state laws.

Robert Young Jr. 9/7/17 Robert Young Jr.  
 Print Name of Responsible Licensee and License No. Date Signature of Licensee