

State Well Report

Part 1

Mississippi Department of Environmental Quality
Office of Land and Water Resources
P.O. Box 10631
Jackson, MS 39289-0631
(601)961-5210
(601)354-6938 (fax)

For Office Use Only:

Aquifer: _____
Well #: K-37
L. S. Elevation: _____
E-log #: _____

County: Adams
Permit #: _____
Driller: Gary Rayborn
Date drilling completed: 8/10/08

State Law requires that this report be prepared by the driller in detail and filed with the Department within 30 days of completion of drilling of the well.

Well Owner Information	Well Location
Owner Name: <u>Jim Price</u>	Latitude: _____° _____' _____" Longitude: _____° _____' _____"
Mailing Address: <u>1510 LaSalle Pare</u>	Method of Lat/Long (circle one): Conventional Survey, USGS quad, Hand-held GPS, Survey-grade GPS
<u>Baton Rouge LA 70806</u> City State Zip Code	_____ 1/4 _____ 1/4 Sec <u>2</u> Twn <u>5N</u> Rng <u>2W</u>
Telephone No. <u>(225) 229-6257</u>	Distance _____ Miles _____ Direction <u>W/SW</u> of _____ Nearest Town <u>Natchez</u>

Well Data

Purpose of Well (circle one) Home Industrial Public Supply Irrigation Fish Culture Other: _____

Date well drilling started: 8/9/08 Date well drilling completed: 8/10/2008

If flowing, method of flow regulation: Valve _____ Other (describe) _____

Static Water Level: 95 feet above or below (circle one) land surface Date measured: 8/10/08

Method of Measurement (circle one) steel tape electric tape air line other: _____

Hole depth: 200' Well depth: 200' Well grouted to a depth of 10 feet

Type of grout (circle one): Cement Bentonite Mix

Casing length: 170 feet Casing diameter: 4 inches Type of casing: PVC

Screen length: 30 feet Screen diameter: 4 inches Type of screen: PVC

Screen slot size: .020 inches Setting depth: From 170 feet to 200 feet

Type of completion (circle all applicable): Gravel packed Underreamed Telescoped Open hole Natural Development

Other (describe): _____

Top of lap pipe or reduction in casing: _____ feet. If telescoped or more than one screen, describe on back of page

Logs run (circle all applicable): No log run Electric Gamma Ray Density Sonic Neutron Other: _____

Name of organization running log(s): _____

I certify that the well was drilled, constructed, and completed in accordance with all applicable requirements of the Mississippi Department of Environmental Quality and/or the Mississippi Department of Health regulations and state laws.

RAYBORN DRILLING, INC.

0-60

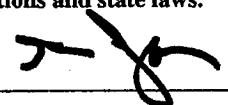

Print Name of Water Well Contractor and License No.

Signature of Water Well Contractor

RECEIVED

AUG 20 2008

BY: OLWR

Faint, illegible text at the top of the page, possibly a header or introductory paragraph.

Second block of faint, illegible text in the middle of the page.

Third block of faint, illegible text near the bottom of the page.

RAYBORN DRILLING, INC.

STATE WELL REPORT

Part 2

Pump Installer's Completion Report
 Mississippi Department of Environmental Quality
 Office of Land and Water Resources
 P.O. Box 10631
 Jackson, MS 39289-0631
 (601)961-5210
 (601)354-6938 (fax)

County: Adams
 Permit #: _____
 Driller: Gary Rayborn
 Date completed: 8/10/2008

For Office Use Only:

Aquifer: _____
 Well #: K-37
 Elevation: _____

This report should be prepared by the pump installer in detail and filed with the Department within 30 days of the installation of pump.

Well Owner Information	Well Location
Owner Name: <u>Jim Price</u>	Latitude: _____ Longitude: _____
Mailing Address: _____ <u>1510 LaSalle Pare</u> <u>Baton Rouge LA 70806</u> <small>City State Zip Code</small>	Method of Lat/Long (circle one): Conventional Survey, USGS quad, Hand-held GPS, Survey-grade GPS _____ 1/4 _____ 1/4 Sec <u>2</u> Twn <u>5N</u> Rng <u>2W</u>
Telephone No. <u>(225) 229-6257</u>	Distance Direction Nearest Town <u>10</u> Miles <u>W/SW</u> of <u>Natchez</u>

Pump Type Circle one	Power Type Circle one
Air Lift Jet <input checked="" type="radio"/> <u>Submersible</u>	Diesel Engine Gasoline Engine Natural Gas
Bucket Piston Turbine	<input checked="" type="radio"/> <u>Electric Motor</u> Hand Tractor PTO
Centrifugal Rotary Flowing Well	Windmill Other (specify): _____
Other (specify): _____	Horse Power Rating of Motor: <u>5HP</u>
Date Pump Installed: <u>8/11/08</u>	Setting Depth: <u>168</u> feet
Rated Pump Capacity: <u>90</u> Gallons Per Minute	Number of Stages: <u>11</u>

Pump Test Data	Method of Measuring Water Level Circle one
Date Well Tested: <u>8/11/08</u>	Air Line <input checked="" type="radio"/> <u>Electric Measuring Line</u> Steel Tape
Static Water Level (A): _____ Feet Below Land Surface	Other (specify): _____
Pumping Water Level (B): _____ Feet Below Land Surface	For flowing well, measured shut in head: _____ feet
Drawdown [(B) - (A)]: _____ Feet Below Land Surface	Well yielded <u>80</u> GPM with a drawdown of _____ feet after _____ hours of pumping
Test Pumping Rate: <u>80</u> Gallons Per Minute	
Duration of Pump Test (minimum 4 hours): _____ hours	

I HEREBY CERTIFY that the above statements are true to the best of my knowledge.

Gary Rayborn 0-60
 Print Name of Pump Installer and License No. (if applicable) Signature of Pump Installer

RECEIVED
 AUG 20 2008
 BY: OLWR

K-37

If well telescopes please sketch below and show depths.

Ground Level

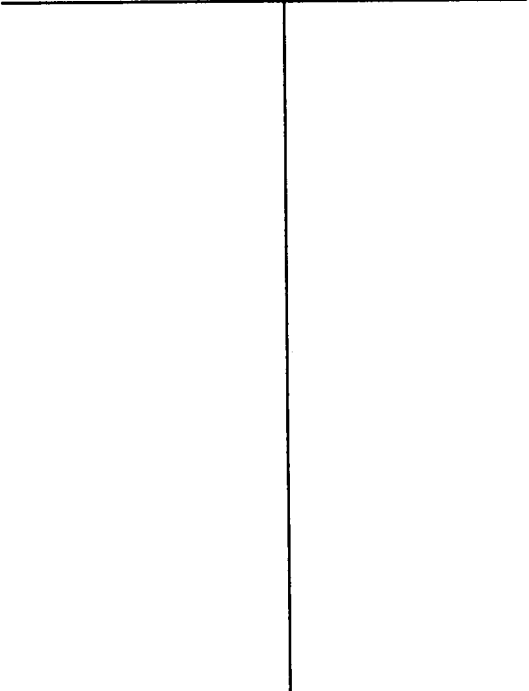

Description of Formations Encountered	From	To
CHALK	0	60
GRAVEL & SAND MIX	60	130
MEDIUM SAND	130	200

If more than one screen, show location of each on sketch

Sketch the property layout and include the following: 1) the well location; 2) any permanent structures on the property that may aid in locating the well; 3) any roads, power lines, or other items that may aid in locating the property and the well; 4) indicate direction.

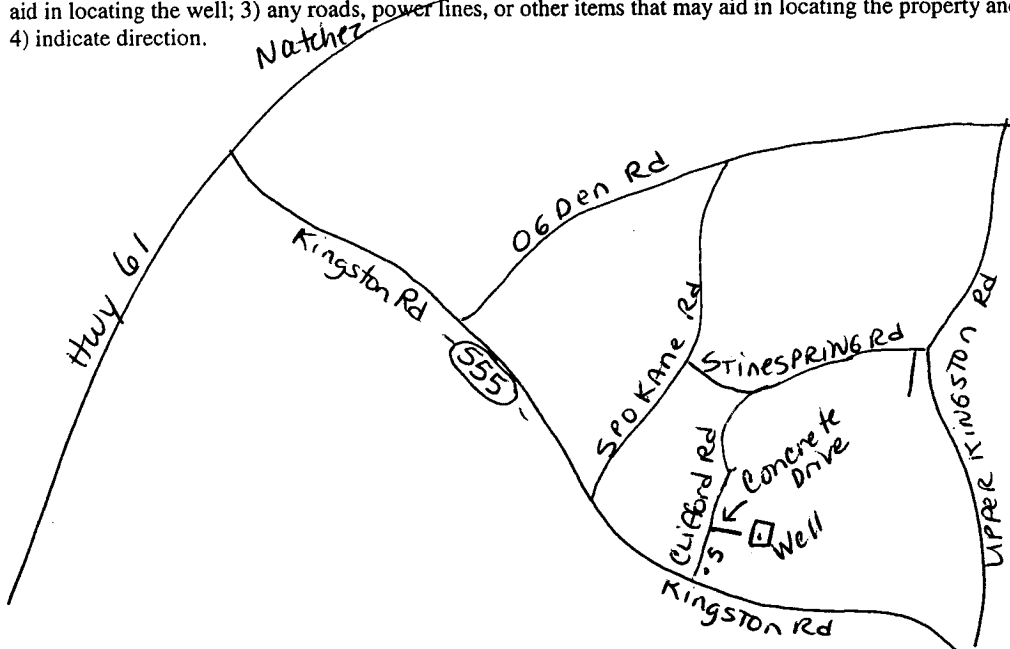

Landowner Name: _____

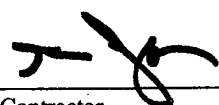

Signature of Water Well Contractor

RECEIVED
AUG 20 2008
BY: OLWR