

GW02094

Adams
D52
7/81

MISSISSIPPI
BOARD OF WATER COMMISSIONERS
416 North State Street
Jackson, Mississippi 39201

CODED ✓

WATER WELL DRILLERS LOG

July-Nov. 1981 Griner Drilling Service Adams
date well completed firm name county well located

LANDOWNER: MISSISSIPPI	description of formations encountered	from	to
POWER & LIGHT	Top Soil	0	3
MATCHES, MISSI	SILT CLAY	3	10
(mailing address)	SAND	10	30
WELL LOCATION: 9 300' <u>400' from</u>	CLAY	30	40
sec. 12-T 7N R 1E	CLAY, silty	40	760
(distance) miles <u>4 1/2</u> (direction) of (nearest town)	CLAY	160	252
WELL PURPOSE: (home, irrigation, municipal, industrial)	SAND, Fine	252	330
WELL COMPLETION DATA:	CLAY	330	398
(1) diameter (inches) <u>12 3/4"</u>	SAND, fine	398	416
(2) total depth (feet)	CLAY	416	442
(3) static water level (feet) <u>118.60</u> below top of ground	SAND, fine	442	470
(4) casing <u>steel</u> <u>372'</u> (material) (depth)	CLAY	470	573
<u>12 3/4"</u> if telescope see back. (size)	SAND + CLAY strata	573	600
(5) screen <u>50'</u> <u>40'</u> (length) (depth to top)	CLAY	600	625
<u>8</u> <u>30' ss. (.016)</u> (size) (material)			
(6) pump <u>AO 500</u> (HP) (yield gpm)			
<u>Elect.</u> (type power)			
(7) electric log <u>Yes</u> (yes or no)			
<u>MGS</u> (organization running log)			
(8) how well bottom plugged <u>BACK</u>			
<u>WASH VALVE</u>			

Note
Screen - 404 - 419
448 - 483

DEPT. OF NATURAL RESOURCES
BUREAU OF LAND & WATER RESOURCES
FEB 8 1982
RECEIVED

DRILLERS REMARKS:

MISSISSIPPI DEPARTMENT OF ENVIRONMENTAL QUALITY
Office of Land and Water Resources
 P. O. Box 2309
 Jackson, MS 39225
Water Well Plugging/Decommissioning Form
 OLWR-DF-1 (04/08)

D52

COUNTY WELL LOCATED: <u>Adams</u>		WELL NUMBER: <u>1-GW02094</u>	
PERMIT NUMBER: <u>MS-GW-02094</u>		DATE WELL PLUGGED: <u>7/9/2019</u>	
NAME OF FIRM PLUGGING WELL: <u>Rayborn Drilling Inc.</u>		TELEPHONE NUMBER: <u>601-445-8930</u>	
NAME AND ADDRESS OF CURRENT LANDOWNER: <u>Mississippi Power & Light Co.</u> <u>PO Box 1640</u> <u>Jackson MS 39215</u>			
WELL LOCATION: SECTION: <u>12</u>		TOWNSHIP: <u>7N</u> RANGE: <u>2W</u>	
WELL LOCATION: LATITUDE: <u>31.6047</u>		LONGITUDE: <u>-91.3430</u> METHOD (CIRCLE ONE): (1) USGS QUAD (2) CONVENTIONAL SURVEY (3) GPS - HAND HELD OR SURVEY GRADE	
DISTANCE: <u>4 m.</u> DIRECTION: <u>NW</u> NEAREST TOWN: <u>Washington</u> OTHER LANDMARK:			
WELL PURPOSE (HOME, IRRIGATION, MUNICIPAL, ETC.): <u>Industrial</u>			
NAME OF WELL CONTRACTOR WHO DRILLED THE WELL: <u>Rayborn Drilling</u>			
NAME OF LANDOWNER WHEN WELL WAS DRILLED: <u>Mississippi Power & Light Co.</u>			

RECEIVED
 JUL 22 2019
 BY OLWR

WELL DATA			
WELL DEPTH: <u>397'</u>		HOLE DEPTH: <u>397'</u>	
CASING DIAMETER (IN.): <u>12</u>	CASING LENGTH (FT.): <u>392</u>	TYPE OF CASING: <u>welded stainless</u>	
DEPTH TO STATIC WATER LEVEL: <u>135'</u>		DATE WELL COMPLETED: <u>7/1/1981</u>	
WHY IS THE WELL BEING ABANDONED? <u>Plant closing</u>			

DESCRIBE HOW THE WELL OR HOLE WAS PLUGGED (AMOUNT OF CASING AND/OR SCREEN THAT WAS REMOVED OR LEFT IN HOLE, MATERIAL AND AMOUNT USED IN PLUGGING, METHOD OF PLACING MATERIAL, ETC.)

Screen and casing were left in hole.
Filled screen with sand. Ran trimmie
pipe to top of sand in screen. Pumped
150 sacks of cement with 8% gel to
surface. Cut casing off below grade.

I CERTIFY THAT THE WELL WAS PLUGGED OR ABANDONED IN ACCORDANCE WITH THE STATE OF MISSISSIPPI REGULATIONS.

<u>Gary Rayborn</u>	<u>60</u>
PRINT NAME	MS LICENSE NUMBER
	<u>7-16-19</u>
SIGNATURE	DATE

RECEIVED

JUL 22 2019

D. OLIVER

31°37'30"

3499000m N.

T 8 N

T 7 N

3498

3497

3496

35'

3495

3494

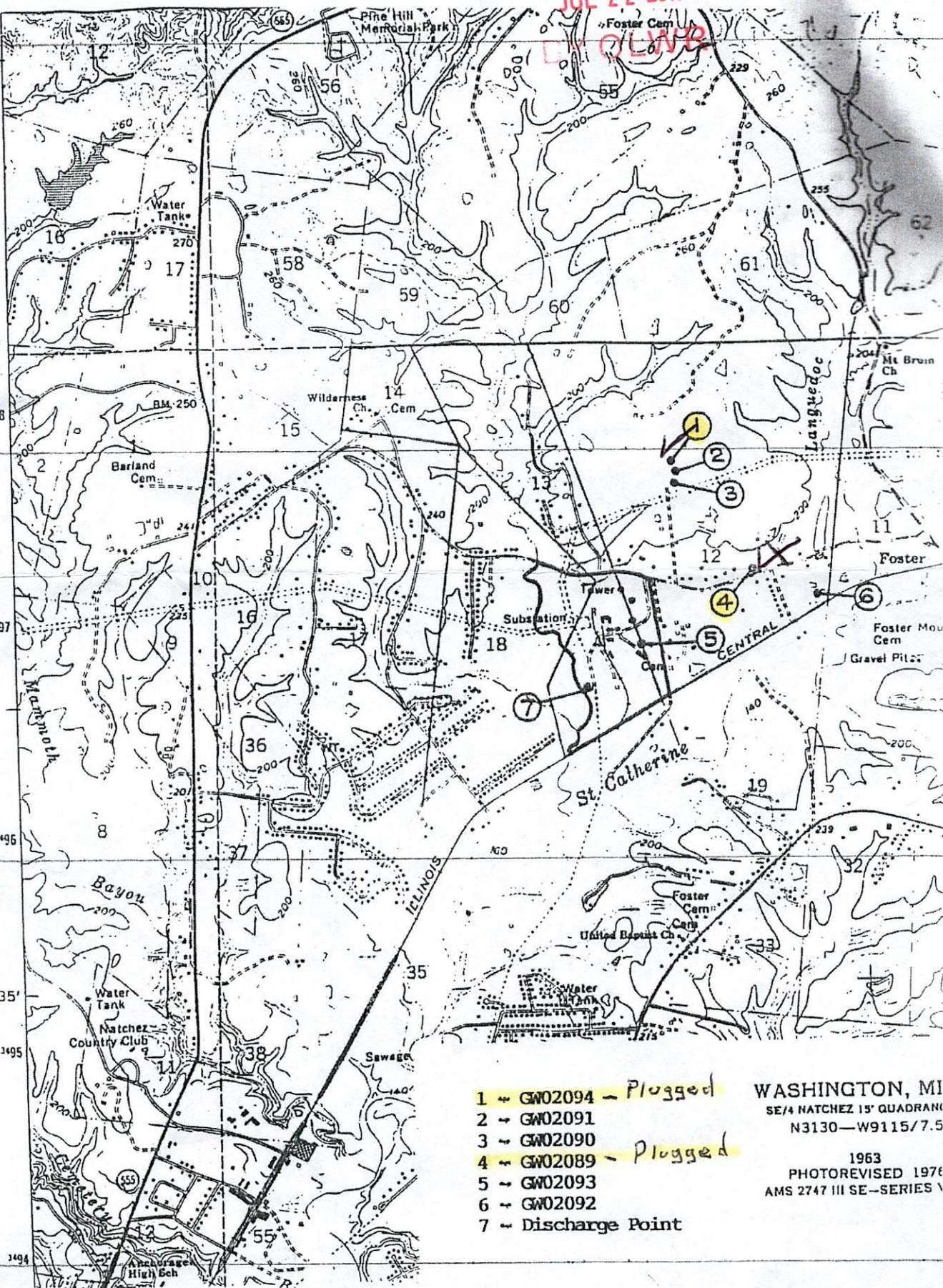

- 1 - GW02094 - Plugged
- 2 - GW02091
- 3 - GW02090
- 4 - GW02089 - Plugged
- 5 - GW02093
- 6 - GW02092
- 7 - Discharge Point

WASHINGTON, MI
 SE/4 NACHEZ 15' QUADRANT
 N3130—W9115/7.5
 1963
 PHOTOREVISED 1976
 AMS 2747 III SE—SERIES A